



SOLD

RETIREMENT LIVING AT ITS VERY BEST - AMAZING OCEAN VIEWS - VICTORIA TOWERS OVER 50'S

CALL JACKIE TAYLOR-FOX TO PRIVATELY INSPECT TODAY 0411 23 68 23

SPECTACULAR OVER 50'S APARTMENT SITTING OVERLOOKING THE FABULOUS GOLD COAST

This spacious 3 Bedroom 2 Bathrooms 2 Carparks Large Balcony with Shutters and has been originally built to be wheelchair friendly has sweeping Broadwater, Ocean and skyline views. Victoria Towers is an over 50's only - Luxury Apartment residential building. Premium position - Northwest corner and HIGH floor position, this beautiful Apartment will suit those over 50's wanting the best of everything in downtown CBD Southport.

These stylish apartments have an abundance of shopping nearby and just a short walk to all Supermarkets, Cinemas, Bowls Club, Tennis, Theatre, Doctors, RSL and the light rail and bus stop is right on the doorstep which makes travelling to the Hospital, Pacific Fair and Helensvale a breeze.

At Victoria Towers you can relax, enjoy the resort style facilities including:

- * On-site Facilities Manager/Concierge Service 25 Meter Lap pool - Heated all year
- * Hot Spa, Sauna and Steam room Room to socialize in the Residents Lounge
- * Library with Cinema Professionally equipped GYM Open-Air Bowling Green BBQ and Dining Terrace
- * On-site Security and Intercom access 5-star aged care facilities with separate entrance

Friends and family will love to visit and enjoy the laid-back Gold Coast Lifestyle. Move into Victoria Towers and enjoy the community friendly activities and live your retirement in the way you deserve.

Please inspect Today. - CALL JACKIE TAYLOR-FOX 0411236823

Disclaimer: Whilst every effort has been made to ensure the accuracy of these particulars, no

3 BED | 2 BATH | 2 CAR

PRICE:
\$1,100,000

OPEN FOR INSPECTION:
N/A



Jackie Taylor-Fox
0411236823

jackietaylorfox@atrealty.com.au
www.atrealty.com.au

FLOORPLAN - TYPE G-NW

LEVELS 33-34

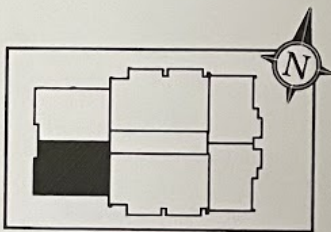

Disclaimer: Please note this floor plan is for marketing purposes and is to be used as a guide only. All dimensions are estimates only and may not be exact measurements.

Internal Area 111m²

Sale by Jack Taylor-Fox 28m²

0411236823
Total 139m²

jack.taylorfox@atrealty.com.au

www.atrealty.com.au

@realty