



SOLD

MODERN FAMILY LIVING IN CENTRAL WERRIBEE

Nestled in the heart of Werribee's coveted Orchard Park Estate, 3 Biddick Ct is a family haven boasting an abundance of bright and wide living spaces. This residence is a perfect blend of modern comfort and spacious design, providing an ideal setting for families seeking a new home.

Step into a bright and open lounge area, setting the tone for the entire home. The massive open-plan kitchen and dining space offer wide, spacious living, perfect for family gatherings and entertaining guests. The master bedroom, complete with a walk-in-robe and full ensuite, ensures a luxurious retreat. Noteworthy features include electric roller shutters, solar panels, ducted heating, and evaporative cooling, adding to the overall comfort and convenience.

The exterior of this brick home is complemented by a double garage and a generous backyard with a sizable grassy area, providing ample space for children's play and outdoor activities. Spanning 618sqm, this property offers a perfect blend of relaxation and recreation for the entire family.

This residence is within the Werribee Secondary School Zone and walking distance to Werribee's finest amenities. Enjoy the convenience of easy access to Werribee Railway Station and exploring Watton Street's vibrant cafe and eatery scene. Additionally, the Werribee River walking trail is just moments away, offering a serene escape for nature enthusiasts.

5 BED | 2 BATH | 2 CAR

PRICE:
\$670,000

OPEN FOR INSPECTION:
N/A



Samuel Hogan
0401315234
samuel@atrealty.com.au
www.atrealty.com.au

Floor Plan

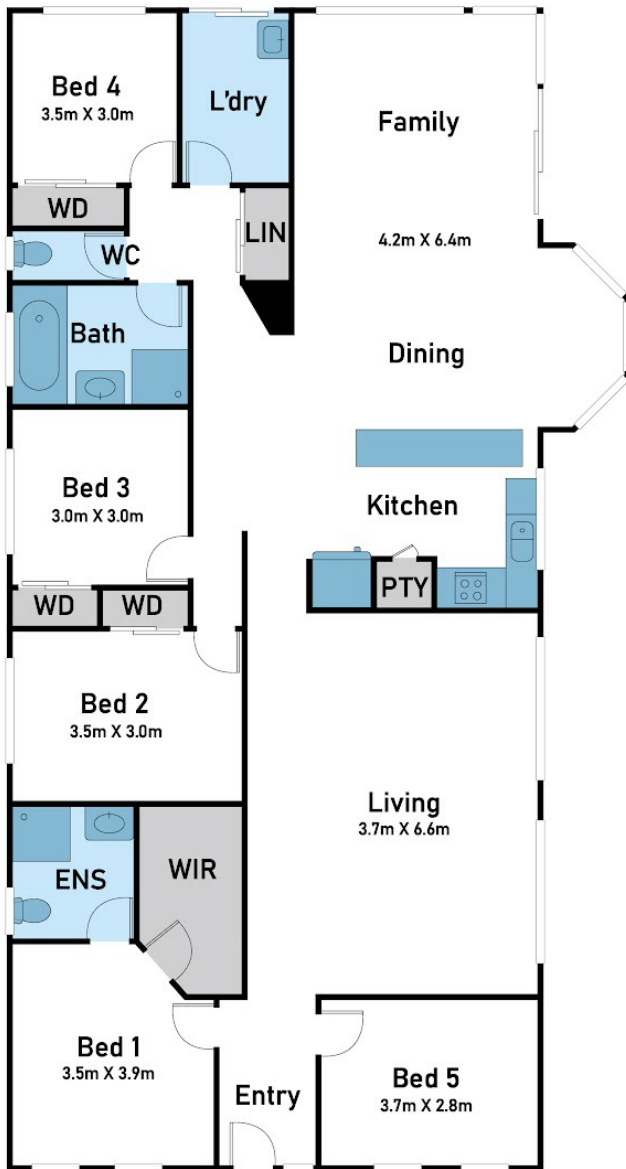

Site Plan

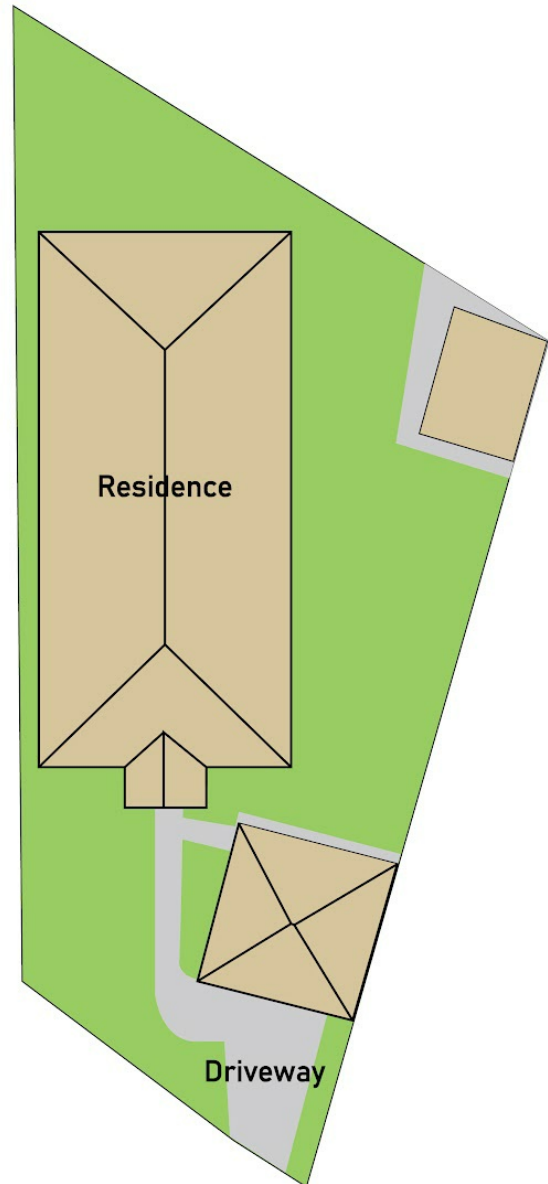

@realty

3 Biddick Court, Werribee

* Dimensions are approximate and for illustrative purposes only

Disclaimer: Please note this floor plan is for marketing purposes and is to be used as a guide only. All dimensions are estimates only and may not be exact measurements.