



SOLD

PERFECT INVESTMENT OPPORTUNITY!

Built in 2008 and set on 600m2, this brilliant property is positioned on a semi-corner block and backs onto nature reserve yet situated only minutes from schools, shops and local parks. Along with its' convenient location, this low maintenance home offers a functional design and spacious floor plan which is sure to impress. If you're looking for the perfect investment property in a sought-after area then look no further.

Boasting modern kitchen, featuring island bench, gas cook-top, dishwasher, ample cabinetry as well as adjoining the light filled open-plan living and dining which provide direct access to the outdoor covered alfresco area as well as seperate media/lounge there is loads of space for families..

Currently tenanted with long term amazing tenants paying \$650 a week until May 2024 with hopes to stay on indefinitely this home is perfect for an investor!

Features include:

- 4 bedrooms (include ceiling fans, security screen windows and built-in wardrobes)
- Master bedroom includes walk-in wardrobe and ensuite
- Well-designed, modern kitchen with island bench, gas cook-top & dishwasher
- Air conditioned Open-plan living and dining
- Bonus 2nd living space featuring air conditioning
- Bath tub in main bathroom
- Separate Toilet
- Spacious Internal Laundry
- Security screen windows and doors
- Covered alfresco area
- Fully fenced yard
- Situated on 600m2 block
- Offering low maintenance living
- Water Tank
- Remote double garage with internal access

A thriving location spoiled with convenience:

- Easy access to Brisbane & Sunshine Coast via Bruce Hwy
- Approximately 56 minute drive to Brisbane CBD

4 BED | 2 BATH | 2 CAR

PRICE:
\$575,000

OPEN FOR INSPECTION:
N/A



Paige Crendon
0413402110
Crendonpropertygroup@gmail.com
www.atrealty.com.au

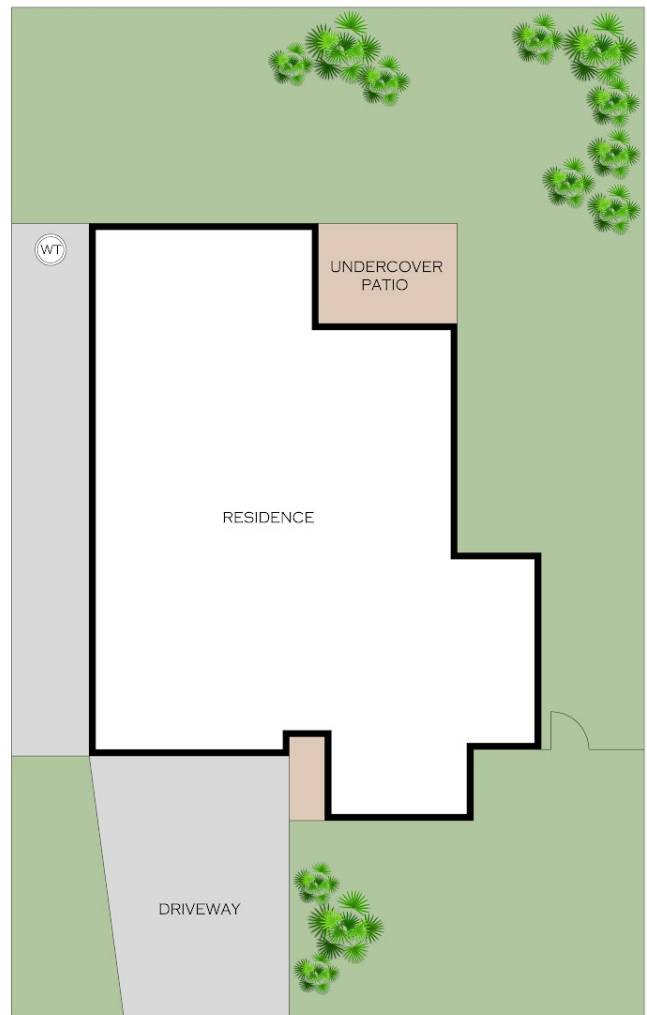

Disclaimer: Please note this floor plan is for marketing purposes and is to be used as a guide only. All dimensions are estimates only and may not be exact measurements.