



# FOR LEASE

## \$1950 INCLUDING POOL & GARDEN MAINTENANCE. LUXURIOUS 5-BEDROOM SORRENTO PRESTIGE PROPERTY

Welcome to Sorrento - a beautiful, vibrant city full of charm and opportunity. At the heart of it all sits this immaculate 5 bedroom, 2 bathroom residence, offering a lifestyle of unrivalled convenience.

The contemporary façade of this residence is complemented by its modern interior, which is defined by a flowing 370-square-meter floor plan. Its expansive open-plan living and dining area provide the perfect space to entertain family and friends in style, while its deluxe kitchen with built-in cabinetry and stone benchtops will inspire your inner chef.

Each of the 5 bedrooms are generously sized, providing the perfect space for your family to grow. The master suite is complete with a walk-in wardrobe and luxurious ensuite, and the other bedrooms come with built-in storage.

The spacious and private 761-square-meter block is ideal for those who love to entertain, with its inviting outdoor area and sparkling in-ground pool. To ensure year-round comfort, the house is fitted with solar panels, air conditioning and is fully fenced for added security. Included Garden and Pool maintenance (excluding any pool chemicals required).

Positioned within close proximity to a range of local amenities, this stunning residence is a perfect option for those seeking a truly convenient way of life. With easy access to shops, restaurants, schools, and public transport, this property offers the best of both worlds - all while being tenanted for \$1950 per week.

If you're after a residence that offers both convenience and style, then look no further than this incredible Sorrento property. Don't miss out on this one-of-a-kind opportunity - contact us today to arrange an inspection.

TO INSPECT OR APPLY:

5 BED | 2 BATH | 4 CAR

PRICE:  
\$1,950 per week

OPEN FOR INSPECTION:  
N/A



**Michael Lo**  
**0413836188**  
michaello@atrealty.com.au  
[www.atrealty.com.au](http://www.atrealty.com.au)

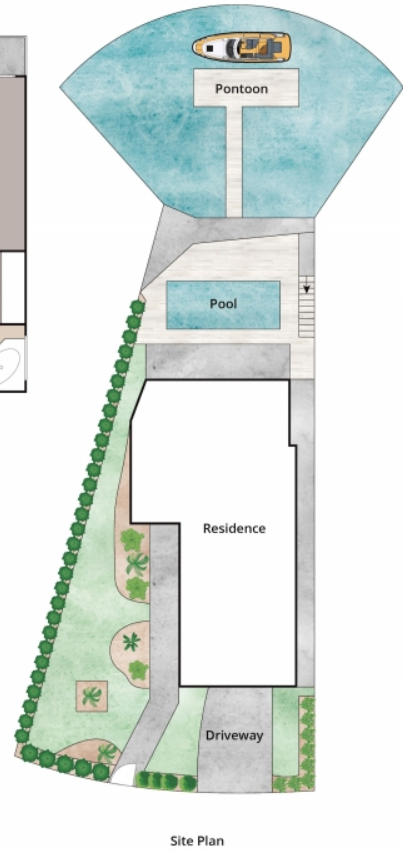

Approx Internal Area 325m<sup>2</sup>  
 Approx Land Area 761m<sup>2</sup>

Whilst Media Abode has made every attempt to ensure the accuracy of the floor plan contained here, measurements are approximate and no responsibility is taken for any error, omission, or mis-statement. This plan is for illustrative purposes only.



## 11 Blair Athol Crescent, Bundall

Disclaimer: Please note this floor plan is for marketing purposes and is to be used as a guide only. All dimensions are estimates only and may not be exact measurements.