



SOLD

FABULOUS FOOTHILLS LOCATION – CREEK SETTING – 2050 SQUARE METRE ALLOTMENT

Vista is a beautiful suburb located in the north eastern foot hills of Adelaide. This wonderful family home is sure to please every member of the family. You will love the location, situated on a fabulous, peaceful and quite 2050 square metre allotment with its own creek, plenty of bird life, established trees and beautiful gardens.

Great entertainment areas inside and outside of the property makes this a home that will create wonderful memories for the new owners.

Inside the home there are 4 generous size bedrooms. The main bedroom with ensuite and walk in robe is at one end of the home, the other 3 bedrooms all will floor to ceiling built in robes are at the other end and includes the family room in that area. The family room is the perfect place for the younger members of the family to relax and entertain themselves and their friends.

The galley style kitchen, living and dining area is open plan with timber floors and also a great place to spend time with family and friends. A feature of this area is the patio stacked doors that lead out to the pergola and decking areas. When open fully they create the perfect inside/outside entertainment space. The home has had a lot of recent renovations and includes modern ensuite, main bath room, laundry and wc. All the outside windows of the home have been replaced with new aluminum windows. There have also been improvements made to all bedrooms, family room and the living area.

Other features inside include ducted reverse cycle air- conditioning, some high ceilings and quality fixtures and fittings.

Outside the home offers great entertainment and fun with the large renovated pergola and raised timber decking area and enclosed spa, the spa is included in the sale. Also outside there is heaps of parking, a double carport, good size garage with lights, power and concrete floor, garden shed, rain water tanks, established garden and a peaceful, private and quite location.

The suburb of Vista is at the gate way to Adelaide Hills and only 30 minutes to the city, 45 minutes to the Barossa Valley and about an hour to Mannum on the Murray River. Plus a short walk to one of the best conservation parks in the country. Anstey Hill.

A fabulous opportunity awaits the lucky buyer of this home. If you are looking for a good size family home on a huge block in an outstanding location. This home is for you.

Sale by Expression of Interest Closing 5pm Tuesday 16th January 2024 (Unless Sold Before)

If you are interested in making an offer on this property, I would suggest you submit your offer as soon as you can. As mentioned above the property can be sold at anytime.

Highly Recommended please see below for dot point features.

4 BED | 2 BATH | 2 CAR

PRICE:
\$945,500

OPEN FOR INSPECTION:
N/A



Jon Downs
0412977914

jondowns@atrealty.com.au

www.atrealty.com.au

RLA: 269823

37 Janlyn Road,
VISTA

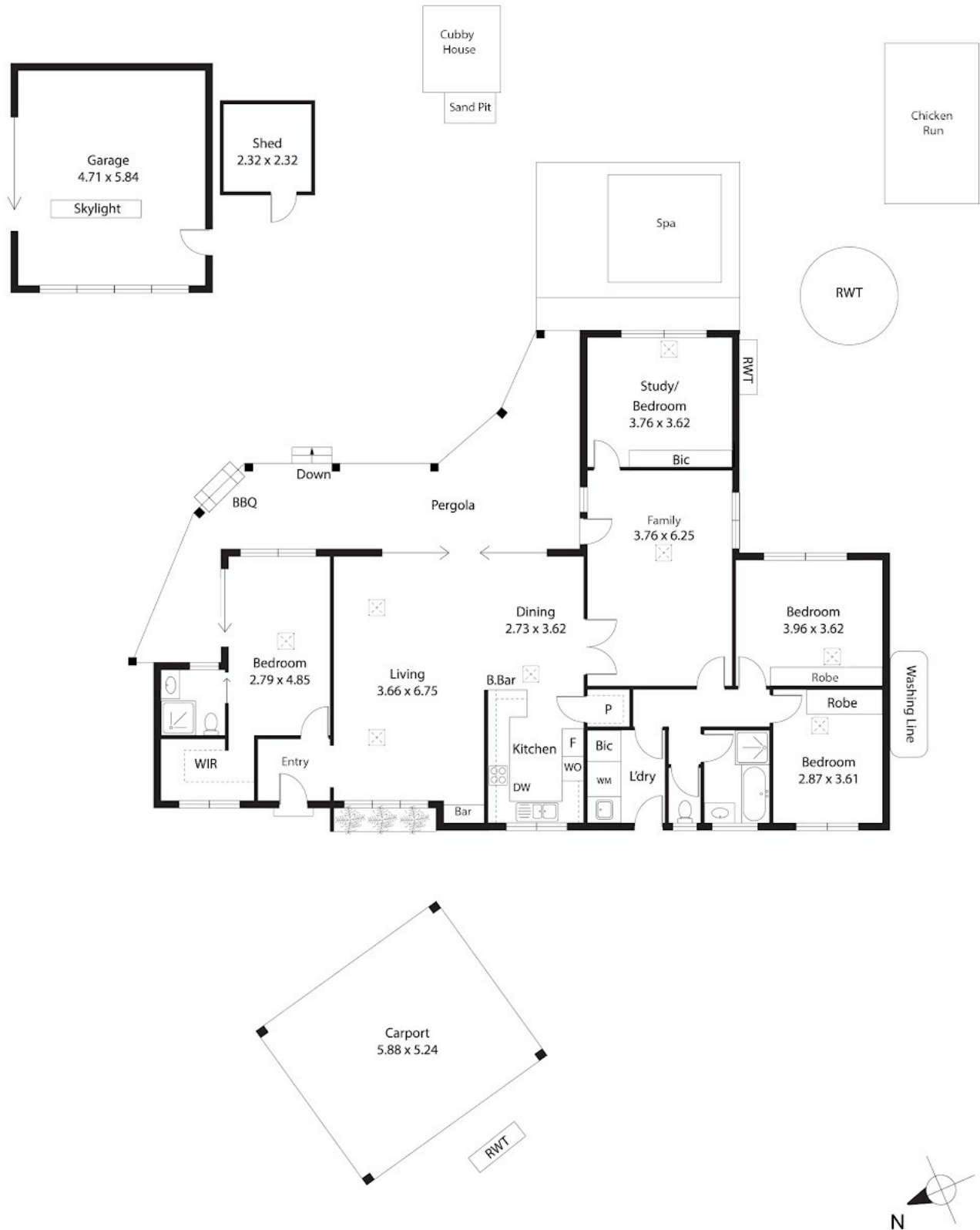

Disclaimer: Please note this floor plan is for marketing purposes and is to be used as a guide only. All dimensions are estimates only and may not be exact measurements.

Carport: 50.81SQ.M
 Garage: 27.51SQ.M
 Shed: 5.38SQ.M

TOTAL: 294.73SQ.M

Jon Downs
 0412977914
 jondowns@atrealty.com.au
www.atrealty.com.au

This Drawing is for illustration purposes only. All measurements are internal and approximate. Details intended to be relied upon should be independently verified.

