



FOR SALE

TOP FLOOR MANTRA 2 BEDROOM DUAL KEY APARTMENT

Unwind and embrace the luxurious lifestyle at Salt Beach Mantra Resort with this top floor 2 bedroom dual key apartment . Enjoy the best of both worlds with one fully self contained one bedroom unit plus another well equipped hotel room perfect for a variety of accommodation needs.

What's more the breathtaking views over the pool , tennis courts north-facing Kingscliff Hill and the new Tweed Valley Hospital create a picturesque backdrop for owners or guests. Take in the natural beauty as you relax on your private balcony or go for a stroll along the pristine Salt Beach or walking and bike tracks just moments away.

Delight in the convenience of full access to the resort's exceptional facilities which include everything from 2 swimming pools , spa , fitness centre nearby and local dining options such as Fins award winning seafood restaurant and the family friendly Saltbar. Whether you're seeking a peaceful getaway unit or action-packed adventure , Salt Beach Mantra has something for everyone and always a holiday destination of choice for interstate visitors.

The 102sqm apartment is located in a relaxed location and is being offered for sale fully furnished.

Returns available on request.

Mark Humphries 0411989772
markh@atrealty.com.au

Apartment Features Include

- 1 bedroom fully self-contained apartment
- 1 hotel room with connected entry
- 2 car – Secure Basement Parking
- Open Plan Lounge , dining , kitchen and large balcony
- Hotel room with private balcony
- Air Conditioning
- New Shutters on order

2 BED | 2 BATH | 2 CAR

PRICE:
\$609,000

OPEN FOR INSPECTION:
N/A



Mark Humphries
0411989772
markh@atrealty.com.au
www.atrealty.com.au

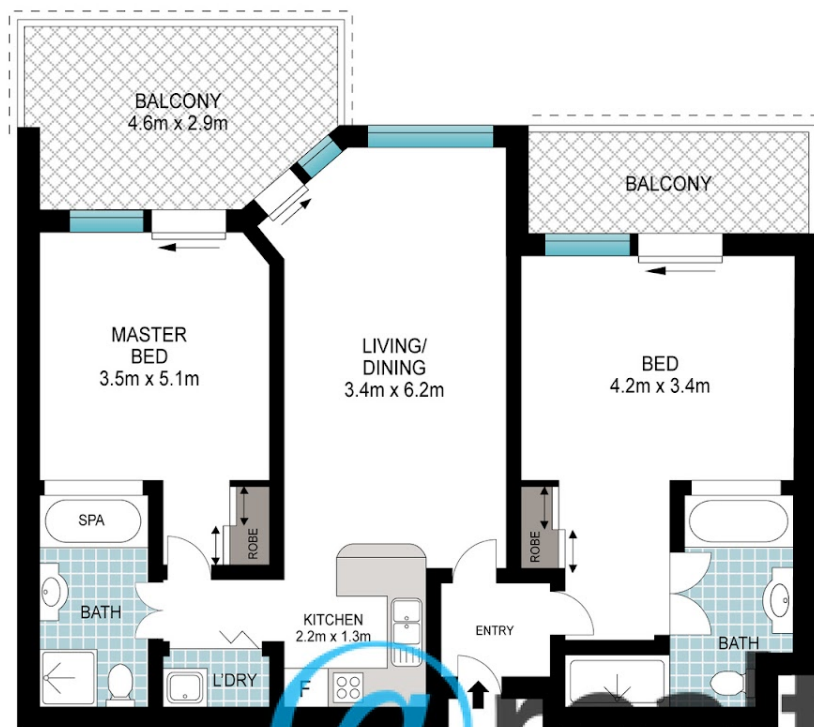

Scale in metres. Indicative only. Dimensions are approximate. All information contained herein is gathered from sources we believe to be reliable. However, we cannot guarantee its accuracy and interested persons should rely on their own enquiries.

INT:	89 m ²
EXT:	21 m ²
TOTAL:	110 m ²



7303/04_9 Gunnamatta Drive, Kingscliff

@realty

Disclaimer: Please note this floor plan is for marketing purposes and is to be used as a guide only. All dimensions are estimates only and may not be exact measurements.