

FOR SALE

DISCOVER YOUR DREAM HOME IN THIS CHIC AND SPACIOUS 4-BEDROOM PROPERTY!

Certainly! The Chesterfield estate is an exclusive residential development that offers a blend of luxury, comfort, and convenience. Let's delve into the features of this stunning home:

- 1. Entrance Hall and High Ceiling:** As you step inside, you'll be greeted by a bright and airy entrance hall with a high ceiling. The wide corridor can also serve as a study area, adding functionality to the space.
- 2. Master Suite:** The front of the home boasts a lavish master suite. It features a walk-in robe for ample storage and an ensuite with dual sinks and a large shower—a perfect retreat for relaxation.
- 3. Bedrooms and Lounge Area:** The other three bedrooms are located at the back of the home. Two of them have built-in robes (BIR), while one has a walk-in robe (WIR). Additionally, there's a generous kids' lounge/activity area—a great space for family bonding or kids escape!
- 4. Open-Plan Living:** The heart of the home is the open-plan kitchen, dining, and living area. Here, you can entertain guests or unwind with your family. The chef's delight kitchen includes a walk-in pantry, a large island bench, and quality appliances.
- 5. Alfresco and Outdoor Living:** The living area seamlessly flows to the alfresco—a delightful outdoor space. Imagine enjoying meals on the spacious deck or firing up the BBQ area or built in pizza oven. The alfresco overlooks the low-maintenance garden, fully fenced for kids and pets.
- 6. Additional Features:**
 - Sheers and Blinds: All windows are adorned with sheers and or blinds for privacy and light control.
 - Climate Control: Ducted heating and evaporative cooling ensure comfort year-round.
 - Storage Solutions: Multiple linen, storage, or coat cupboards keep things organized.
 - Garage: The large, remote two-car garage provides secure parking.
 - Stylish Laundry: Even the laundry area exudes style and functionality.

4 BED | 2 BATH | 2 CAR

PRICE:

\$770,000 - \$835,000

OPEN FOR INSPECTION:

N/A



Melissa Ahearn

0409183763

mahearn@atrealty.com.au

atrealtypropertysalesgippsland.com.au

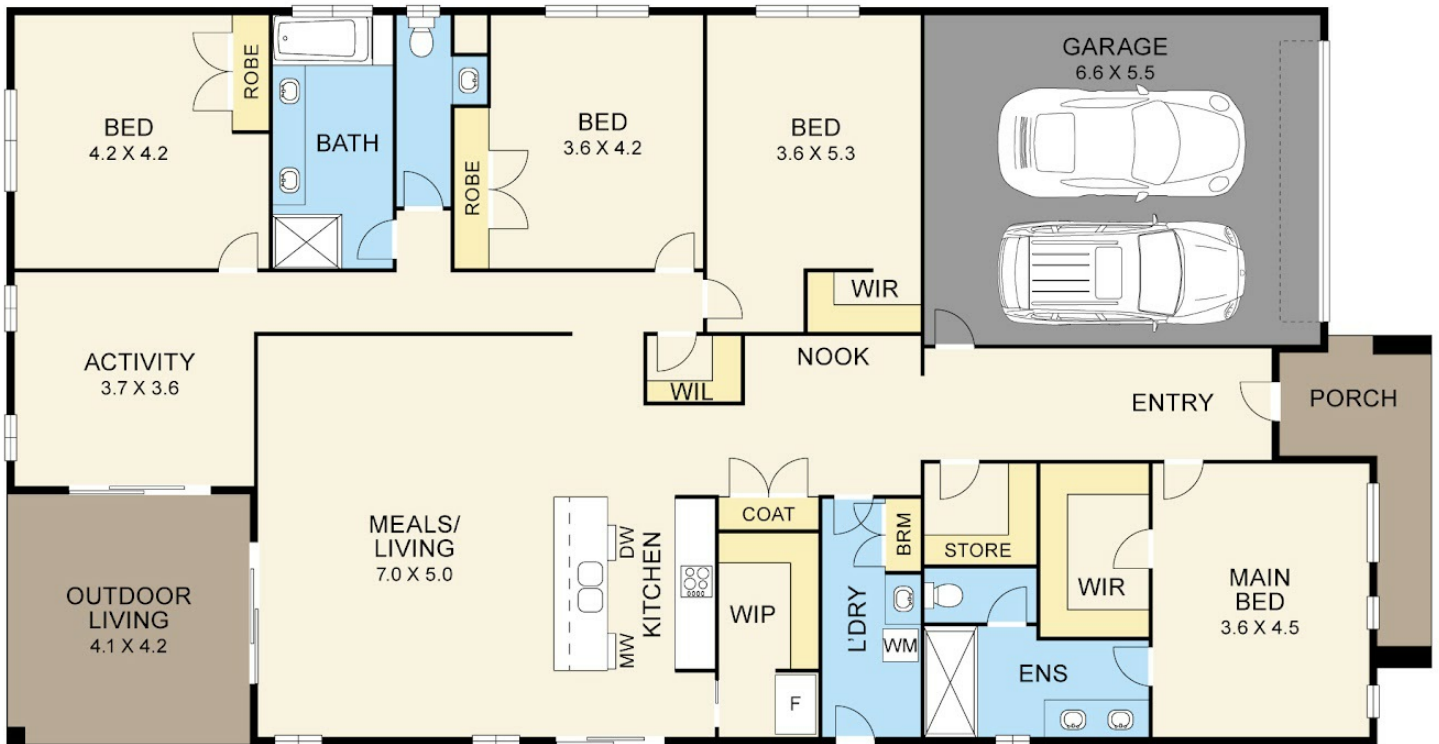

FLOOR PLAN



SITE PLAN

121 EMBERWOOD ROAD, WARRAGUL

Disclaimer: Floorplan is for illustration only, prospective purchasers are advised to make their own enquiries.

COMPLETE IMAGE
ARCHITECTURAL + REAL ESTATE MEDIA



Disclaimer: Please note this floor plan is for marketing purposes and is to be used as a guide only. All dimensions are estimates only and may not be exact measurements.