

73 KORUMBURRA-BENA ROAD, KORUMBURRA, VIC, 3950



# FOR SALE

## SPECTACULAR "SHADOW'S RUN".

Welcome to Shadow's Run. Located only a handful of minutes from the delightful township of Korumburra and ½ an hour from the beach, this 9.5 acres small acreage property is the perfect place to live the life you've always wanted.

As you arrive, you will appreciate the sweeping driveway and landscaped gardens that form the grand entry to this truly unique and remarkable property and the views are sure to instantly impress.

The home is an impressive 4 bedroom, 2 bathroom residence with plenty of living space. Entertain in style in the generous open plan kitchen and lounge area that opens onto a large, covered outdoor entertaining area with built in barbecue and open fire place. Stunning views of the surrounding countryside can be enjoyed from here, while the wrap-around deck is perfect for summer barbecues and sunset drinks.

The quality built sandstone home is fully appointed with quality features including high ceilings, built in wardrobes, lots of extra storage throughout, reverse cycle air conditioner, solid fuel heater and some double glazed windows. The kitchen features breakfast bar, 900ml oven, oodles of storage drawers and cupboards, dishwasher and walk in pantry. All the bedrooms are generous in size and have garden views. The master bedroom is rather Regal and boasts a sizeable walk in robe and ensuite with oversized shower.

There is direct access into the laundry from the double car garage with remote door for ease of unloading shopping or getting the family inside on a rainy day. A single carport and breezeway also provides extra vehicle storage and a handy place to have a sheltered clothesline.

There is attention to detail everywhere you turn at this property from the extensive retaining walls and gardens to the kids' play area with cubby house, swings and monkey bars. There's even a deluxe rabbit or guinea pig run with tunnels and all!

If storage or a place to have projects is on your bucket list, look no further. A massive colourbond shed with power, concrete floor, toilet, high clearance and additional space for a gym or a studio, are all on offer here. There's also a 12x3m lean-to for a boat, wood or hay storage for example. The land is gently undulating, well fenced with a picturesque dam and is ideal for raising some livestock or cutting for hay.

Located on a sealed road, 1.5 hours from the city, this expansive home offers you a rare opportunity to escape the hustle and bustle of city life while being close to schools, shopping centres,

4 BED | 2 BATH | 8 CAR

PRICE:  
\$1,490,000

OPEN FOR INSPECTION:  
N/A



**Christie Nelson**  
**0407812904**  
christienelson@atrealty.com.au  
Christie Nelson Real Estate

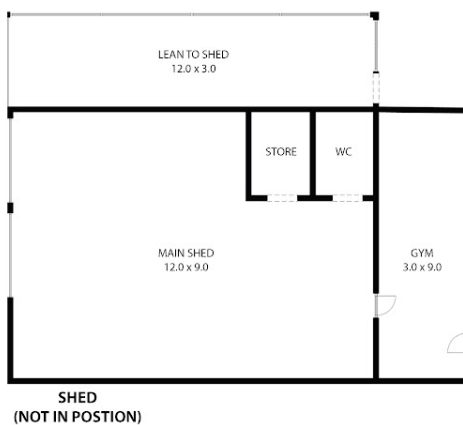

75, Korumburra 3950

TOTAL APPROX. FLOOR AREA 367 SQ.M

Whilst every attempt has been made to ensure the accuracy of the floor plan contained here, measurements of doors, windows, rooms and any other items are approximate and no responsibility is taken for any error, omission, or misstatement. This plan is for illustrative purposes only and should be used as such by any prospective purchaser.

SHED : 177 SQ.M

Disclaimer: Please note this floor plan is for marketing purposes and is to be used as a guide only. All dimensions are estimates only and may not be exact measurements.