



**SOLD**

## SPACES THAT MAKE THE PERFECT SENSE!

Fresh and vibrant this lovely two-bedroom property is certain to impress all those who choose to inspect. Upon entry the home boasts a large open plan living area which is flooded with plenty of natural light and conveniently separated from the kitchen meals area. Presenting a beautiful well maintained kitchen fitted with gas cooktop and ample cupboard and clear bench space throughout whilst all adjoining the dining/meals area. Comprising of two spacious fitted bedrooms including built in robes. Additional appointments include generous main bathroom, separate toilet, oversized laundry, heating and ample storage throughout. Outdoors the home showcases a large double carport and low maintenance courtyard ideal for young couples. Nestled within close proximity to Wyndham Vale IGA, Parklands and reserves, Iramoo Primary School and only a short distance to both Manor Lakes and Werribee CBD. An immaculately presented property that is the perfect place to call home or add to your property portfolio. Call to arrange our inspection today!

2 BED | 1 BATH | 2 CAR

PRICE:  
\$438,000

OPEN FOR INSPECTION:  
N/A



**Joseph Hanna**  
0423966320  
joseph@atrealty.com.au  
[www.atrealty.com.au](http://www.atrealty.com.au)

## Floor Plan

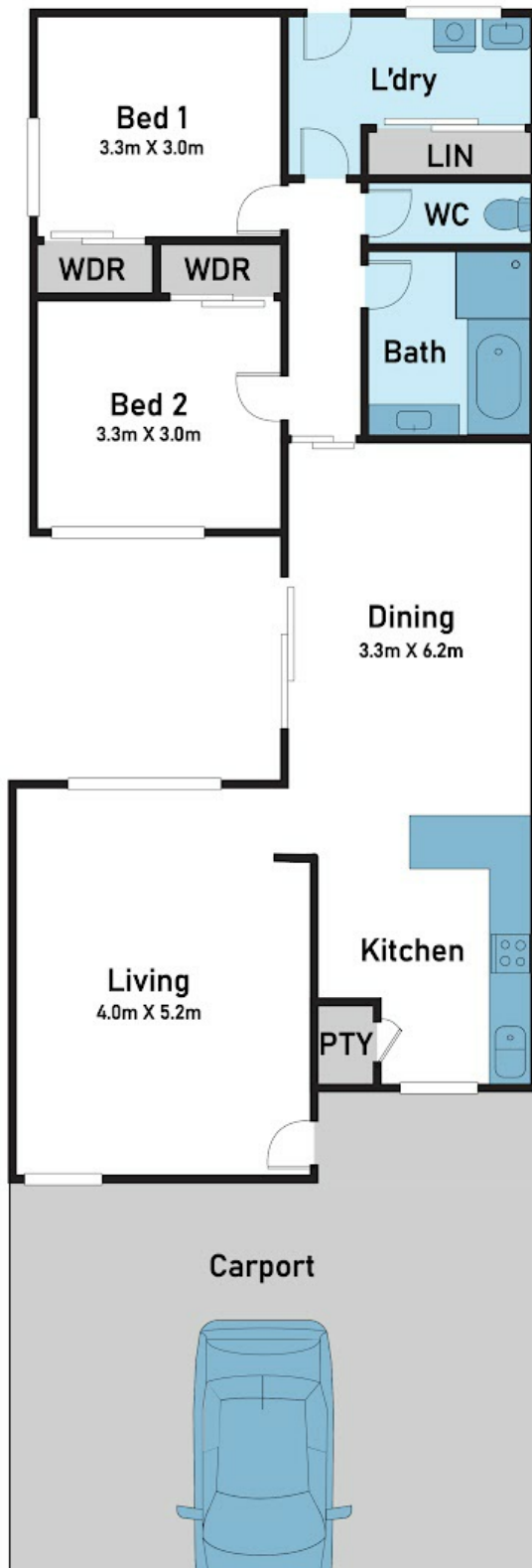

## Site Plan



Disclaimer: Please note this floor plan is for marketing purposes and is to be used as a guide only. All dimensions are estimates only and may not be exact measurements.

\* Dimensions are approximate and for illustrative purposes only