



FOR LEASE

LIVE LIFE TO THE FULLEST IN A LUXURIOUS 2 BEDROOM FLAT IN BURLEIGH HEADS!

Leave the hustle and bustle of the city and experience the beauty of the Gold Coast with this well located unit in Burleigh Heads!

Located on the top floor overlooking Burleigh Hill within easy walking distance to Tallebudgera Creek, the famous beaches of Burleigh and the award winning restaurants, café and shopping precinct in James Street, Burleigh Heads.

Property Features include

- Two Bedrooms with built in robes
- Additional sunroom
- Open plan living
- Timber floorboards throughout
- Ceiling fans throughout
- Split cycle air-conditioning to lounge
- Shared front porch area
- Original Bathroom with separate toilet

This property also includes one carport for ease of parking.

The location of this flat is unbeatable, with the beach right at your doorstep. Enjoy long walks along the sand, a swim in the ocean or a delicious meal at one of the many cafes and restaurants.

With a price of \$600 per week, this flat won't be on the market for long. Don't miss out on this amazing opportunity and contact us today to arrange an inspection. You will not be disappointed with this stunning flat in Burleigh Heads.

TO INSPECT OR APPLY, CLICK HERE:

<https://myatrealty.com/v2/properties/9676757/rental-application-landing-page>

2 BED | 1 BATH | 1 CAR

PRICE:
\$600 per week

OPEN FOR INSPECTION:
N/A



@realty National Head Office
1300299377
headofficerentals@atrealty.com.au
www.atrealty.com.au

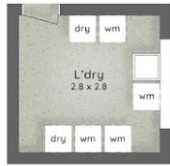

:: FLOOR PLAN
Shared Laundry
(Not Actual Location)



:: FLOOR PLAN
Level 1 - 2.6m Ceiling

POINTS OF INTEREST

1. RAYMOND COURT
2. James Street Boutiques, Bars & Restaurants
3. Burleigh Headland
4. Burleigh Heads Beach
5. Burleigh Heads Primary School
6. Burleigh Esplanade | 7. North Burleigh S.L.S.C
8. Paddock Bakery | 9. Miami One
10. Lower Gold Coast Highway Cafes & Restaurants



:: LOCATION MAP

RAYMOND COURT 6/10 Beelgu Street BURLEIGH HEADS

2 Bed 1 Bath 1 Car

Internal 50m² | Enclosed Patio 8m² | Total 58m²

This is not a legal document therefore all measurements and information provided is subject to survey. No permission is given to use or alter this Floor Plan without the consent of Pure Design Concepts. The overall presentation style, layout, imagery, fonts, background colours and terminology has been originally created by PDC and is subject to strict copyright. No ownership is taken of building design. Find out more at puredesignconcepts.com.au

Disclaimer: Please note this floor plan is for marketing purposes and is to be used as a guide only. All dimensions are estimates only and may not be exact measurements.