

1107 SWAN BAY ROAD, SWAN BAY, NSW, 2324



SOLD

ACREAGE AND WATERFRONT, THE PERFECT COMBINATION

If you are looking for the country lifestyle many desire these days, but still be close to the waterfront, then this 5.5ha (13.60 acres) property would make the perfect escape from the city with all the ingredients of the ideal nature lover's getaway.

Rare opportunity to secure a blank canvas and build your dream home on an acreage close to the water. A large metal shed with three sliding doors is situated on the property.

It has contained within it three bedrooms, bathroom, kitchen, workshop, outdoor annex, and space for three vehicles. The shed has solar panels with battery backup and 2 x 5 thousand litre water tanks.

The property is approximately 20 minutes from Raymond Terrace, 20 kilometres from Williamtown Airport and less than two hours' drive from Sydney.

With its unbeatable position, lush, meticulous grounds, this close to waterfront acreage truly represents alive style like no other and is certain to move quickly – blink and you will miss it.

- Walking distance to swan bay waterfront
- Large metal shed with three bedrooms, kitchen, bathroom, workshop and accommodation for three vehicles
- Water Tanks (2 x 5 thousand Litres)
- Solar panels with battery backup

Disclaimer: All information contained herein is obtained from property owners or third-party sources which we believe are reliable. We have no reason to doubt its accuracy, however we cannot guarantee it. All interested person/s should rely on their own enquiries.

0 BED | 0 BATH | 0 CAR

PRICE:
\$900,000

OPEN FOR INSPECTION:
N/A



Debra Thomson
0450528440
debrathomson@atrealty.com.au
www.atrealty.com.au

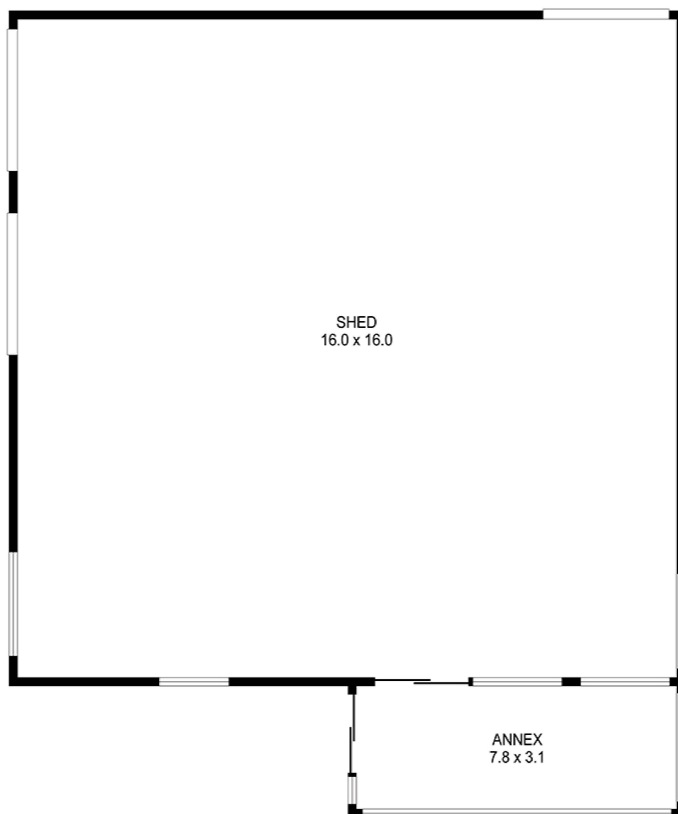

Scale in meters. Dimensions are approximate. All information contained herein is gathered from sources we believe to be reliable. However, we cannot guarantee its accuracy and interested persons should rely on their own enquiries.

POWERED BY **SMILE ELITE™**
PROUD PARTNERS WITH SYDNEY COUNTRY LIVING

Disclaimer: Please note this floor plan is for marketing purposes and is to be used as a guide only. All dimensions are estimates only and may not be exact measurements.