

SOLD

AUCTION! PRICED TO PLEASE!

Auction Saturday 24th February 2024!

Character, charm, and cosy are the first impressions that come to mind the minute you inspect this beautifully presented 2-bedroom weatherboard home. Terms, 5% or 10% Deposit. Settlement 30/60 days negotiable!

Located in a prime location within minutes' walk to Bayswater shopping percent, train station, bus stops, 4 primary schools, secondary school, preschools, kindergartens, medical facilities, sporting grounds, parks, clubs, restaurants, and eateries all within minutes' drive to Knox Westfield, Knox Ozone entertainment centre, Eastlink freeway, Knox hospital and the bustling Studfield shopping hub.

This charming residence offers an open-plan design comprising kitchen meals area, with brand new appliances, open plan to lounge/living area. 2 spacious bedrooms, family bathroom, toilet, and laundry.

The private front and rear courtyard gardens are fully fenced and perfect for young children and pets to play and a double carport with remote roller door giving easy access to the home.

Features include. Stainless steel appliances, gas ducted heating, split system air conditioning, wood fireplace, hard wood floors, carpets to bedrooms, dishwasher, manicured gardens, front pergola with BBQ area, storage shed, fully fenced and the list continues. Hurry to inspect! An inspection will delight!

Thinking of selling now or in the future? For a free-market appraisal Call Luciano 0423 181 161, Lou 0417-166-668 / Leeanne 0404-261 469 or email lou@atrealty.com.au Statement of information will be available upon request.

Inspection times and property availability are subject to change without notice. Disclaimer: All information contained herein is gathered from sources we believe to be reliable. We cannot guarantee its accuracy and interested parties should make and rely on their own enquiries.

2 BED | 1 BATH | 2 CAR

PRICE:
\$660,000

OPEN FOR INSPECTION:
N/A



Lou Rinnovasi
0417166668
lou@atrealty.com.au
www.atrealty.com.au

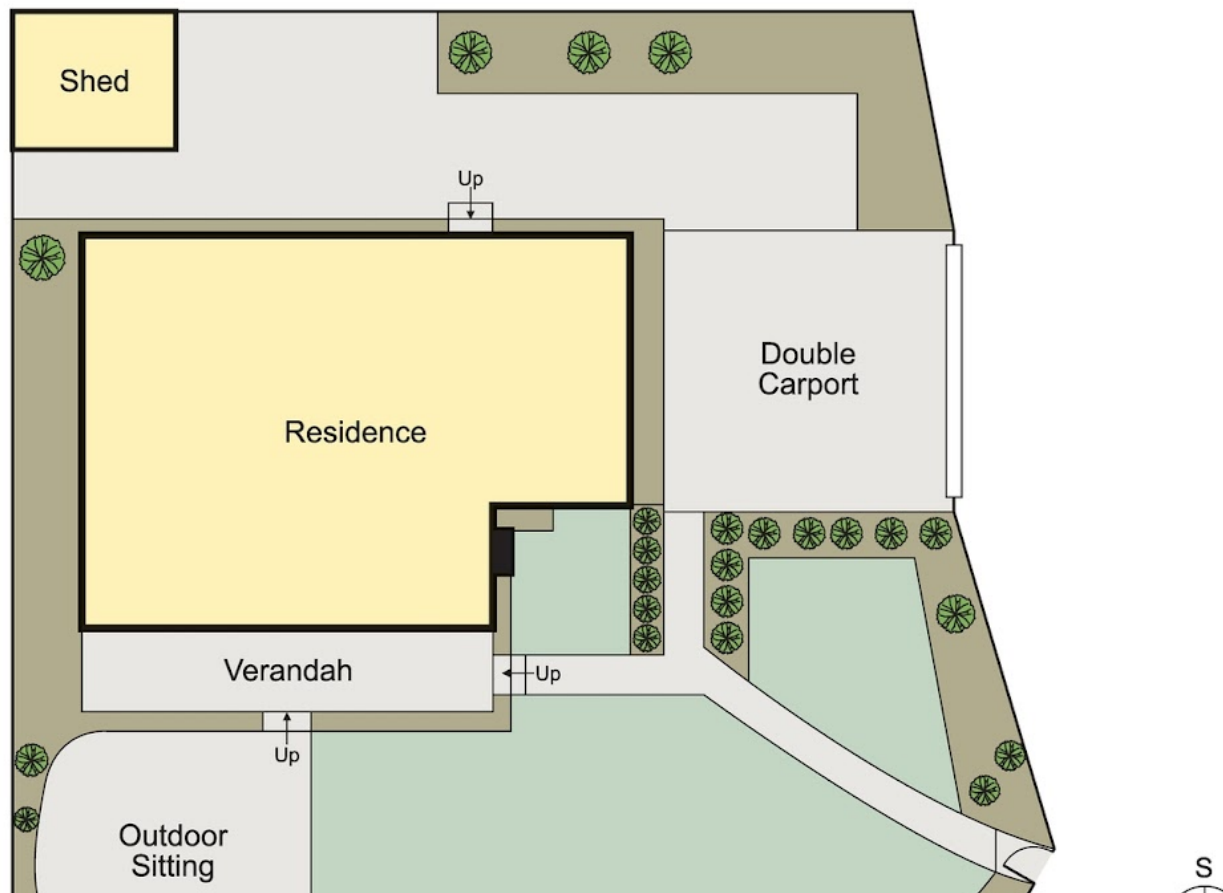
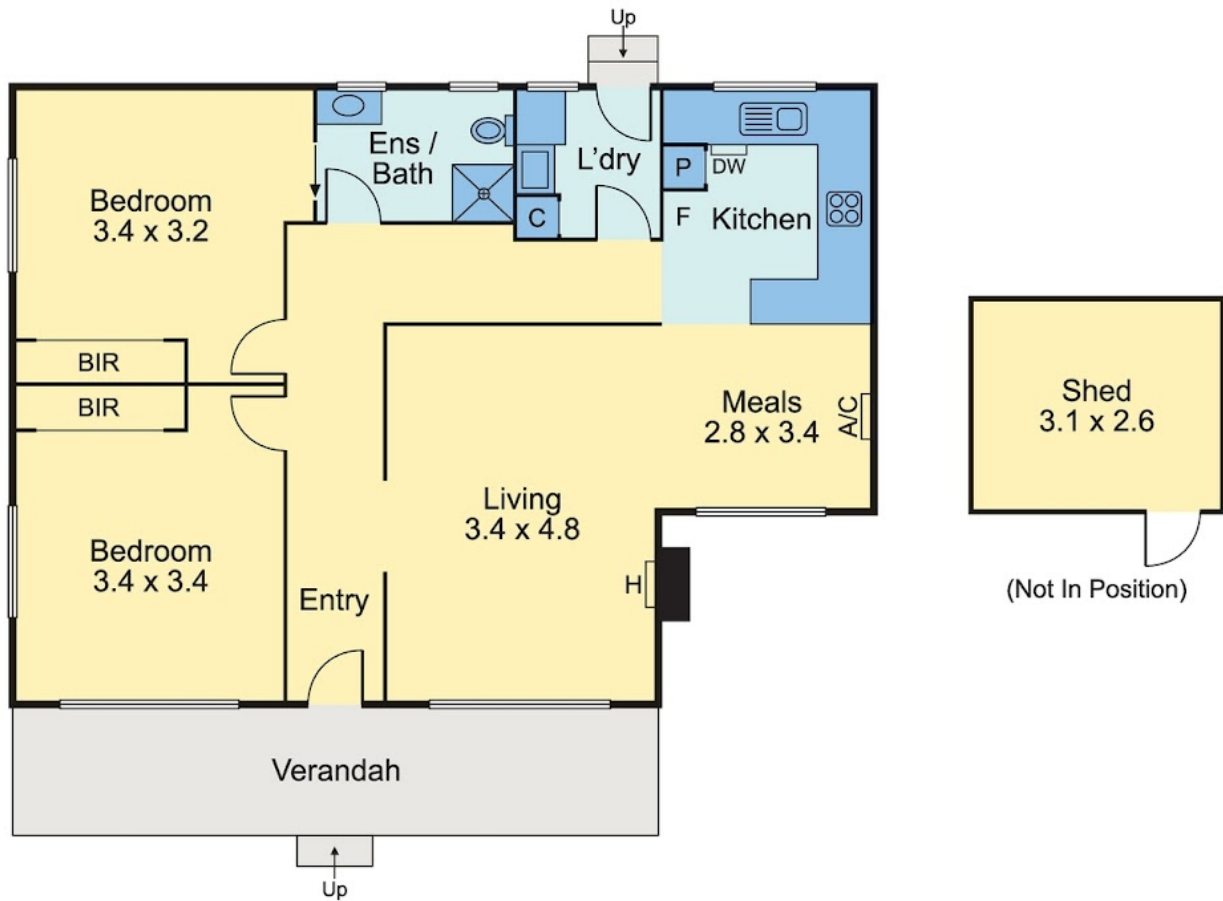

Disclaimer: Please note this floor plan is for marketing purposes and is to be used as a guide only. All dimensions are estimates only and may not be exact measurements.