



# SOLD

## EXECUTIVE LIVING - VERSATILE DESIGN

This jaw-dropping McDonald Jones home boasts the most versatile floor plan and highest level of inclusions you could ever want. Let me take you on a tour.. Enter via the extra wide foyer and instantly feel at home. To your left you will be greeted by the best children's retreat ever, featuring a spacious lounge, built-in study or computer station, 3 huge bedrooms and a beautiful bathroom with separate powder room. Continue past the foyer to a home office or study area and entry to the huge double garage with drive-through access to the back yard. Next is a custom-designed home media room with hard-wired speakers and more than enough room for the whole family on movie night! The heart of the home is the kitchen and this one is no exception. An oversized island bench centers around the stunning design, featuring stone benchtops, glass splash-back and glass-door pantry. The spacious main suite features his and hers walk-in robes, designer ensuite with bathtub and back yard access via glass sliding doors. Where this home really captivates is the entertaining aspect. Adjoining the kitchen is a large open plan living and dining with double-stack sliding doors out onto the expansive alfresco dining that overlooks the gorgeous inground pool with waterfall feature and mood-lighting. You also have loads of very private yard space for the kids and pets. Other features include, solar power, ducted air conditioning throughout, ducted vacuum system and alarm system. Your family's dream home awaits! Call Peter Bullman today for more information!

5 BED | 2 BATH | 2 CAR

PRICE:  
\$1,315,000

OPEN FOR INSPECTION:  
N/A



**Peter Bullman**  
0401394394  
peterb@atrealty.com.au  
[www.atrealty.com.au](http://www.atrealty.com.au)

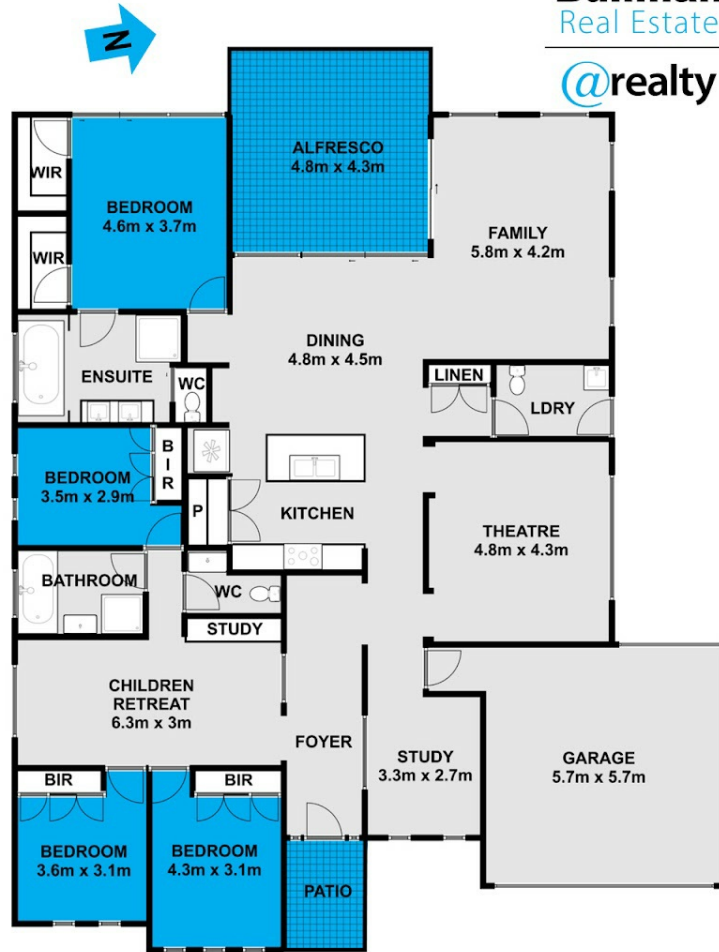

This floor plan including furniture, fixture measurements and dimensions are approximate and for illustrative purposes only.  
@Realty gives no guarantee, warranty or representation as to the accuracy and layout.  
All enquiries must be directed to the agent, vendor or party representing this floor plan.

**9 Siltstone Avenue Horsley**

Disclaimer: Please note this floor plan is for marketing purposes and is to be used as a guide only. All dimensions are estimates only and may not be exact measurements.