



SOLD

WITH TODAY'S COST TO BUILD, AND LAND PRICES THROUGH THE ROOF, THIS 35.5SQ PROPERTY IS BARGAIN BUYING!

COME TO THE OPEN HOME ON SATURDAY 10.00 - 10.45 AND SEE THIS AMAZING HOUSE FOR YOURSELF! This is indeed an immaculate, well maintained, extremely spacious family home. Location is superb, just a hop, skip and a jump to the Tin Can Bay Country Club for a round of golf, or a relaxing game of bowls. A short drive takes you to everything that Tin Can Bay has to offer including Doctors, shops, Library, restaurants, and most exciting of all the Dolphins! The home has many features and benefits as listed below:-

- * 35sqsq of high quality fixtures and fittings
- * DLUG + a double carport to side of home
- * 2 x air-conditioners for those humid days
- * Huge Separate dining room and lounge room
- * Large family room with an expansive kitchen
- * Roomy undercover entertainment area
- * Room for a pool
- * Two 3 x 3 garden sheds + a fish pond + bush house for your orchids

With land at a premium in Tin Can Bay and most blocks listed at over \$350,000, combined with rocketing prices to build, this home is very competitively priced and looking for new owners !! If you are looking for location, quality and size, then you must inspect this home. Book your inspection by calling Janet Young. I look forward to your call!

4 BED | 2 BATH | 3 CAR

PRICE:
\$795,000

OPEN FOR INSPECTION:
N/A

@realty

Janet Young
0438587239
janet@atrealty.com.au
www.atrealty.com.au

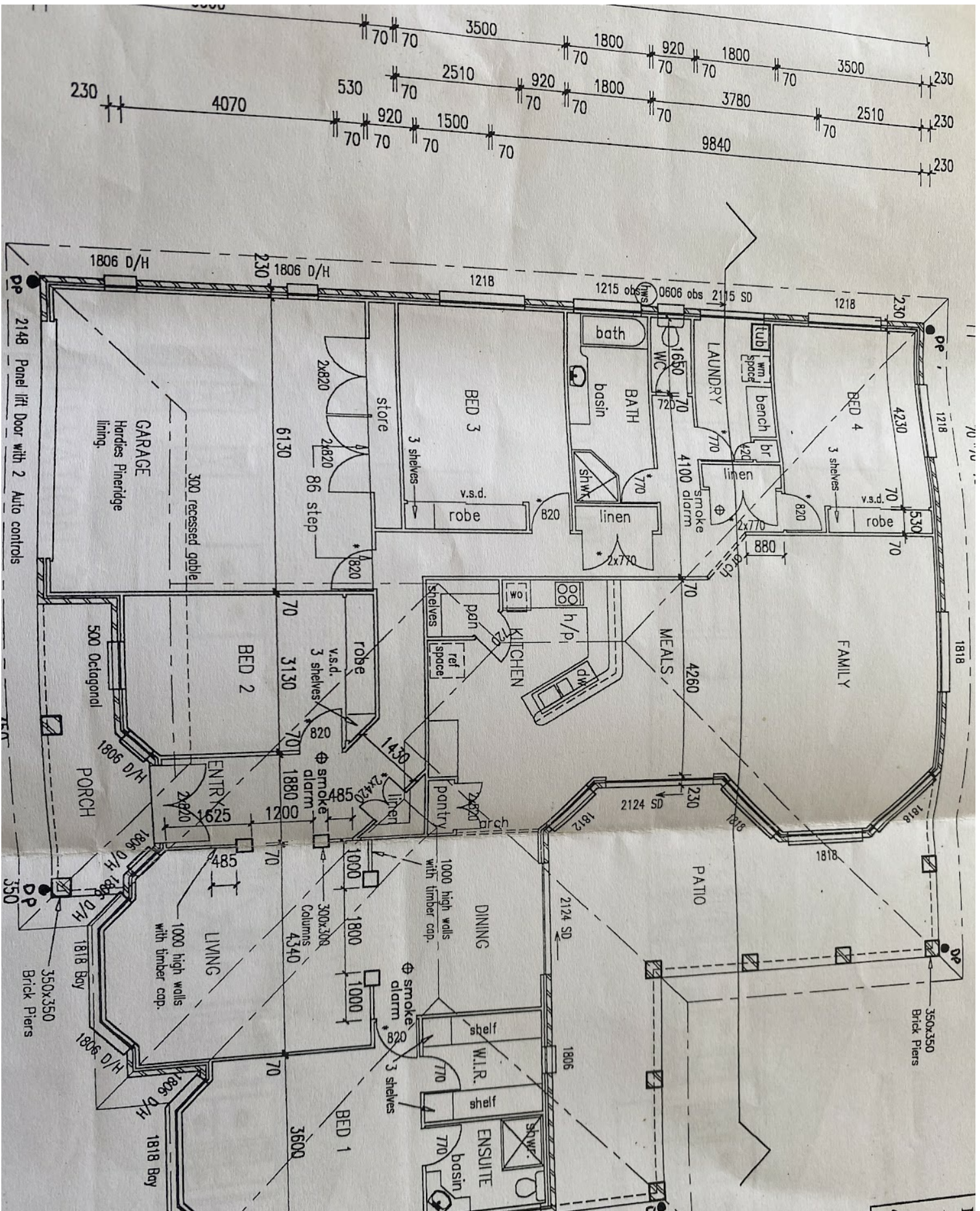

Disclaimer: Please note this floor plan is for marketing purposes and is to be used as a guide only. All dimensions are estimates only and may not be exact measurements.