

# FOR SALE

## CONTEMPORARY 2 BEDROOM + STUDY APARTMENT SITUATED ABOVE TOP RYDE CITY

Offering a luxurious and easy lifestyle, this spacious contemporary apartment is securely set in the renowned 'Iluvia' building. It's peacefully located above Top Ryde City, enjoying the convenience of shops, cafes, restaurants and buses at its doorstep.

- Natural light enhances the open plan living and dining space
- A versatile study separated from the living by timber screens
- Access to resort style leisure facilities including pool, gym
- Covered balcony overlooking the common gardens and pool area
- Stone kitchen featuring a gas cooktop and a Smeg dishwasher
- Two bright bedrooms fitted with mirrored built-in wardrobes
- Master enjoys balcony access and an ensuite with a bath tub
- Contemporary bathroom, European laundry and air conditioning
- Video intercom access, single car space plus a storage cage
- Located close to Ryde Public School and public transport

Apartment Size Approx.  
Internal incl Balcony: 106sqm Level 6  
Carspace: 13sqm Level 4  
Storage: 3sqm Level 3  
Total Area: 121sqm

Built: 2013  
Size complex: 131 lots

Out goings:  
Strata: \$1,704 per quarter  
Council: \$326 per quarter  
water: \$171 per quarter

Potential Rent: \$900-\$920 Per Week

Address: 616c/5 Pope Street, Ryde 'Iluvia' building  
For Sale Expressions of interest

2 BED | 2 BATH | 1 CAR

PRICE:

Expression of Interest

OPEN FOR INSPECTION:

N/A



**Gavin McCutcheon**

**0413686969**

[gavin@atrealty.com.au](mailto:gavin@atrealty.com.au)

[buyingsellingrenting.com.au](http://buyingsellingrenting.com.au)

## Unit 612C, 5 Pope Street, Ryde

3 Bed 2 Bath 1 Car

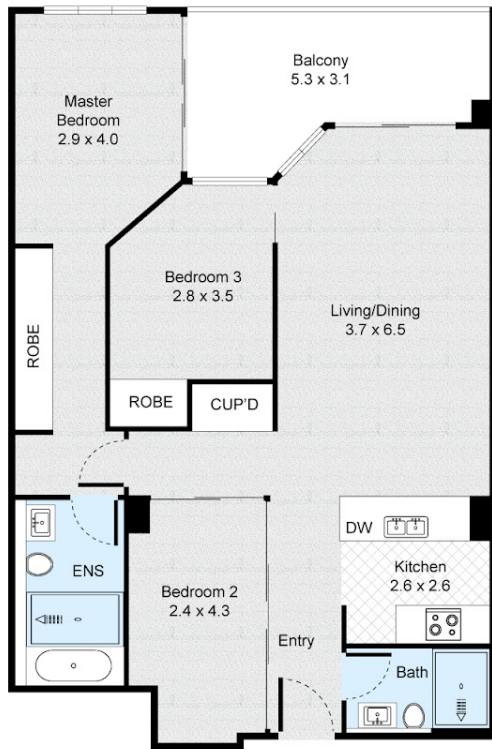

FLOOR PLAN

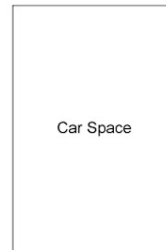

(Not In Position)

CAR SPACE

Internal : 87m<sup>2</sup>  
External : 11m<sup>2</sup>

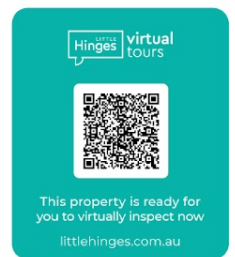

All information contained herein is gathered by Little Hinges.  
Whilst the scanning technology is highly reliable,  
we cannot guarantee its accuracy and interested parties  
should rely on their own enquiries.

Disclaimer: Please note this floor plan is for marketing purposes and is to be used as a guide only. All dimensions are estimates only and may not be exact measurements.