

# FOR SALE

## GORGEOUS MEDITERRANEAN VILLA | WHISPER QUIET NO-THROUGH STREET | SOUGHT AFTER WINDARRA ESTATE

Gorgeous Mediterranean Villa  
Whisper Quiet No-through Street  
Sought After Windarra Estate

Only footsteps back from the iconic City Beach Football Ovals, the City Beach Groyne, Surf Club and café scene is this gorgeous Mediterranean villa with beautiful backyard and front gardens, excellent floor plan and family separation.

Enjoy strolling through gorgeous virgin Bold Park bushland adjacent

Enjoy Perth's coast most traffic free commute to the city - straight up Oceanic Drive

Excellent floor plan design sees the formal living at the front of the house with the informal family areas at the rear flowing out to lush, alfresco living space with spa and backyard under the shade of atmospheric pergola.

Three king-size kids rooms are in their own secluded wing of the house with the master suite and parents retreat on the first floor. The backyard has an additional studio / teenagers retreat/ workshop.

Inclusive of a garden shed and a mini herb garden at the top of the yard will inspire meals for you family and remind you of how good life will be here.

**DISCLAIMER:** Whilst every care has been taken with the preparation of the particulars contained in the information supplied and believed to be correct, neither the agent nor the seller nor servants of both, guarantee their accuracy. Interested persons are advised to make their own enquiries and satisfy themselves in all respects. The particulars contained are not intended to form part of any contract.

4 BED | 2 BATH | 2 CAR

PRICE:

Shore by Negotiation | From \$2.65M

OPEN FOR INSPECTION:

N/A



**Scott Swingler**

**0403344649**

[scott@shore-property.com.au](mailto:scott@shore-property.com.au)

Shore Property



### Approximate Areas:

Ground Floor	219 m <sup>2</sup>
First Floor	75 m <sup>2</sup>
Alfresco	50 m <sup>2</sup>
Balcony	5 m <sup>2</sup>
Garage	37 m <sup>2</sup>
Studio	33 m <sup>2</sup>
Porch	23 m <sup>2</sup>

**Total 442 m<sup>2</sup>**

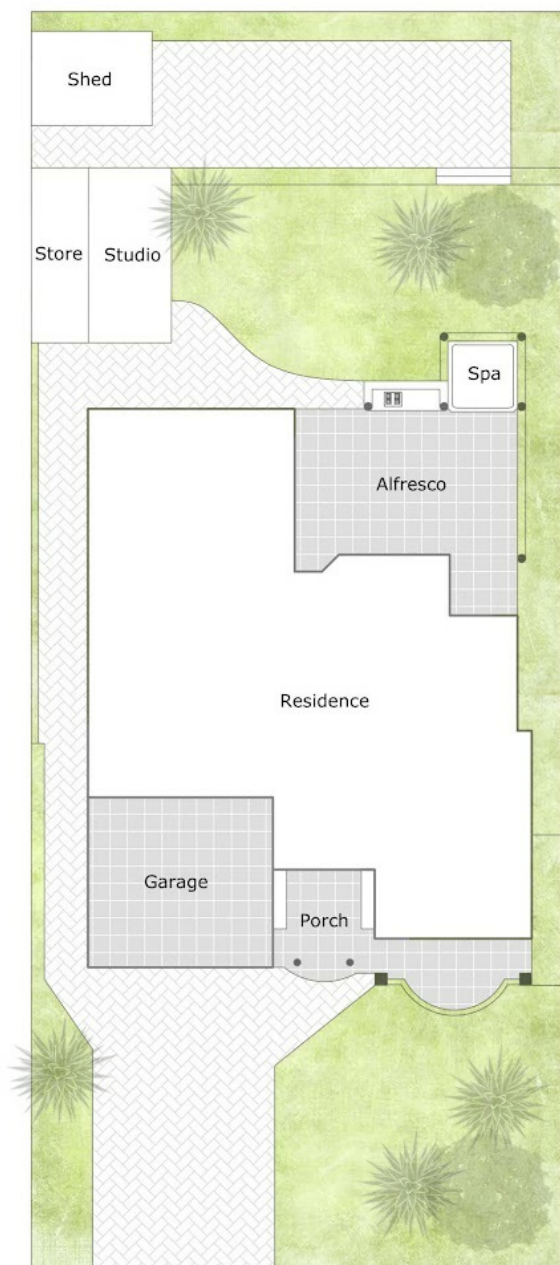

Disclaimer: Please note this floor plan is for marketing purposes and is to be used as a guide only. All dimensions are estimates only and may not be exact measurements.

**3 Yaringa Way, City Beach WA 6015**

0 1 2 3

**FINESSE**

Care has been taken to ensure the accuracy of this floor/site plan, however all dimensions and areas should be considered as approximate. It has been produced as a guide for the purpose of the property sale or lease only. No credit is taken for the original building or landscape design. This floor plan/site plan design is subject to strict copyright and should not be reproduced, copied or altered without prior consent. The Agent, Vendor & Finesse Property are not held liable or responsible for any error, omission, misstatement or use of any data shown on this plan.

**Scott Swindler**  
0403344649

scott@shore-property.com.au

Shore Property

**@realty**