



**SOLD**

## MODERN TROPICAL COTTAGE LIFESTYLE

Be ready to walk in and never want to leave as this property screams lifestyle situated in a private tropical oasis. This is an opportunity rare to the market with huge potential and for those buyers that enjoy the finer things in life. This modern cottage style property has 3 spacious bedrooms, one renovated bathroom, polished wooden floors and an outdoor covered entertaining area. Close to Southport State High School, Broadwater, Australia Fair Shopping Centre, Chirn Park and public transport. Don't miss out!

Features include :

Upstairs:

- Master bedroom with walk in robe
- One good sized bedrooms with built in robe
- Renovated spacious bathroom

Downstairs:

- One good sized bedroom with built in robe
- The bedroom is perfect for teenager or home office
- Open plan living spanning onto covered outdoor entertainment area
- Sparkling inground pool surrounded by low maintenance tropical gardens
- Well appointed kitchen with dishwasher and pantry cupboard
- Split system reverse cycle air conditioners living and bedrooms
- Ceiling fans
- Polished timber floors upstairs
- Separate laundry with external access
- Fully fenced property
- Private and quiet position
- Large carport plus off street parking
- Large garden shed
- No strata just shared building insurance
- Inspection is recommended.

For information or to inspect, please contact listing agent.

**3 BED | 1 BATH | 2 CAR**

**PRICE:**  
**\$800,000**

**OPEN FOR INSPECTION:**  
**N/A**



**Anthony Teo**  
**0404124284**

[anthony.teo@atrealty.com.au](mailto:anthony.teo@atrealty.com.au)  
[www.atrealty.com.au](http://www.atrealty.com.au)

↑ NORTH



// FLOOR PLAN  
First Floor



// FLOOR PLAN  
Ground Floor

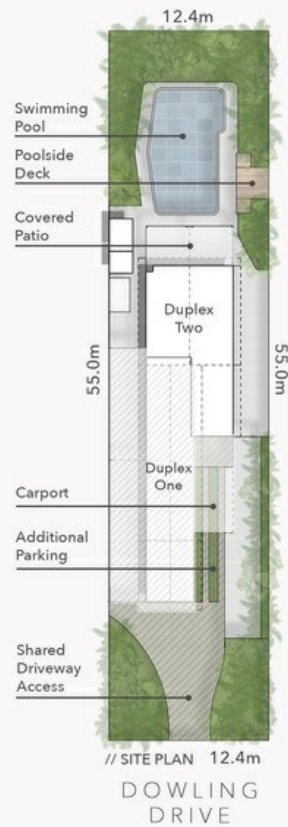

// SITE PLAN 12.4m

DOWLING DRIVE

2/7 Dowling Drive  
SOUTHPORT

- 3 Bed + Study Nook
- 1 Bath
- 1 Car + 1 Off-Street

FLOOR AREA SIZES

Internal 116m<sup>2</sup>  
Covered External Areas 50m<sup>2</sup>  
Total 166m<sup>2</sup> or 18 Squares

The overall presentation style, layout, imagery, fonts, background, colours and terminology are subject to strict copyright of Pure Design Concepts. No ownership is taken for building design. All measurements are approximate & individuals should rely on their own information. Find out more at: [puredesignconcepts.com.au](http://puredesignconcepts.com.au)

**puredesign** CONCEPTS PLANS FOR PURPOSE

Disclaimer: Please note this floor plan is for marketing purposes and is to be used as a guide only. All dimensions are estimates only and may not be exact measurements.