



SOLD

"EXPERIENCE THE ULTIMATE QUEENSLAND LIFESTYLE IN THIS CHARMING 3-BED HOME. DON'T MISS YOUR CHANCE TO MAKE IT YOURS!"

Get ready to make this charming house your own. This property is perfect for a small family or investor looking for a cozy, low-maintenance home.

Nestled in the peaceful town of Gracemere, this house offers a quiet and serene lifestyle. Wake up to the sound of birds chirping and the gentle breeze rustling through the trees.

As you step inside, you'll be greeted by a warm and inviting atmosphere. The spacious living room is simply perfect for relaxing after a long day. The large windows allow natural light to flood in, creating a bright and airy space.

The kitchen is the heart of every home and this one is no exception. The recently renovated kitchen makes cooking and meal prep a breeze.

The 3 bedrooms are all generously sized, providing plenty of space for everyone to have their own sanctuary. Fall asleep to the peaceful sounds of nature and wake up feeling refreshed and rejuvenated.

The bathroom is modern and sleek, with a large shower and plenty of storage space. Making it easy to get ready for the day or evening ahead.

The real star of this property is the outdoor space. Sitting on a 400 square meter plot of land, there's still plenty of room for kids to run around and play. Host summer barbecues in the back area or create your own vegetable garden, the possibilities are endless.

Conveniently located near schools, parks, and shops, everything you need is just a stone's throw away. And for those who love the outdoors, the Gracemere Reservoir is just a short drive away, perfect for picnics, and scenic walks.

3 BED | 1 BATH | 2 CAR

PRICE:
\$400,000

OPEN FOR INSPECTION:
N/A



Layton Campbell
0415468963

laytoncampbell@atrealty.com.au
www.atrealty.com.au

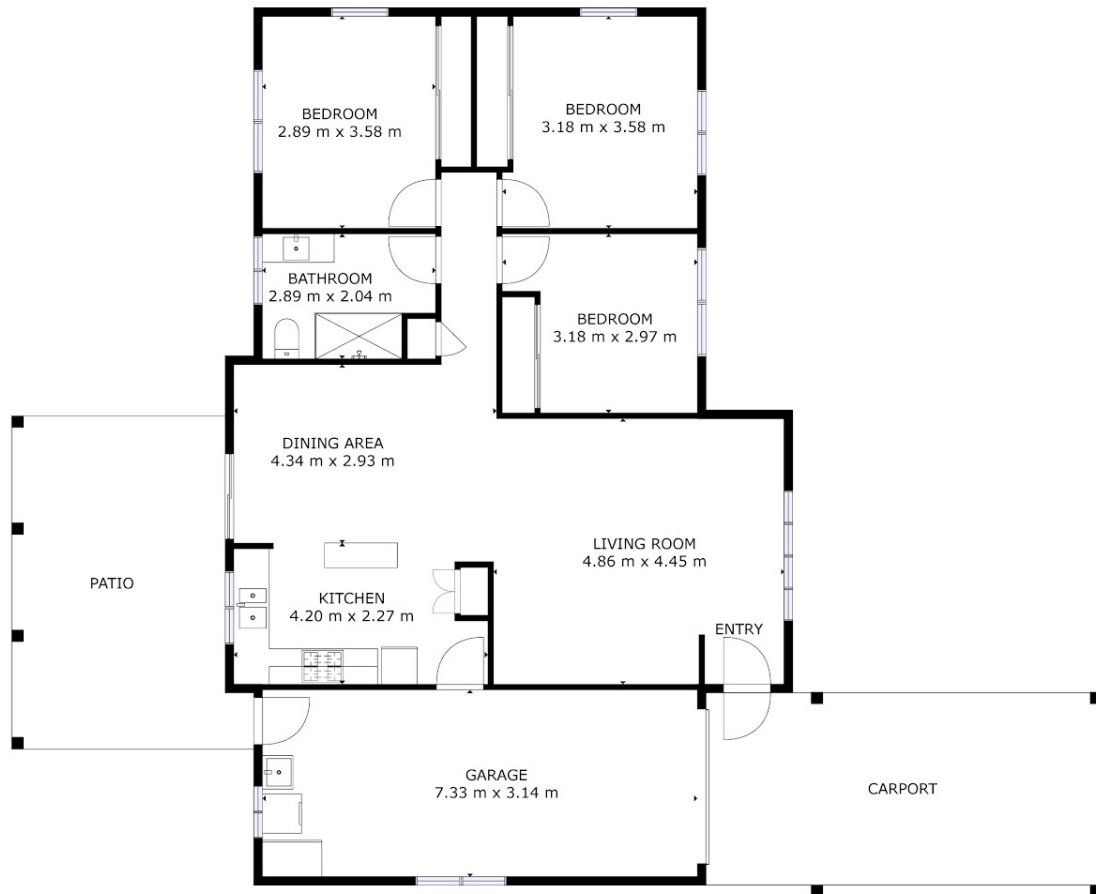

FLOOR 1

GROSS INTERNAL AREA
 EXCLUDED AREAS: GARAGE: 23 m²
 TOTAL: 92 m²
 SIZES AND DIMENSIONS ARE APPROXIMATE, ACTUAL MAY VARY.



Disclaimer: Please note this floor plan is for marketing purposes and is to be used as a guide only. All dimensions are estimates only and may not be exact measurements.