

428/29 COLLEY TERRACE, GLENELG, SA, 5045



SOLD

A RESORT LIFESTYLE IN A SPECTACULAR LOCATION BECKONS

UNDER CONTRACT

Situated in the heart of beautiful Glenelg, this lovely fourth level apartment boasts sweeping views of the marina, parkland and hills. It is sure to appeal to multiple buyer groups including sea-changers, downsizers, investors, the entertainer, interstate/overseas buyers and the busy executive seeking that elusive low maintenance, luxury lifestyle.

Boasting two generous bedrooms, the master with an ensuite and private balcony, a second bathroom services bedroom 2 and your guests. This fabulous apartment sets itself apart from its contemporaries with some surprising features.

The oversize and open plan living/dining area is sure to appeal but the enormous balcony offering stunning 180 degree views over the park, marina and hills is a real jaw dropper. The perfect spot to host those cocktail parties and plenty of room for that luxury spa. A modern two bedroom apartment with such generous living space complimented by a spectacular outdoor area in Glenelg is a rare find and simply adds to this unique value proposition.

Other features include:

- * Modern kitchen with stone bench top, quality appliances, water filter and garbage disposal
- * Two generous bedrooms, the master with private balcony access
- * Two bathrooms, the master with bath, shower, vanity and WC, bathroom two with shower, vanity and WC
- * Euro style laundry
- * Reverse cycle air-conditioning system
- * Security intercom to the apartment/building
- * Lift access
- * 2 car park accommodation (side by side)
- * Access to resort amenities including gym and swimming pool

The marina and parklands are literally across the road and a short stroll takes you to the famous Jetty Road precinct with its buzzing bars and restaurants and one of the most stunning beaches that South Australia has to offer.

2 BED | 2 BATH | 2 CAR

PRICE:
\$1,175,000

OPEN FOR INSPECTION:
N/A



Gerry & Kathy McGuinness
0410531305
teammac@atrealty.com.au
www.atrealty.com.au
RLA: 269823

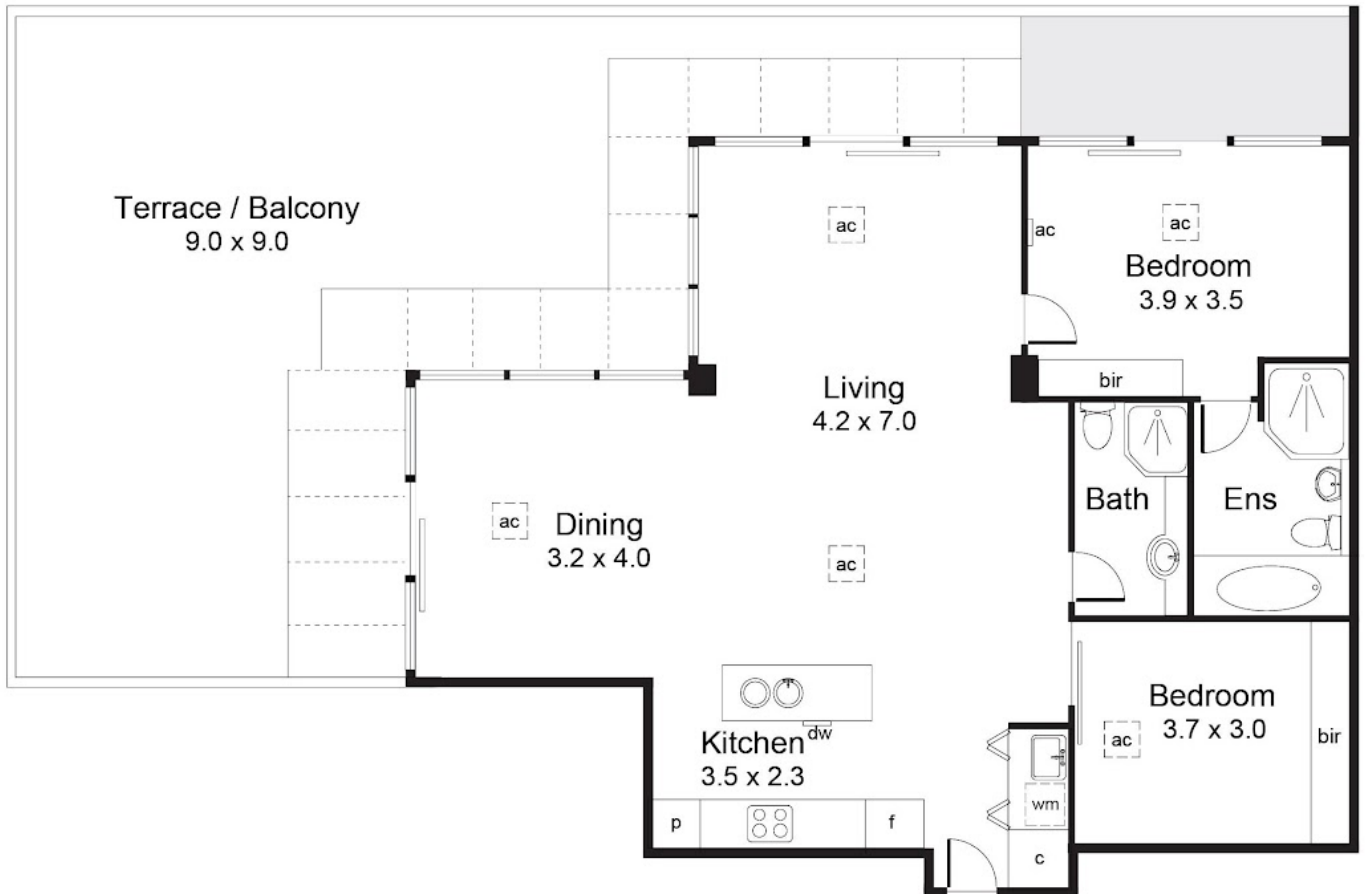

Area (Estimate only)	
Living	104.2 m ²

Disclaimer: Please note this floor plan is for marketing purposes and is to be used as a guide only. All dimensions are estimates only and may not be exact measurements.

For illustrative purposes only.
All measurements are approximate