



SOLD

ONE BEDROOM GEM IN MITCHELTONS VIBRANT BLACKWOOD STREET

Nestled amidst beautifully landscaped surroundings, you'll find yourself spoiled for choice with an array of charming cafes, restaurants, bars, and excellent transport options right at your doorstep. Say goodbye to long walks—the train station is just a stone's throw away, providing a direct route into the bustling CBD. It's easy to see why residents adore this inclusive and vibrant pocket of Mitchelton.

If you're looking for even more variety, you can go to Brookside Shopping Centre, a mere 10-minute walk from your front door.

Features Include -

- One spacious bedroom with built-in robe
- Accessible features throughout
- Open plan kitchen and lounge area with split system air-conditioner
- Secure parking and entry
- Lift for easy access

Medical centre, dentist, and other essential services nearby, Jan Power Farmers Markets on 1st Sunday of the month and there's ample visitor parking available on-site to accommodate your guests. This prime location offers easy access to the CBD and surrounding areas, making it ideal for those working in the city or beyond.

* Current Lease in place \$425 expires 20th January 2025

* Body Corp approx \$117.55 per week

* Rates approx \$1923.80 pa

Disclaimer: The information provided has been obtained in good faith and is to be used as a guide only. @realty nor the acting agent/s provide any guarantees, undertakings, or warnings as to the accuracy, completeness, or up-to-date nature of the information provided by the Vendor or other Persons. We urge all interested parties to undertake their own due diligence independently in determining whether or not this information is in fact accurate. The website may have filtered the property into a price bracket for website functionality purposes.

1 BED | 1 BATH | 1 CAR

PRICE:
\$410,000

OPEN FOR INSPECTION:
N/A



Gregg Hewitt
0413442229
gregg@atrealty.com.au
Gregg Hewitt

Total approx floor area 50m²

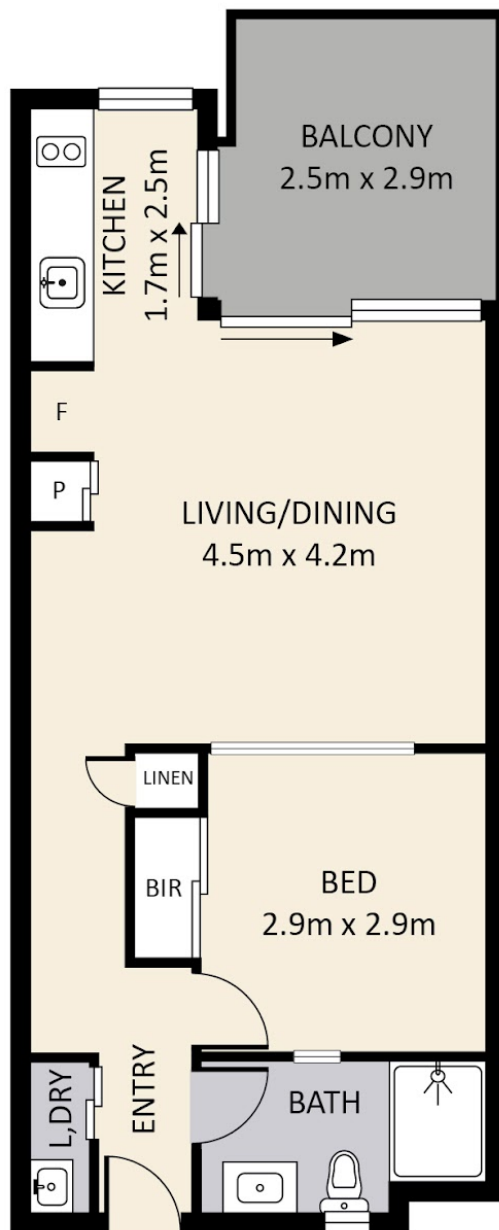
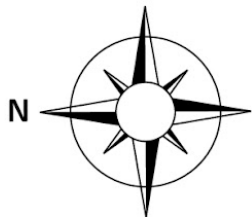

Disclaimer: Floor plan measurements are approximate and for illustrative purposes only.

Disclaimer: Please note this floor plan is for marketing purposes and is to be used as a guide only. All dimensions are estimates only and may not be exact measurements.