



**SOLD**

**AUCTION THIS SATURDAY ONSITE 11:30AM**

Soto Realty, is proudly presenting another unique opportunity to acquire this original double story brick veneer four bedroom home with swimming pool. Situated in a highly desirable neighbourhood for the growing family delivering space and convenience in a central location of Bossley Park. The prime location offers easy access to all amenities, public schools, public transport, parks, shopping centres, churches, and Marconi Club, all within short distance.

**PROPERTY FEATURES:**

- \* Four spacious bedrooms with built-ins, the main w/en-suite
- \* Spacious lounge room with cosy fire place
- \* Combined dining and kitchen
- \* Two bathrooms, 3 toilets
- \* External laundry
- \* Double lock up garage separate from the house
- \* Gorgeous swimming pool with lovely rear deck
- \* Ducted Air
- \* Massive Land size 798sqm (approx)
- \* Solar Panel System

THE VENDORS ARE FULLY COMMITTED TO SELL AND ALL OFFERS WILL BE CONSIDERED PRIOR TO AUCTION!!

AUCTION ON-SITE: 13/04/2024 @ 1:30pm

AGENTS: Saul Soto 0402 948 807  
BJ Gregory 0422 333 333

@realty Pty Ltd, believe that all information provided/contained herein be true and correct to the best of our ability and in no way misleading. Purchasers however are all advised to carry out their own enquiries and relevant searches.

**4 BED | 2 BATH | 4 CAR**

**PRICE:**  
\$1,360,000

**OPEN FOR INSPECTION:**  
N/A



**Saul Soto**  
**0402948807**  
saul.soto@atrealty.com.au  
[www.atrealty.com.au](http://www.atrealty.com.au)

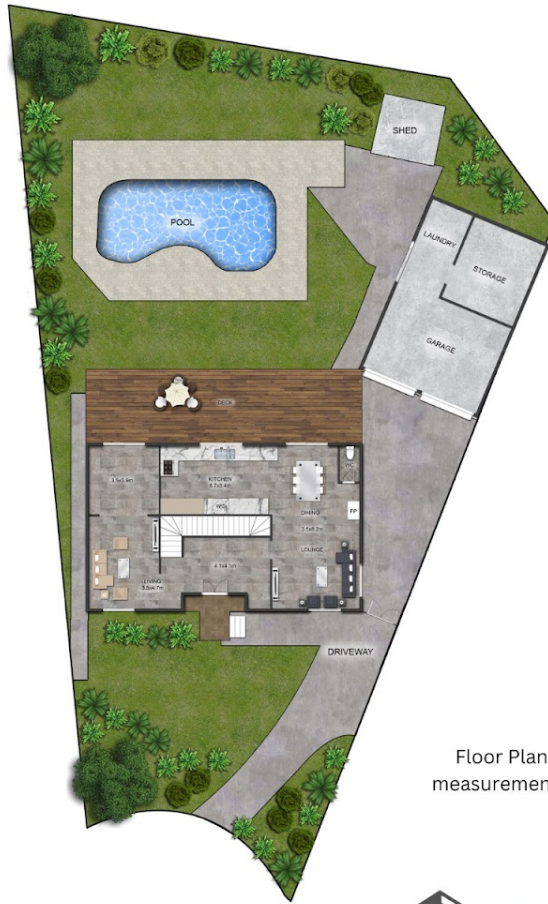

FIRST FLOOR PLAN

Floor Plan supplied for marketing purposes only and all measurements should be verified during physical inspection



**SOTO REALTY**  
REAL ESTATE AGENCY



Disclaimer: Please note this floor plan is for marketing purposes and is to be used as a guide only. All dimensions are estimates only and may not be exact measurements.