

28 DILKARA WAY, CITY BEACH, WA, 6015

shore
PROPERTY

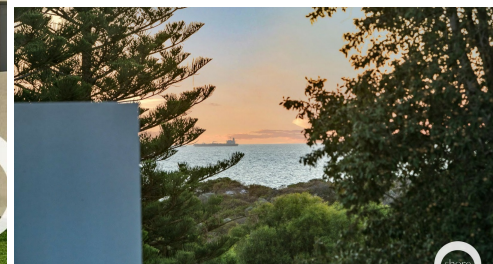

SOLD

CHIC CONTEMPORARY ARCHITECTURAL HOME ON LIFESTYLE SIZE LOT

Chic Contemporary Architectural Home On Lifestyle Size Lot
North Facing Onto Park in Highly Sought After Parks District
Two Doors Up from The Beach

Modern and contemporary design combined with abundant natural light, solar passive design and flowing interiors awaken your senses with their freshness as you enter this invigorating seaside home.

Featuring 4 bedrooms and 3 bathrooms this home is big on lifestyle and convenience, but low on maintenance. A striking architectural home for those with style, whether you are a family or looking for a modern downsizer in City Beach.

A guest suite, or a second master on the ground floor enables you to live entirely on one level, should you ever feel the need.

The ground floor features a big open plan living area, kitchen/ scullery/ meals/ lounge opening onto north facing sun drenched rear gardens with gate access, through to only one of three green ribbons of parkland in the suburb that meander from the eastern end of the suburb all the way down to the beachfront in the highly sought-after Parks District.

Upstairs the master with large ensuite featuring soaking tub and heated floors is a parent's haven. Ocean views down to Carnac Island from the front bedroom is one of the other two generous sized bedrooms. A rear balcony overlooking the backyard and park to the beach.

The home also features CCTV system, 21 solar panel system and "MyPlace" fully ducted reverse cycle air conditioning both with app control.

This tightly held pocket will soon be home to the redeveloped Ocean Village shopping precinct in the other, which promises to give you the most gourmet cafes, bars, yoga studios, gourmet grocers and more in City Beach in as little as few short years.

Adjoining 20 acres of parkland, which flows to the beach and the sand dunes your new home will

4 BED | 3 BATH | 2 CAR

PRICE:
\$2,850,000

OPEN FOR INSPECTION:
N/A



Scott Swingler
0403344649
scott@shore-property.com.au
Shore Property



Ground Floor

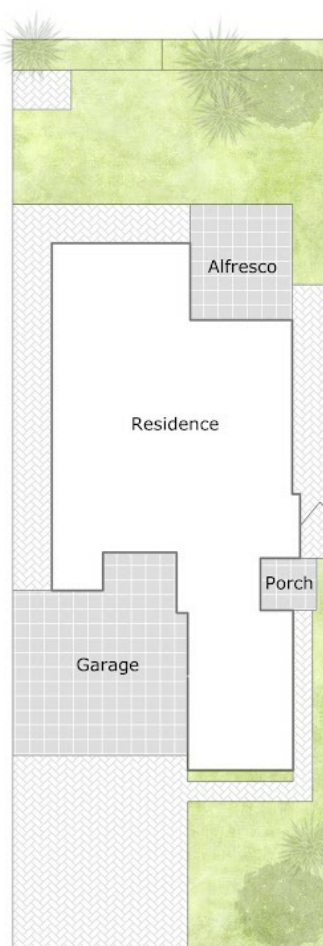

Approximate Areas:

Ground Floor	142 m ²
First Floor	115 m ²
Alfresco	21 m ²
Balcony	11 m ²
Garage	44 m ²
Porch	4 m ²

Total 337 m²



First Floor

Disclaimer: Please note this floor plan is for marketing purposes and is to be used as a guide only. All dimensions are estimates only and may not be exact measurements.

28 Dilkara Way, City Beach WA 6015



FINESSE

Care has been taken to ensure the accuracy of this floor/site plan, however all dimensions and areas should be considered as approximate. It has been produced as a guide for the purpose of the property sale or lease only. No credit is taken for the original building or landscape design. This floor plan/site plan design is subject to strict copyright and should not be reproduced, copied or altered without prior consent. The Agent, Vendor & Finesse Property Pty Ltd shall be held liable or responsible for any error, omission, misstatement or use of any data shown on this plan.

Scott Swingle
0403344649

scott@shore-property.com.au
Shore Property

