



SOLD

COASTAL HAMPTON INSPIRED LUXURY LIVING

Welcome to your brand-new architectural haven in the heart of Paradise Point, a leisurely stroll from the iconic Broadwater beaches. This Hampton inspired 4-bedroom residence combines both sophistication and barefoot luxury....structured and together yet relaxed. Celebrating the quintessential coastal lifestyle— perfectly blended with modern luxury.

A statement 1.2mtr pivot entry door, flanked by secure 4 car parking, and a breathtaking visual through the centre of the home out to the huge pool and entertaining area. This custom design home maximises natural light and airflow, with generous living zones, floor to ceiling windows throughout and oversized sliding doors seamlessly connect the indoors to the outdoor pool and alfresco entertaining area.

Set alongside the 7.7 x 3.5mtr pool you can find shade under the gorgeous hardwood Pool Cabana fitted with custom made cabinetry, a gas cooktop, commercial drinks fridge and undermount sink. Looks like entertaining is on you! A perfect space for creating memories with family and friends.

You will love the spaciousness this home provides. A vast floorplan includes multiple living areas where everyone can spread out.

A huge central open plan lounge, dining and kitchen area, is the hub of the home. With high ceilings, coastal inspired hues, openness and natural light providing a sense of calm, and a "never want to leave" vibe.

Wow, this kitchen is stunning!!! Including an enormous caesarstone island bench, looking grand at 40mm thick with a waterfall edge. Shaker doors and cupboards throughout, superbly done. You'll feel included whilst you're busy in the kitchen, as it really is the heart of the home. Even a kitchen-hand would get excited in here! Don't just take my word for it, you have to see this to truly appreciate it. Including a statement piece - 900mm SMEG gas oven, an endless amount of cupboard and drawer space, including both sides of the island bench. This entire area is encapsulated by glass, creating a resort like feel overlooking the pool and entertaining area.

,A generous media room set to the west-also overlooking the pool, and another Multi purpose space up the other end of the home.... a perfect separate zone for young kids or teenagers. Custom made cabinetry in this area provides perfect nooks for displaying and cupboards for storing and organising. No shortage of storage space in this home. A very cool bonus for the kids.... an attic play area above the multipurpose kids lounge room,

4 BED | 3 BATH | 4 CAR

PRICE:
\$1,900,000

OPEN FOR INSPECTION:
N/A



Michelle Cook
0400262226
michellec@atrealty.com.au
www.atrealty.com.au

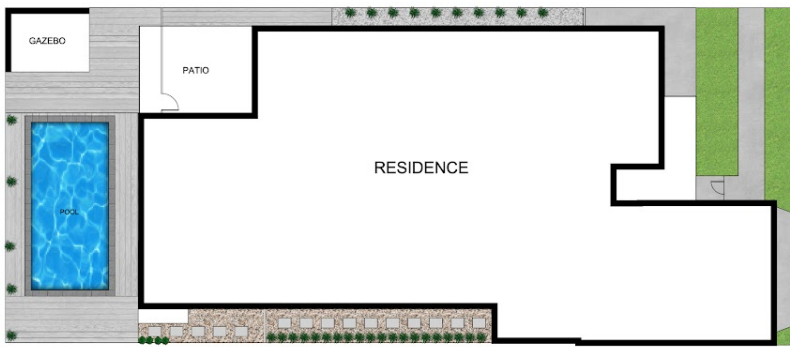

21 Swallow Avenue,
Paradise Point

- 4
- 3
- 4

Internal	:	218 m ²
External Area	:	184 m ²
Garage Area	:	35 m ²
Total Floor Area	:	437 m ²
Total Land Area	:	506 m ²

Michelle Cook
0400 262 226

Indicative plan only. All information contained herein is obtained from sources we believe to be accurate. We cannot guarantee it's accuracy. Interested persons should make and rely on their own enquiries.

Disclaimer: Please note this floor plan is for marketing purposes and is to be used as a guide only. All dimensions are estimates only and may not be exact measurements.

