



**SOLD**

**SOLD - BY STEVE OAKLEY - 0436019085**

First home or investment - This one ticks all the boxes!

This is the perfect place to start your property journey, whether you're a first home buyer or an astute investor. The potential here is endless!

Key features:

Blank canvas: This property is waiting for your personal touch. Make it your own!

3 bedrooms: Plenty of space for a growing family or comfortable living.

Air-conditioned comfort: Enjoy cool breezes all year round in the lounge room.

Side access and secure parking: Drive through with ease to your lock up garage with remote access.

The workshop and extra storage: Perfect for the hobbyist, tradie or anyone who needs some extra space.

Entertainer's delight: The entertainment area is ideal for hosting friends and family for BBQs and gatherings.

Ultra-convenient location: Just a 5-minute walk to the station and primary school.

Education and shopping at your fingertips: Close proximity to a variety of public and private schools and major shopping centres means everything you need is close by.

Generous block size: The deep level block of approximately 556sqm offers ample space for a backyard, pool (subject to council approval) or additional landscaping - the choice is yours!

Quiet street: Enjoy the peace and tranquility of a quiet location.

This property is truly a rare find. Don't miss out on this incredible opportunity! Contact the agent today to arrange an inspection.

**3 BED | 1 BATH | 1 CAR**

**PRICE:**  
**\$862,000**

**OPEN FOR INSPECTION:**  
**N/A**



**Steve Oakley**  
**0436019085**  
soakley@atrealty.com.au  
[www.atrealty.com.au](http://www.atrealty.com.au)

# 24 Mountview Avenue, Doonside



**SITE PLAN**

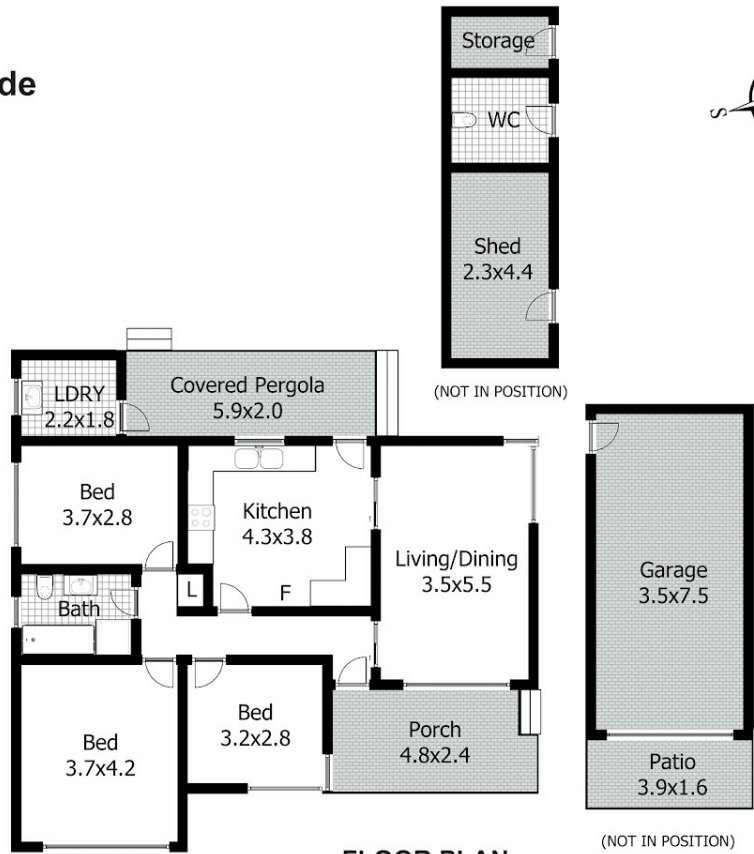

**FLOOR PLAN**

**DISCLAIMER:**

This floor plan is used for marketing purpose only and is subject to errors and inaccuracy. The marketing Agent & N2 Media will not accept any liability. Interested parties should make and rely on their own enquiries.

Disclaimer: Please note this floor plan is for marketing purposes and is to be used as a guide only. All dimensions are estimates only and may not be exact measurements.