



FOR SALE

MULTI-PURPOSE INDUSTRIAL SHED. GREAT LOCATION!!!

Looking for the next chapter to grow your existing business, or the investor looking for a Commercial Investment.

Well, this property certainly could cater for wide range of uses.

Currently used as a mechanic workshop, the current owner is looking to slow down, leaving the opportunity for the new owner to expand their business.

Ideally suited to a verity of business in the building industry such as plumbers/ electrician/ builders/ or retail and workshop, or keep as a mechanic workshop, the ideas are endless.

Located at the end of Wilson Street just off of Mount Gambier's Commercial Street, this location is prime and make the distance of travel for any business, perfect to the CBD.

The premise has great frontage to the street with customer parking at the front of the building, plus heaps of area for company vehicle access to the side of the building on this level 2027 sq/m allotment. The building is of solid construction with high clearance, and easy access roller doors.

There is large storage and workshop areas with three phase power.

Through the front entrance you will find an offices staff lunchroom facility, bathrooms plus front section ideal for more offices or retail showroom.

Inspection recommended.

RLA 269823

0 BED | 0 BATH | 0 CAR

PRICE:

\$750,000 Plus GST

OPEN FOR INSPECTION:

N/A



Peter Dempsey

0418854393

peterdempsey@atrealty.com.au

peterdempseyatrealty.com

RLA: 269823

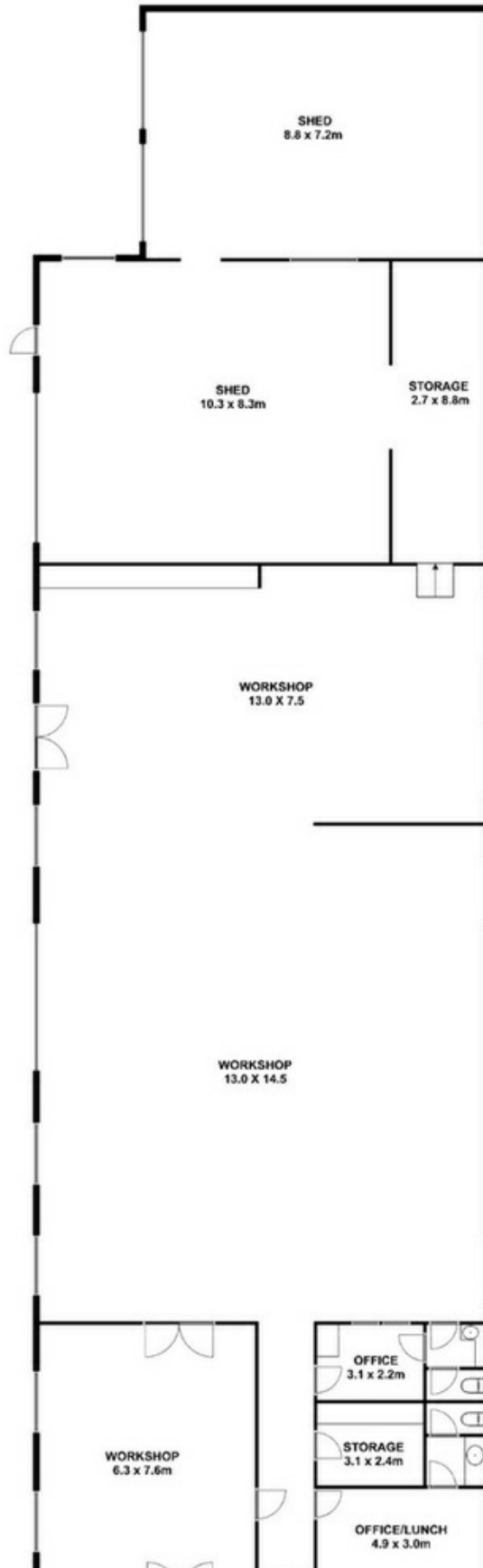

Disclaimer: Please note this floor plan is for marketing purposes and is to be used as a guide only. All dimensions are estimates only and may not be exact measurements.

Internal : 604.4 SQ.M

Total Area : 604.4 SQ.M

This drawing is for illustration purpose only. All measurements are approximately and information intended to be relied upon should be independently verified.