

**SOLD**

## FRENCH PROVINCIAL CHARM

Discover tranquillity and elegance in this captivating three-bedroom, two-bathroom townhouse nestled in the highly coveted suburb of Reedy Creek. Embracing French provincial charm, the kitchen exudes sophistication and seamlessly transitions into the inviting dining/lounge area, leading to an exquisite back deck that offers breath taking views of expansive open spaces.

Situated in the highly sought after Paradise Heights complex on Bridgman Drive, this residence boasts unparalleled convenience with easy access to the Coast and the M1, ideal for commuters. Enjoy the convenience of proximity to premier schools and shopping destinations, all within walking distance or a short drive away.

The complex boasts 2 swimming pools, play grounds for the kids, tennis court, and low body corporate fee of just \$77.00 per week.

An inspection is strongly recommended to fully appreciate the serenity and refined ambiance of this location and property. Don't miss the opportunity to make this enchanting abode yours.

Call today!

**3 BED | 2 BATH | 1 CAR**

**PRICE:**  
**\$825,000**

**OPEN FOR INSPECTION:**  
**N/A**



**Margie McIntosh**  
**0419673550**  
margie@atrealty.com.au  
[www.atrealty.com.au](http://www.atrealty.com.au)

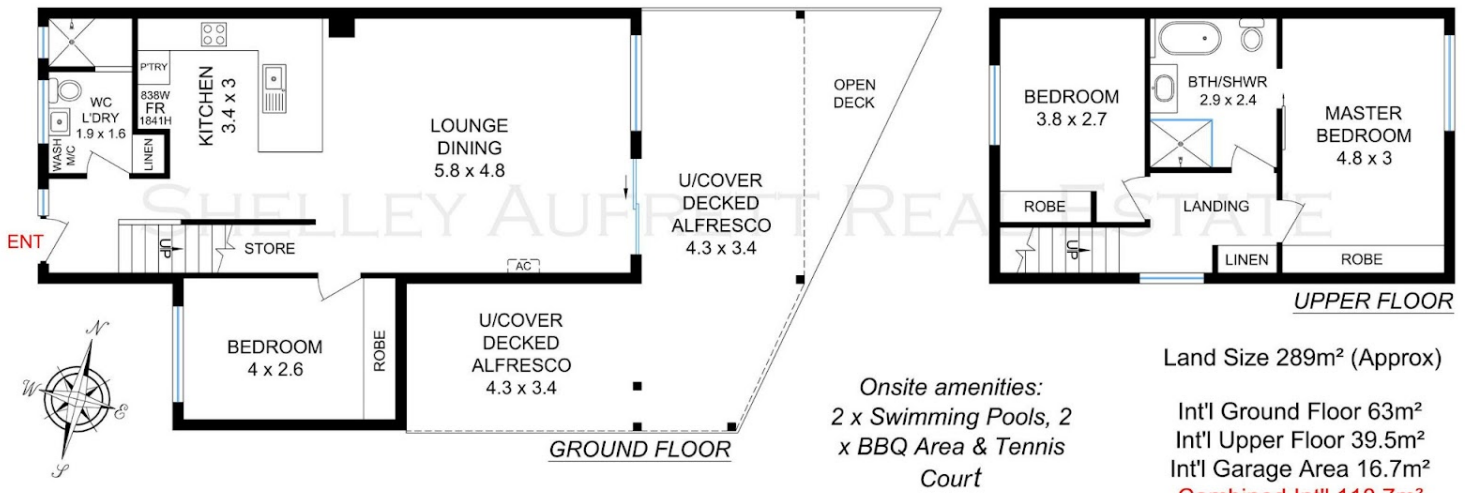

Land Size 289m<sup>2</sup> (Approx)

Int'l Ground Floor 63m<sup>2</sup>  
 Int'l Upper Floor 39.5m<sup>2</sup>  
 Int'l Garage Area 16.7m<sup>2</sup>  
**Combined Int'l 118.7m<sup>2</sup>  
 or 12.7sqs**

Decked Alfresco 41.6m<sup>2</sup>  
**Total Floor Area 160.3m<sup>2</sup>  
 or 17.3sqs**

*'Paradise Heights'*  
 45/15 BRIDGMAN DRIVE,  
 REEDY CREEK 4227

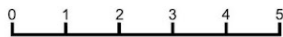
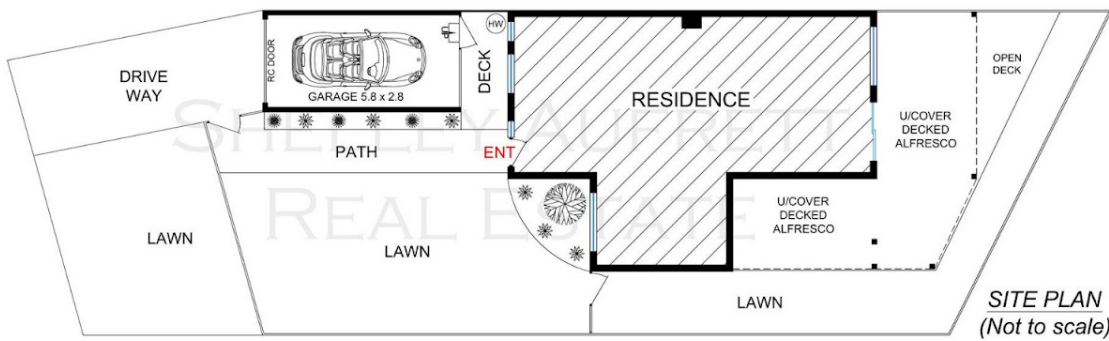

*Gold Coast Floor Plans* 0435 252505 Scale in Meters, Dimensions are approximate, Whilst every care has been made we cannot guarantee its 100% accuracy and interested persons should rely on their own enquiries

Disclaimer: Please note this floor plan is for marketing purposes and is to be used as a guide only. All dimensions are estimates only and may not be exact measurements.