

5 FALMOUTH AVENUE, CITY BEACH, WA, 6015

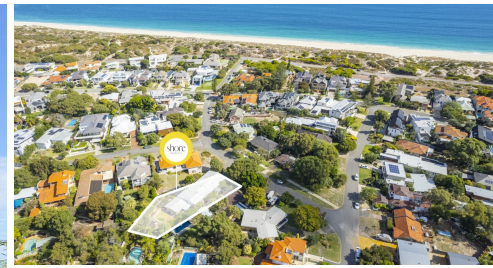

SOLD

LARGE RENOVATED 1960'S ARCHITECTURAL HOME | 1/4 ACRE LANDHOLDING | FOOTSTEPS TO BEACH

Large Renovated 1960's Architectural Home
1/4 Acre Landholding
Footsteps to Beach

Take your pick of beach tracks at the end of Falmouth or Dartmouth Avenue – South City's two most sought after, whisper quiet family streets - and enjoy a different swim location every morning.

This huge mid-century home has undergone a chic contemporary renovation whilst retaining its just-too-cool period integrity. A builders own home, it is seriously over engineered and enjoys soaring ceilings and excellent floorplan separation.

Mid century homes are renowned for being a touch smaller than we generally expect a home to be for contemporary living standards. This home is definitely the exception to the rule! Consider these stats:

- Five Bedrooms
- Study
- Four bathrooms
- Three Living spaces
- Sunroom
- Double lock up garage
- Under cover alfresco living
- 976 sqm landholding

Additionally it has the potential for ocean views if you build up at the front part of the property. It has a direct walking route to two of our shortest beach tracks. Falmouth Avenue is the closest South City location to the highly sought after Groyne and Cafe Precinct where you can have a large landholding.

5 BED | 4 BATH | 2 CAR

PRICE:
\$3,000,000

OPEN FOR INSPECTION:
N/A



Scott Swingler
0403344649
scott@shore-property.com.au
Shore Property

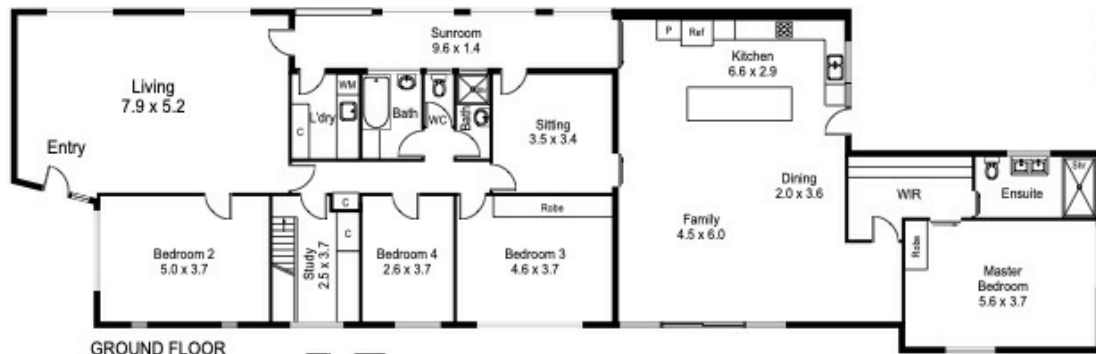

GROUND FLOOR



UNDERCROFT



SITE PLAN

Approximate Areas :

Ground Floor :	275m ²
Undercroft :	82m ²
Alfresco :	30m ²
Terrace :	17m ²
Porch :	5m ²
Total :	409m²

This floor plan including furniture, fixture measurements and dimensions are approximate and for illustrative purposes only. Finesse Property Photography gives no guarantee, warranty or representation as to the accuracy and layout. All enquiries must be directed to the agent, vendor or party representing this floor plan.

5 Falmouth Avenue, City Beach

Disclaimer: Please note this floor plan is for marketing purposes and is to be used as a guide only. All dimensions are estimates only and may not be exact measurements.