



# SOLD

## GRAND COUNTRY LIVING.

This stunning replica colonial home is perfectly set on a selectively cleared 2.5-acre block, providing the ideal lifestyle property for a large family. The custom designed home seamlessly ties together timeless features like polished cypress floors and high ceilings with the modern conveniences of ducted air conditioning, multiple living areas, security screens and alarm system.

Features of the home include:

- Open plan Kitchen, Family and dining room.
- Huge country kitchen with quality stainless steel appliances, gas cooktop, rangehood, electric wall oven, double sink, walk in pantry, breakfast bar, ample cupboard space and stunning polished timber benchtops.
- Separate formal lounge with glass sliding doors to the covered entertainers' deck.
- Large media/rumpus or games room.
- King sized master bedroom with walk in robe and classically styled ensuite with pedestal basin.
- 4 additional bedrooms all large enough for queen sized beds, and all with built in robes.
- Family friendly main bathroom with separate toilet.
- Large laundry with storage cupboards running the length of one wall.
- Reni gas hot water.
- High ceilings, multizone ducted air conditioning.
- Polished cypress floors.
- Security screens throughout.
- Integrated speakers play music from the media room to all living areas and the entertainers deck.
- Spacious covered rear verandah with views over the dam, and natural bushland at the rear of the block.

Outside the features continue with:

- 2 car drive through carport.
- 7x9m shed with 2 car spaces and a lined air-conditioned office with power and phone lines
- Potential for dual living with a second shed offering a car space, workshop, lined office or bedroom space and fully functional bathroom.

5 BED | 3 BATH | 5 CAR

PRICE:  
\$745,000

OPEN FOR INSPECTION:  
N/A



**Nicole Polley**  
0450578811  
polley@atrealty.com.au  
[www.atrealty.com.au](http://www.atrealty.com.au)



Floor Plan

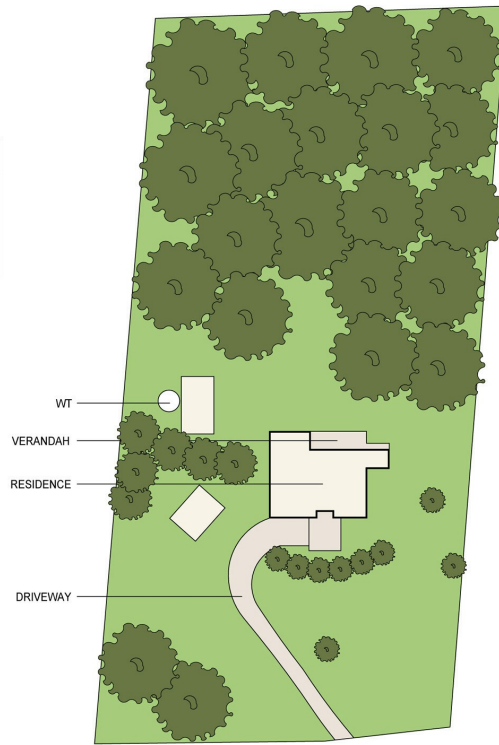

Site Plan

17 MARVELLE CLOSE



SCALE UNIT IS IN METRES

All measurements are approximate and for illustration purposes only. It should not be considered 100% accurate. Interested parties should rely on their own enquiries.



Disclaimer: Please note this floor plan is for marketing purposes and is to be used as a guide only. All dimensions are estimates only and may not be exact measurements.