

SOLD

LARGE GROUND-FLOOR APARTMENT, PERFECTLY POSITIONED!

This spacious one-bedroom ground-floor apartment is located in a boutique block. It features open-plan living, abundant natural light, and a sense of space.

The apartment boasts a modern kitchen with a stainless steel oven and a new induction cooktop. The large and spacious bedroom has double windows and built-in robes, providing ample storage. The bathroom is bright and spacious, with a shower, separate bath, laundry tub, washing machine and dryer space. There's abundant storage throughout the apartment, including overhead and under-bench cupboards. The hot water system has been recently updated, and the electrics have been upgraded.

Puckle Street in Moonee Ponds is a lively area with various restaurants, cafes, and shops in its retail precinct. Moonee Ponds Central, new cinemas, the train station, and numerous other public transport options are readily accessible on foot. Other points of interest are Queens Park, Moonee Valley Racecourse, Highpoint, and the Maribyrnong River, which are nearby.

This is an excellent opportunity for savvy investors, as the property is rented for \$430 per week or first-home buyers looking to enter the Moonee Ponds market on the ground floor.

1 BED | 1 BATH | 0 CAR

PRICE:
\$430,000

OPEN FOR INSPECTION:
N/A



Leigh Chant
0418100082
leighchant@atrealty.com.au
innermelbournere.com.au

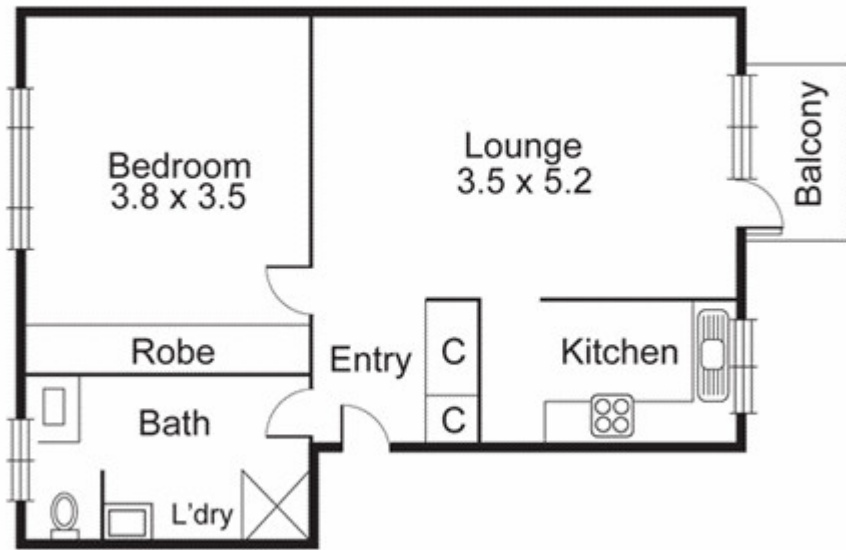

Disclaimer: Please note this floor plan is for marketing purposes and is to be used as a guide only. All dimensions are estimates only and may not be exact measurements.