



SOLD

PRICE DROPPED- FANTASTIC INVESTMENT WITH 6.4%+ POTENTIAL RENTAL RETURN

Secure the ultimate in inner-city living with this incredible 1 bedroom apartment in the exclusive Metropol complex.

Be impressed by the stunning architecture, rooftop gardens, and the impressive shared residents penthouse, featuring an infinity edge pool, gourmet kitchen and entertainment facilities, ideally positioned to entertain friends in style.

Step into the open plan living and dining space with engineered timber flooring throughout, adjacent to the top-of-the-line kitchen with an induction cooktop, stone benchtops and SMEG appliances. Doors from the living area open to your own private balcony – perfect for entertaining and impressing guests.

Ducted heating and cooling keep temperatures comfortable in the large master bedroom, which features a built-in wardrobe and sliding doors to the balcony. The sleek floor-to-ceiling tiled bathroom sits opposite a hidden euro-style laundry. Additional benefits of this deluxe complex include a secure underground parking space, a bike hub, a car wash and an in-house concierge service.

Positioned close to the Canberra Centre and Glebe Park, you're surrounded by incredible restaurants, cafés and bars with the Canberra CBD at your doorstep. Take advantage of the bus and light rail lines, walking trails, bicycle paths and more, with Canberra Airport just a 12-minute drive away.

Features

- 50sqm living + 8sqm balcony
- Ducted heating & cooling
- Double-glazed windows
- Central inner-city position
- Open plan living/dining & modern kitchen
- Modern kitchen with stone benchtops & smeg appliances
- Elegant "Midas" colour scheme throughout
- Sweeping sunset views towards Glebe Park from private 7th floor balcony

1 BED | 1 BATH | 1 CAR

PRICE:
\$405,000

OPEN FOR INSPECTION:
N/A



Sarah Cooper
0478847993

sarah@thepropertyagents.com.au
thepropertyagents.com.au

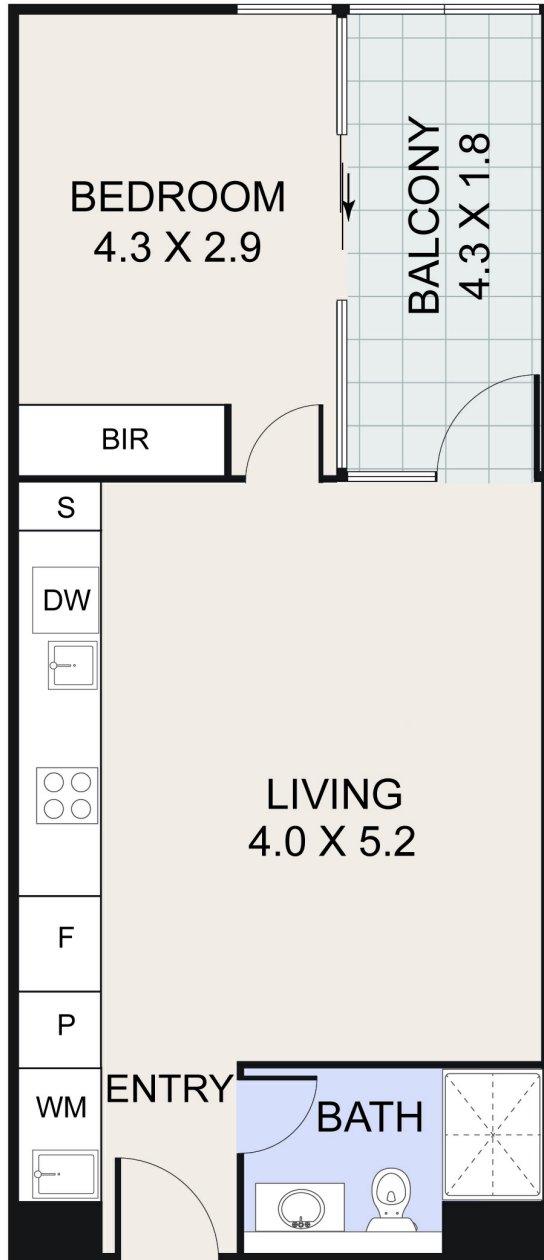

Disclaimer: Please note this floor plan is for marketing purposes and is to be used as a guide only. All dimensions are estimates only and may not be exact measurements.