



SOLD

SOLD BY ETHAN MCCANN

Welcome to 30 Gerara Court, a one-of-a-kind paradise tucked away in the serene location of Clagiraba. Perfectly situated approximately 10 minutes from the M1 on nearly 8 acres (3.15Ha) of flat usable land, 30 Gerara Court is a bespoke lifestyle property like no other. Boasting grand 4-meter-high ceilings, this meticulously designed four-bedroom residence has something for the whole family to enjoy.

If a home with recreational activities is a priority for you and your family, then search no more. You're guaranteed to have an unforgettable experience with your very own horse arena and paddocks, providing endless opportunities for equestrian pursuits and outdoor enjoyment. Whether you're refining your riding skills in the arena or exploring the scenic trails surrounding the property, the estate offers a tranquil escape for horse enthusiasts of all levels. Additionally, the kids are sure to be impressed with your half basketball court, providing boundless fun and fitness right at your doorstep.

Accommodate your vehicles with ease thanks to the properties extensive garaging and parking options. Store your prized possessions in the four-car garage, providing ample space for vehicles, equipment, and recreational toys. Additionally, the four-car carport offers conveniently covered parking for guests, as well as the height to accommodate storage of boats, caravans, trailers and floats - ensuring that every aspect of your luxury lifestyle is catered to with style and functionality.

From the moment you step inside the home, you'll be greeted with a flawlessly executed design and unique finishes like no other. From the grand master suite boasting a large walk-in robe and ensuite, to the stunning living spaces featuring an electric fireplace and an additional three bedrooms, every detail exudes opulence.

Culinary enthusiasts will be delighted with a large gourmet kitchen complete with luxurious micro-cement Venetian plaster bench tops and splashbacks as well as premium appliances including a deluxe integrated Liebherr fridge, two Bosch ovens and a Blanco induction cooktop. Better yet, discover the convenience of a butler's pantry including a filtered Zip Tap for chilled or sparkling water.

With expansive wrap around balconies that embrace the main house, it goes without saying that this property is an entertainer's dream. Immerse yourself in breathtaking views of the hinterland

4 BED | 2 BATH | 8 CAR

PRICE:
\$2,280,000

OPEN FOR INSPECTION:
N/A



Ethan McCann
0481454400

ethan.mccann@atrealty.com.au
mccannperkinsrealestate.com.au

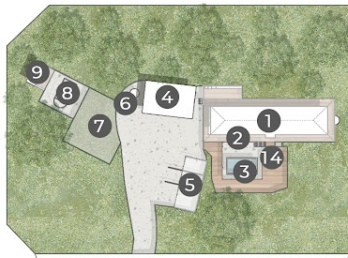

← NORTH :: CROPPED SITE PLAN

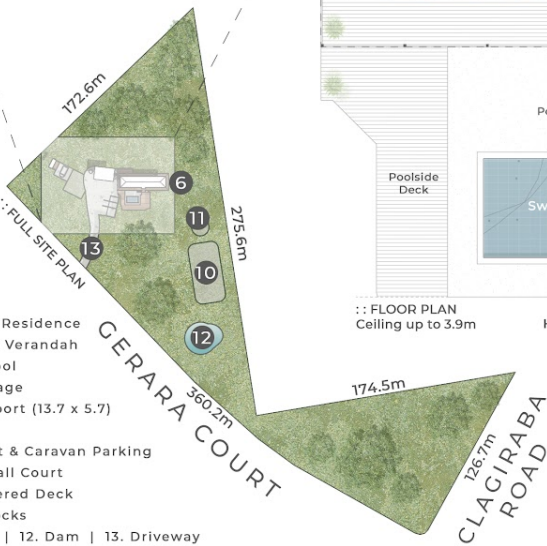

:: FULL SITE PLAN

LEGEND

1. Single Storey Residence
2. Wrap-Around Verandah
3. Swimming Pool
4. Four Car Garage
5. Four Car Carport (13.7 x 5.7)
6. Water Tanks
7. Parking Court & Caravan Parking
8. Half Basketball Court
9. Studio & Covered Deck
10. Horse Paddocks
11. Horse Arena | 12. Dam | 13. Driveway
14. Access to Underhouse Storage

30 Gerara Court CLAGIRABA

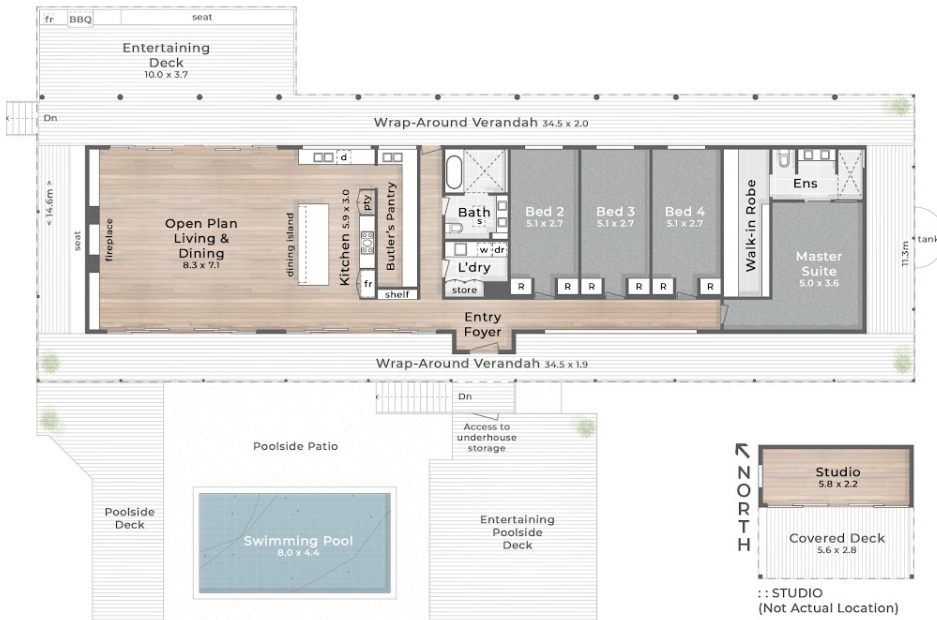

:: FLOOR PLAN
Ceiling up to 3.9m

HINTERLAND VIEWS



↑ NORTH

:: STUDIO
(Not Actual Location)



:: GARAGE
(Not Actual Location)

3.15 Hectares or 7.78 Acres | 4 Bed + Studio | 2 Bath | 8+ Car

Internal 230m² | Studio & Deck 32m² | Deck & Verandah 196m² | Garage & Carports 212m²
Total 670m²



Ethan McCann 0481 454 400

This is not a legal document therefore all measurements and information provided is subject to survey. No permission is given to use or alter this Floor Plan without the consent of Pure Design Concepts. The overall presentation style, layout, imagery, fonts, background, colours and terminology has been originally created by PDC and is subject to strict copyright. No ownership is taken of building design. Find out more at puredesignconcepts.com.au



Disclaimer: Please note this floor plan is for marketing purposes and is to be used as a guide only. All dimensions are estimates only and may not be exact measurements.

Ethan McCann
0481454400
ethan.mccann@atrealty.com.au
mccannperkinsrealestate.com.au

