



SOLD

QUALITY LIVING AT ITS FINEST!

With an immaculate presentation from front to back and on a great sized 511sqm2 (approx.) allotment, this stunning home is sure to impress the fussiest of buyers. Located in a highly desirable pocket of Wyndham Vale, the property that you have been waiting for has finally arrived. Comprising of three spacious bedrooms all with built in robes and a central bathroom which compliments all bedrooms. A spectacular kitchen which includes quality stainless steel appliances, dishwasher, ample cupboard and bench space, all overlooking the spacious meals/family area. Outside shows off amazing spaces for family gathering and entertaining. To top things off heaps of off street parking, enormous garage/workshop just perfect for an abundance of storage, the tinkerer or tradesman! Added extras include split system cooling & heating, downlights throughout and so much more. All of this and extra is situated walking distance to Iramoo Primary School, Wyndham Vale Primary School, public transport, gorgeous parklands and much more! Avoid disappointment and inspect this standout property today!

3 BED | 1 BATH | 4 CAR

PRICE:
\$506,000

OPEN FOR INSPECTION:
N/A



Joseph Hanna
0423966320
joseph@atrealty.com.au
www.atrealty.com.au

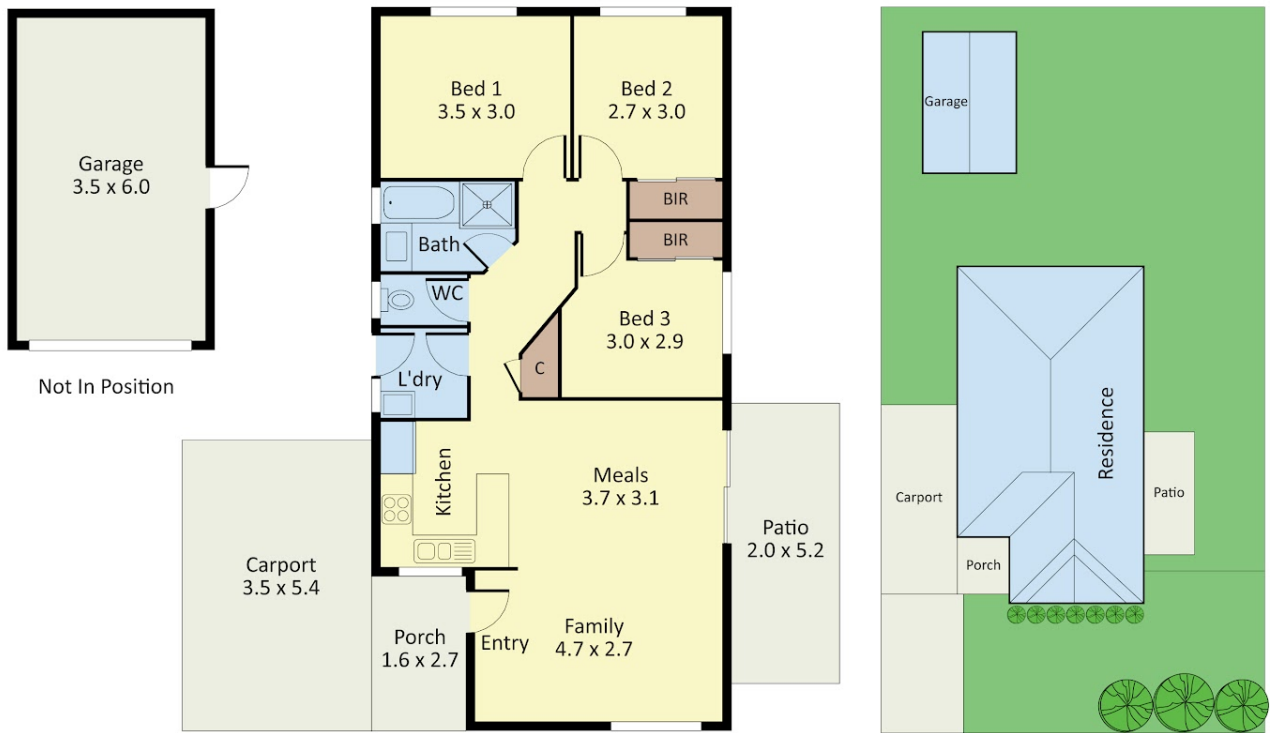

14 Rosedale Place, Wyndham Vale

Dimensions are approximate and for illustrative purposes only



Disclaimer: Please note this floor plan is for marketing purposes and is to be used as a guide only. All dimensions are estimates only and may not be exact measurements.