

**SOLD**

## STUNNING & SPACIOUS FAMILY HOME - HUGE VALUE!

Experience the allure of luxurious living and entertainment in a highly sought-after location, boasting state-of-the-art coastal living. This exquisite family residence exudes high-end style, creating a serene coastal vibe mere moments from Corinella's Foreshore & Walking Tracks and a stone's throw away from Fig & The Bay, where you can savour your morning coffee. Just over 6 years old, this spacious two-story home boasts a free-flowing layout that offers a high level of flexibility for contemporary living. The main floor plan provides glamorous indoor/outdoor entertaining opportunities through triple stacker doors, revealing a stunning layout throughout the home.

This home exudes an immediate "wow" factor as you step inside, leaving you eager to explore further. From the impressive 2340 high and 1200 wide Hume clear glazed front entry door to the pivot door frame and hydraulic door closer, the entrance is truly magnificent. Among the standout features of this property are the 4 generously-sized bedrooms, with the master bedroom boasting a balcony perfect for soaking in the early morning sunrises and a luxurious Ensuite. The residence features a stunning kitchen as the focal point of the home, complete with a 900mm Induction stainless steel upright cooker, Stone benchtops, Glass window splash back, butler's pantry, open plan family living area, study area, 2 bathrooms, and a powder room to service the downstairs. The garage has been expanded to include a roller door with backyard access. This home boasts numerous enhancements not typically found in a standard build. Corinella is often referred to as Victoria's best kept secret - this is what visitors say about Corinella when they first discover this beautiful seaside town in Country Victoria. The Corinella Peninsula is truly a hidden gem and you will agree when you visit this very special Victorian town just over an hour from Melbourne's outer suburbs.

4 BED | 2 BATH | 2 CAR

PRICE:  
\$800,000

OPEN FOR INSPECTION:  
N/A



**Leo Edwards**  
0472523445  
leo@atrealty.com.au  
[www.atrealty.com.au](http://www.atrealty.com.au)

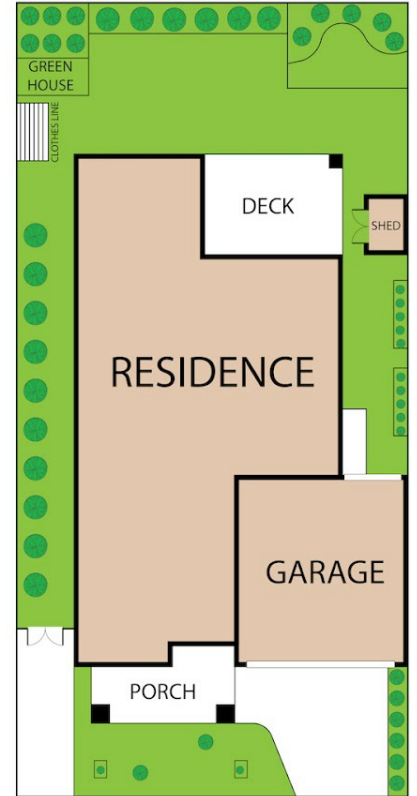
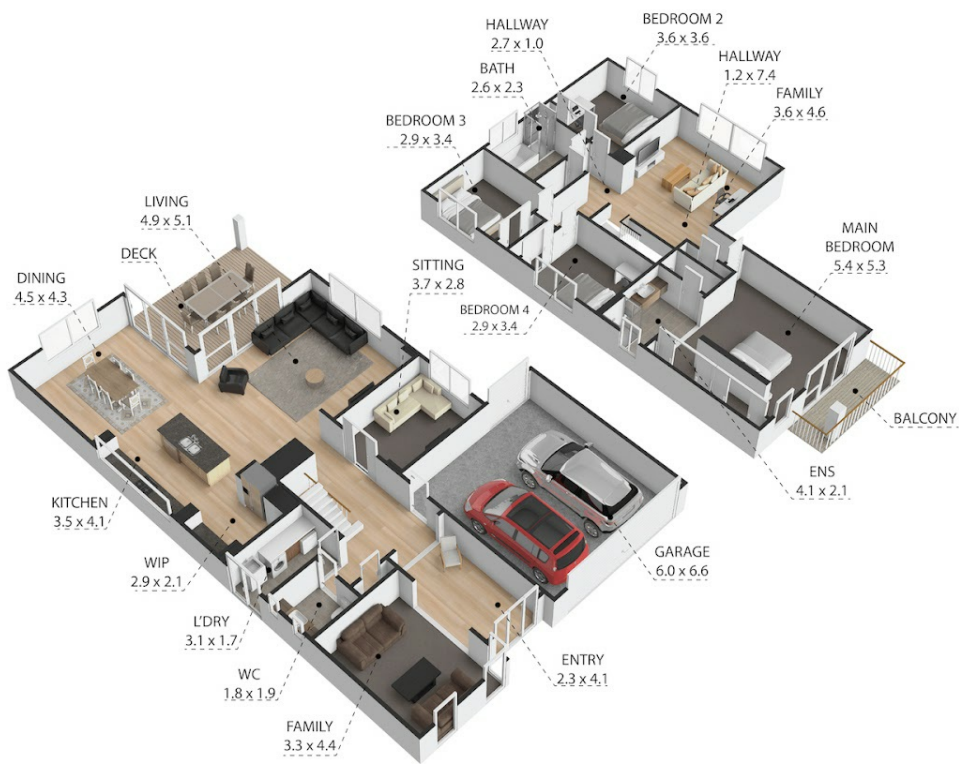

12 Liberty Crescent, Corinella 3984  
TOTAL APPROX. FLOOR AREA 279 SQ.M

Whilst every attempt has been made to ensure the accuracy of the floor plan contained here, measurements of doors, windows, rooms and any other items are approximate and no responsibility is taken for any error, omission, or misstatement. This plan is for illustrative purposes only and should be used as such by any prospective purchaser.



Disclaimer: Please note this floor plan is for marketing purposes and is to be used as a guide only. All dimensions are estimates only and may not be exact measurements.

Leo Edwards  
0472523445  
leo@atrealty.com.au  
www.atrealty.com.au

