

FOR SALE

HIDDEN GEM ON NEARLY 1 ACRE BACKING ONTO THE KOALA RESERVE...

4 BED | 1 BATH | 3 CAR

19 Bade Street, Nambour, QLD, 4560

This is the one you've been wishing for, 17-23 (19) Bade Street, Nambour is privately located on 3240m2 (just under 1 Acre) backing onto the Koala Reserve, nothing but peace and birdsong. You have your own private bitumen road leading up to a 6mt x 9mt colorbond Shed and a quaint 4 Bedroom Home offering north facing Views back to Nambour City just 10 minute walking distance away.

- 4 Bedroom, 1 Bathroom hidden Gem.
- Land 3240m2 (just under 1 Acre)
- Backing onto the Koala Reserve.
- 6mt x 9mt Colorbond Shed
- visit www.VBREALSTATE.com.au to view the floor & site plan plus the video walk through.
- Tenants in the process of vacating early, lease ends early July, 2024, paying \$680.00 per week.
- Minutes to walk to Aldi, Woolworths, Medical, Schools and Shops.
- 15 minute drive to the Hinterland or the best beaches on the Sunshine Coast.
- 5 minute drive to Nambour Hospital and Train Station.

PRICE:

Inviting offers over \$795,000

OPEN FOR INSPECTION:

N/A



Vanessa Brunton

0467 448 850

vanessa@vbrealestate.com.au

www.vbrealestate.com.au

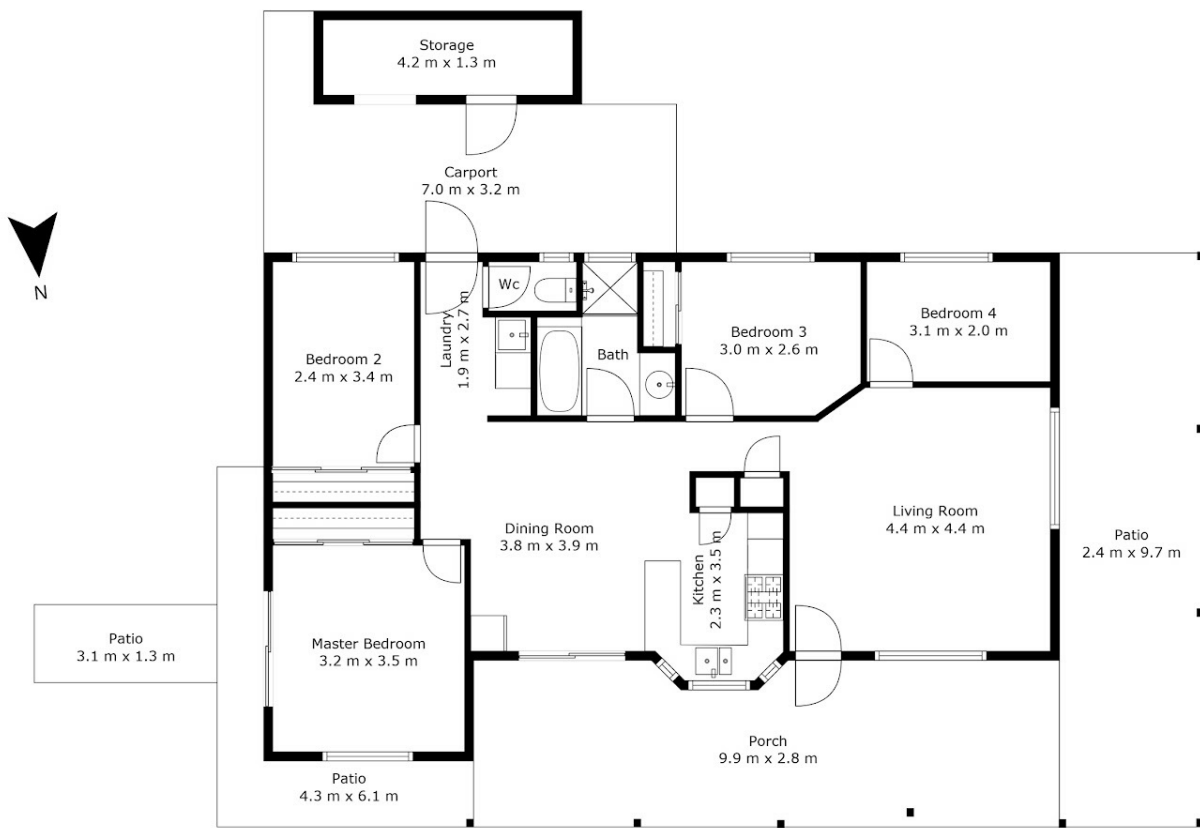

19 Bade Street, Nambour

4 Bed 1 Bath 3 Car



TOTAL: 92 m2

FLOOR 1: 92 m2

EXCLUDED AREAS: PATIO: 36 m2, PORCH: 27 m2, STORAGE: 5 m2,
CARPORT: 19 m2

Measurements Are Calculated By Cubicasa Technology. Deemed Highly Reliable But Not Guaranteed.

Disclaimer: Please note this floor plan is for marketing purposes and is to be used as a guide only. All dimensions are estimates only and may not be exact measurements.

