



**SOLD**

## UNDER OFFER

Located in a peaceful street, this two-bedroom unit offers low-maintenance living and exceptional convenience. Featuring very tidy interiors and positioned close to shops, schools, parkland and transport, it's ideally suited to first home buyers, downsizers and investors alike.

Instantly inviting, the living room upon entry features plush carpet underfoot, through to the spacious meals zone, where sliding doors open up to a private covered alfresco and courtyard under the shade of a leafy tree canopy. Cooking is a breeze in the well-appointed kitchen complete with tiled floors, timber benchtops and a freestanding cooktop and oven, and a dedicated laundry is tucked behind offering easy access to the rear courtyard. Two plush bedrooms include built-in robes and share the central bathroom, with split system heating and cooling and a wall heater in the living zone ensuring comfort year-round.

Further adding to the appeal, a single garage with workshop, in a fantastic location just a short stroll to Ferntree Gully Village and train station, Tim Neville Arboretum and Wattlevue Primary, and easy access to Westfield Knox and the Dandenong Ranges.

- Delightful low-maintenance two-bedroom, one-bathroom unit
- Positioned at the front of a peaceful block of just four
- Inviting open plan living & dining with plush carpet underfoot
- Well-appointed kitchen with timber benchtops & freestanding cooker
- Two generous bedroom include built-in robe storage
- Central bathroom features shower, vanity & separate toilet
- Dedicated laundry with direct access to the rear courtyard
- Glass sliding doors reveal tranquil covered alfresco deck
- Single garage with rear access & workshop bench
- Split system heating & cooling plus gas heater in living
- Bright & inviting contemporary interiors throughout
- Walk to shops, schools, parkland & trains

Thinking of selling now or in the future? For a free-market appraisal call

Luciano Marcuzzi | 0423 181 161 | luciano@atrealty.com.au

**2 BED | 1 BATH | 1 CAR**

**PRICE:**  
\$591,000

**OPEN FOR INSPECTION:**  
N/A



**Luciano Marcuzzi**  
**0423181161**  
Luciano@parkagents.au  
[www.lucianorealty.com.au](http://www.lucianorealty.com.au)

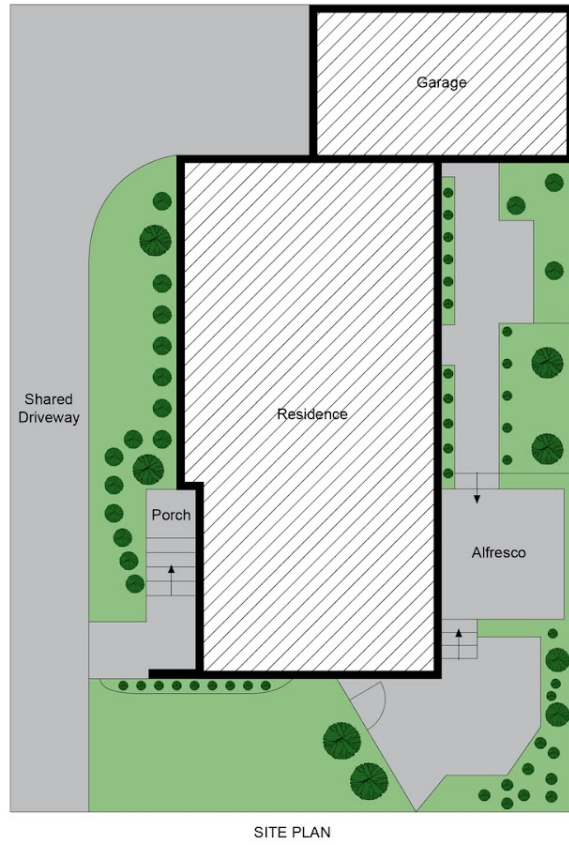

The floor plan is not to scale; measurements are indicative and in metres. Exterior elements are not in position. Plans should not be relied on. Interested parties should make and rely on their own enquiries. The information on this brochure has been supplied to us by the property owner, while we have no cause to doubt its accuracy, we provide no guarantee. We cannot attest to the functionality of any fixtures, fitting or inclusions to the property. Land and apartment dimensions and floor/site plans are supplied by third parties. Typing mistakes, omissions, transposing can occur, we provide to assist but make no representation. Buyers must carry out their own due diligence. Photo ID and contact details are required at all open inspections.

Disclaimer: Please note this floor plan is for marketing purposes and is to be used as a guide only. All dimensions are estimates only and may not be exact measurements.