

# SOLD

## ANOTHER TOWNHOUSE SOLD BY YOGI SHARMA AT A RECORD PRICE!

Discover your dream home or an excellent investment opportunity with High ROI and low body corporate at this newly renovated townhouse; the property's location is ideal, with proximity to public schools, parks, childcare centres, libraries, sports and leisure facilities, public transportation, and shopping centres, making it an excellent choice for families and individuals alike. With freshly painted through, new carpet, and a renovated bathroom, this townhouse offers a serene park view, making it perfect for waking up to.

### Property Highlights:

- Vacant and ready for new owners
- Two generous bedrooms with robes and a walk-in robe
- Ceiling fan in Bedrooms
- Kitchen with electric cooktop and plenty of storage space.
- Freshly painted
- New Carpet
- Renovated bathroom
- Park views from the second bedroom
- Located in a quiet complex with only 10 townhouses
- Single lock-up garage with internal access and extra storage
- Low-maintenance private courtyard
- Spacious open-plan design

### Location Benefits:

- Close to public schools, parks, childcare centres, and libraries
- Nearby sports and leisure facilities, including Logan Entertainment Centre and Logan City Tenpin
- The new Woodridge Station upgrade is in progress, enhancing accessibility, safety, and customer experience for easier travel.
- Convenient access to public transportation, shopping centres, and Pacific and Gateway Motorway
- Just 25 minutes to Brisbane CBD and 50 minutes to the Gold Coast
- Next to Willow Park, with a bus stop on the same street

2 BED | 1 BATH | 1 CAR

PRICE:  
\$458,000

OPEN FOR INSPECTION:  
N/A



**Yogi Sharma**  
**0415558800**

yogi.sharma@atrealty.com.au  
[www.atrealty.com.au](http://www.atrealty.com.au)

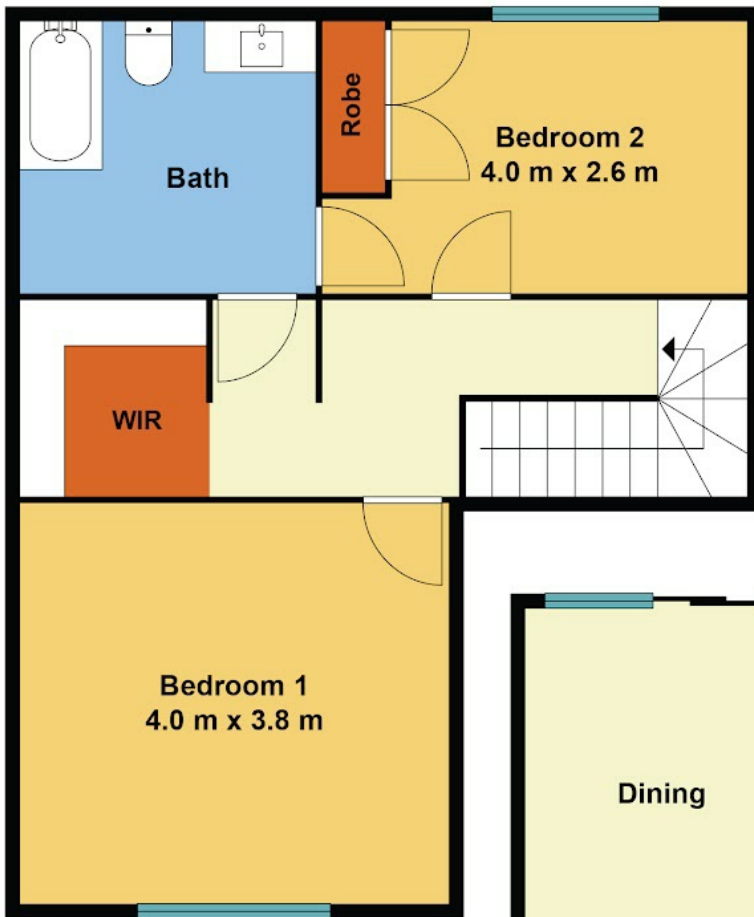

First Floor

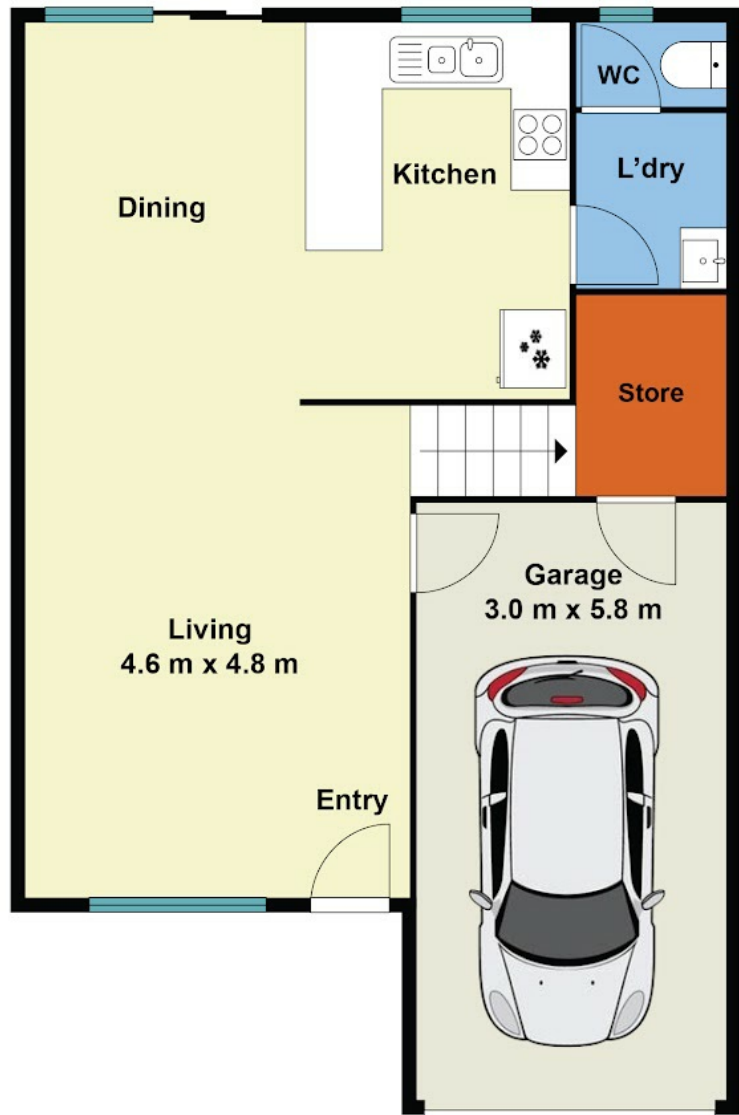

Ground Floor

Disclaimer: Please note this floor plan is for marketing purposes and is to be used as a guide only. All dimensions are estimates only and may not be exact measurements.

## WOODRIDGE, QLD

Measurements are approximate. Not to Scale. illustrative purposes only.

**Yogi Sharma**  
**0415558800**

yogi.sharma@atrealty.com.au  
[www.atrealty.com.au](http://www.atrealty.com.au)

