

FOR SALE

TRANQUIL HIDEWAY LIVING

Welcome to your dream townhouse in the charming suburb of Shailer Park. Step inside this stunning townhouse is the perfect combination of convenience, comfort, and open plan living, as soon as you open the front door you are immediacy captivated by the space and open plan living, the natural light pours in, creating a warm and inviting atmosphere. The living area is the ultimate spot to relax with a coffee looking at the tree views of Kimberley Forest.

This townhouse offers two spacious bedrooms providing plenty of room for a growing family or for guests. Each bedroom is equipped with large windows, allowing for natural light to flood in and create a bright and airy atmosphere. The master bedroom has its own air conditioning and fans for the hot summer days with a large built-in wardrobe. It's the perfect retreat for some much-needed relaxation and privacy.

This townhouse also includes a carpark space and a garage providing convenience and security for your vehicles. You'll never have to worry about finding a parking spot on the street or the safety of your car again. This is just one of the many features that make this property a practical and comfortable choice. Oh yes, we have more with two bathrooms there be no rush in the mornings.

- 2 Bedrooms all with built-ins fans and Master with air-conditioning
- 2 Car space one in the garage one designated spot in the car park
- 2 Bathrooms for the busy mornings
- Space Kitchen with fridge included with dishwasher and gas cooking
- Nice yard for children to play
- Enjoy a morning coffee on the balcony looking at Kimberly Forest
- Low body corporate approximately \$56.31 per week with discount paying on time
- Rates and water are per quarter approximately \$950
- Rental appraisal approximately \$450 to \$470 per week

Located in the desirable suburb of Shailer Park, this townhouse offers a peaceful and quiet neighbourhood while still being close to all amenities. You'll have easy access to public transportation, shopping centres, restaurants, and parks. It's the perfect location for those who want to be close to everything while still enjoying the tranquillity of suburban living. So why not make this your own ultimate tranquil hideaway? This one is not going to last long!

2 BED | 2 BATH | 2 CAR

PRICE:

Expression Of Interest

OPEN FOR INSPECTION:

N/A



Angela Hocking

0481554066

angelahocking@atrealty.com.au

angelahockingrealestate.com.au

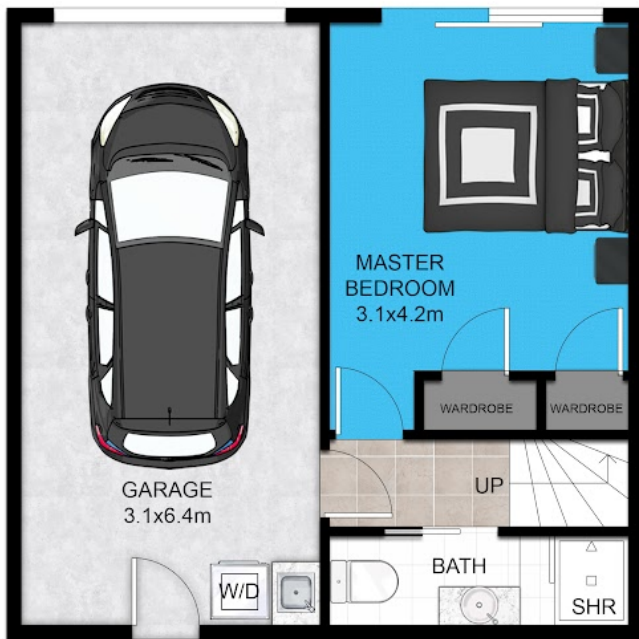

GROUND FLOOR



FIRST FLOOR

Disclaimer: Please note this floor plan is for marketing purposes and is to be used as a guide only. All dimensions are estimates only and may not be exact measurements.

This floor plan including furniture, fixture measurements and dimensions are approximate and for illustrative purposes only.

@Realty gives no guarantee, warranty or representation as to the accuracy and layout.

All enquiries must be directed to the agent, vendor or party representing this floor plan.

Angela Hocking

06/39466 Chatswood Road Shailer Park

angelahocking@atrealty.com.au

angelahockingrealestate.com.au