



# SOLD

## PERFECT NORTH FACING WATER VIEW - 1 BEDROOM ,MODERN FLOOR PLAN, SPACIOUS APARTMENT IN RUNAWAY BAY

This spacious 2nd floor apartment is located within Cove 35 Building Complex in Runaway Bay. An ideal home or investment - a very popular apartment block so be quick with your inspection request.

This modern deco is sure to appeal to many but it is also versatile as it is white paintwork throughout. The present owner had downsized and so he does fit a lot of furniture in this lovely apartment. His presentation is very good and he has created work stations throughout the living room and uses the large north facing balcony for the dining area. You may choose to utilise the space differently.

The kitchen area is galley style and this creative and practical owner has placed some modern stone working tables so that there is ease of preparation areas for the creative chef of the family to create some delicious culinary delights! He has also added a removeable double pantry style cupboard to give more storage.

The bathroom does have a bath and a shower above it - it is compact but there is a separate European style laundry in this apartment - this has a very workable, user friendly floor plan.

A Master bedroom with easy access to both the bathroom and living area - it is a versatile space with options to cater for placement of bedroom suites.

Please note photos will be online by the end of this week.

The first Open House will be held this Saturday 29th June from 1pm - 1.45pm

Body Corporate details will be made available to you when you attend as the Disclosure Statement is on order.

If you would like further information or would like to have n inspection at another time please phone me, Susan, on 0407 285852 and I will gladly arrange a time that suits your busy schedule.

1 BED | 1 BATH | 1 CAR

PRICE:  
\$527,000

OPEN FOR INSPECTION:  
N/A



**Susan Crook**  
**0407285852**

susancrook@atrealty.com.au  
[www.atrealty.com.au](http://www.atrealty.com.au)

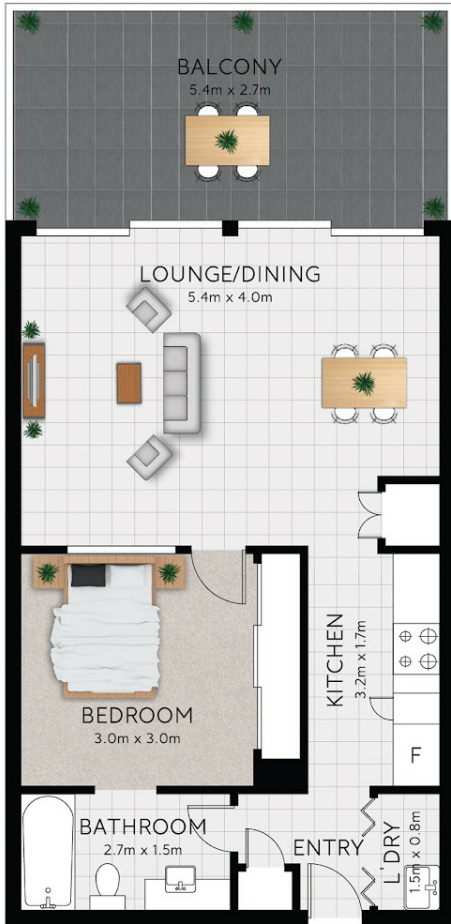

-  1
-  1
-  1

Internal: 50 m<sup>2</sup>  
Covered External: 15 m<sup>2</sup>  
**Total Floor Area: 65 m<sup>2</sup>**

Disclaimer: Please note this floor plan is for marketing purposes and is to be used as a guide only. All dimensions are estimates only and may not be exact measurements.