



FOR SALE

AUCTION THIS SATURDAY 2:30PM

Situated on the high side of a whisper quiet street, this brick veneer residence has been lovingly maintained by the same family for over 50 years and is loaded with potential. High ceilings, spacious bedrooms, enormous living room, eat in kitchen, brick veneer construction and side driveway to lock up garage are just some of the great features of this property.

Boasting an extra wide 16.76m frontage this property presents an ideal opportunity to renovate, extend or redevelop (subject to council approval) and reap the rewards.

HIGHLIGHTS

- Land size 607m2
- Block dimensions 16.76m x 36.424m
- 4 bedrooms
- Bathroom
- Eat in kitchen
- Enormous living area
- Garage
- Gas
- Duplex site (subject to council approval)
- Very well maintained throughout

Council Rates \$525.00 per quarter
Water rates \$171.41 per quarter

4 BED | 1 BATH | 1 CAR

PRICE:
Auction

OPEN FOR INSPECTION:
N/A



Stan Medanic
0439559300
stan@atrealty.com.au
www.atrealty.com.au

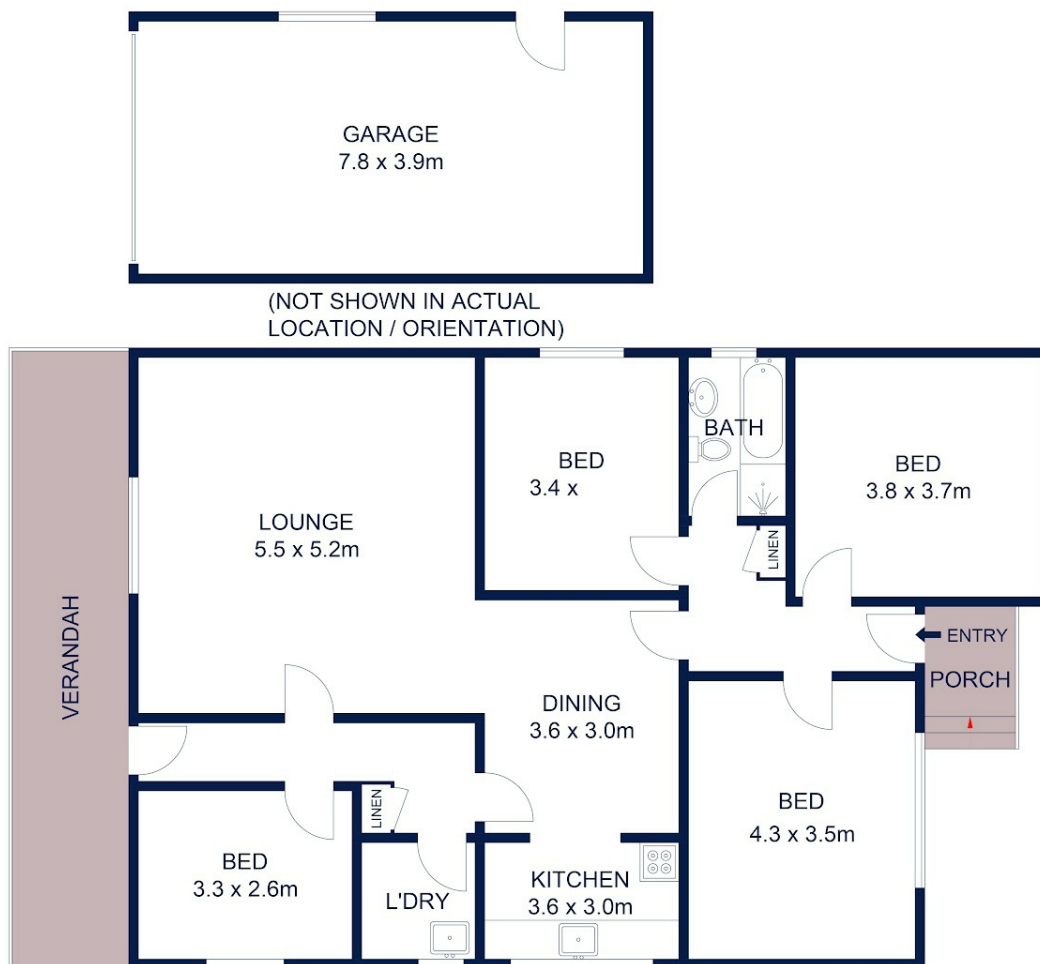

Scale in metres. Indicative only. Dimensions are approximate. All information contained herein is gathered from sources we believe to be reliable. However, we cannot guarantee its accuracy and interested persons should rely on their own enquiries.

13 Carew Street, Padstow

Disclaimer: Please note this floor plan is for marketing purposes and is to be used as a guide only. All dimensions are estimates only and may not be exact measurements.