

FOR LEASE

WELL MAINTAIN TOWN HOUSE IN GREAT LOCATION

This well maintained double-storey townhouse has been designed for low-maintenance living and could offer the charming abode you've been searching for. There are two bedrooms and 1.5 bathrooms/toilet while daily life will surely revolve around the air-conditioned lounge, dining and kitchen. A small backyard is ideal for those with young kids plus there's also an internal laundry, a single garage and a prime location close to everything you could ever need.

- ✓ Enjoy low-maintenance living in this two-bedroom,
- ✓ Open-plan lounge and dining
- ✓ Bright kitchen with 40mm benchtop and Westinghouse appliances.
- ✓ A covered and fenced backyard with outdoor kitchen setup
- ✓ Built-in robes to the main bedroom with floorboard flooring
- ✓ Internal Laundry
- ✓ Second toilet
- ✓ Split system air-conditioning –
- ✓ Single garage with remote control
- ✓ Ample storage
- ✓ Led Lights throughout the house.
- ✓ Garden Shed
- ✓ All windows come with plantation Shutters.
- ✓ External ducted rangehood.

✓✓ No Pets allowed✓✓

Please Call on 02 8075 2525 for more information.

ONLINE enquiry policy –

All email & online enquiries received from this website will not be attended to if contact number & email address are not provided.

To be able to view the property we require you to register. We also encourage you to complete a T-app application prior to viewing.

2 BED | 1 BATH | 2 CAR

PRICE:

Deposit Taken

OPEN FOR INSPECTION:

N/A



Mohammed Nayeem

0450830432

nayeem@propticonnect.com.au

propticonnect.com.au



FIRST FLOOR



GROUND FLOOR

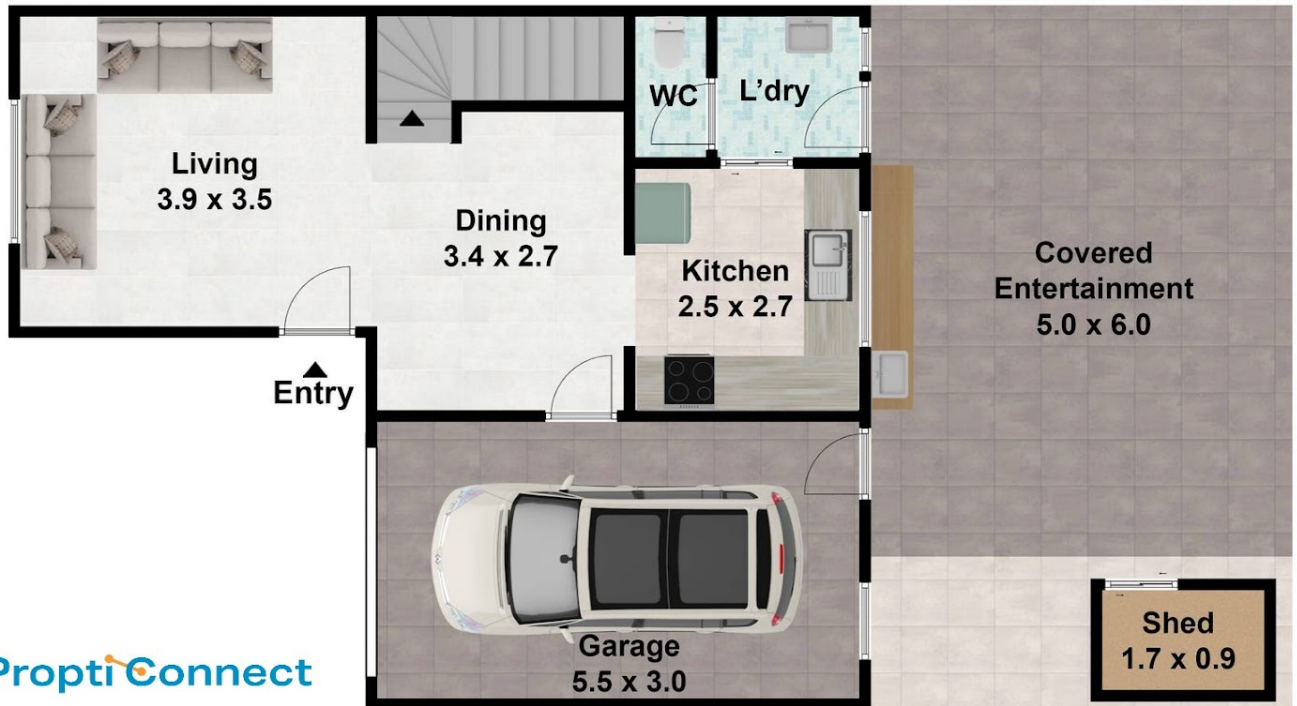

8/5-7 Thelma Street, Lurnea NSW 2170

DISCLAIMER: THIS IS FOR ILLUSTRATIVE PURPOSES ONLY. ALL DIMENSIONS ARE APPROXIMATE AND IT DOES NOT CONSTITUTE PART OF ANY LEGAL DOCUMENT. All dimensions are approximate. Actual dimensions may vary. Floor plan prepared by uploadit.com.au 0401957996

Disclaimer: Please note this floor plan is for marketing purposes and is to be used as a guide only. All dimensions are estimates only and may not be exact measurements.