

**SOLD**

## PRIME UNIT - JUST A STEP TO THE CITY

Are you looking for a prime unit close to everything?! Then this property is for you.

Perfectly situated in Belgian gardens walking distance from the Strand and Rowes Bay this Unit is perfect for fly in/fly out or to make an Air BnB. Just minutes from the city and Townsville Airport this stunning 2 bedroom unit is a must see. 2 good sized bedrooms large open plan living with a stunning kitchen with all the trimmings and all furniture included ready to move straight in or make an Air BnB. Situated on the ground floor with no stairs and garage with entry directly inside the unit it has everything you could want and perfect security. Close to major schools, the strand and beautiful Pallarenda it is perfect for single life, small families or to enter Townsville's incredible investment market. If you are a fly in/fly out miner this could be your ticket to Air Bnb this unit while you're away. This unit will not last long and is a very rare find these days so get in quick!!

**2 BED | 1 BATH | 1 CAR**

**PRICE:**  
\$365,000

**OPEN FOR INSPECTION:**  
N/A



**Ken Entriken**  
**0419689498**  
kenentriken@atrealty.com.au  
[www.atrealty.com.au](http://www.atrealty.com.au)

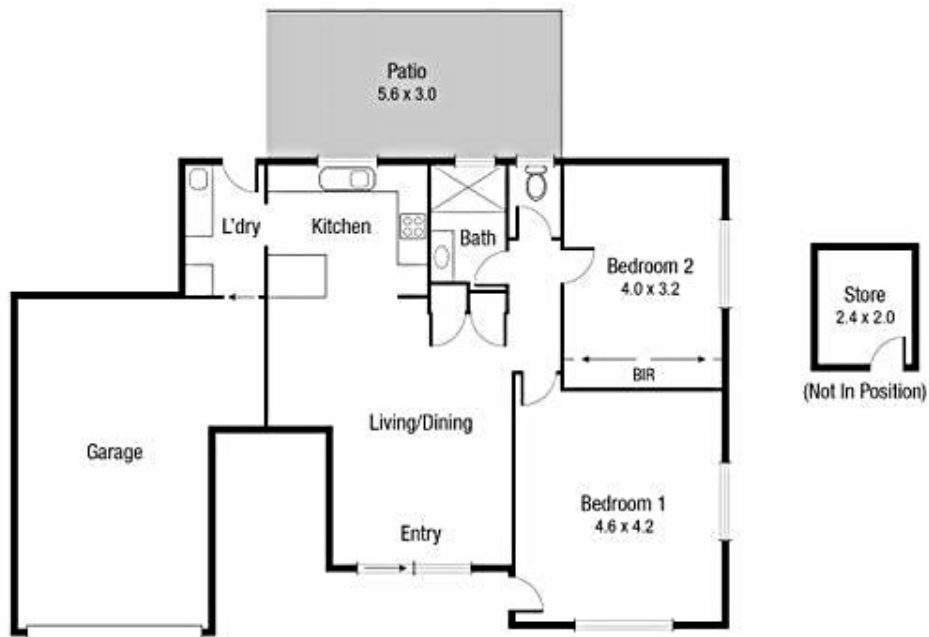

UNIT 1, 14 Marshall Street, Belgian Gardens  
 Approx. 127m<sup>2</sup>

Artist Impression Only

Disclaimer: Please note this floor plan is for marketing purposes and is to be used as a guide only. All dimensions are estimates only and may not be exact measurements.