

24 YALTARA ROAD, CITY BEACH, WA, 6015

shore
PROPERTY

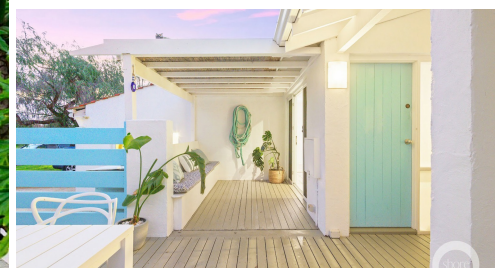

SOLD

MALIBU BEACH PAD | OCEANFRONT CITY BEACH | 439 SQM EASY CARE LOT

MALIBU BEACH PAD
OCEANFRONT CITY BEACH
439 SQM EASY CARE LOT

Shore | Countdown

Absolutely all offers presented by 5pm Wednesday August 14
Seller reserves the right to sell prior. WILL BE SOLD.

This is the rarest of the City Beach rare. A downsize lot is near impossible to find in this beautiful large block suburb of ours. On offer here is a downsize lot that is both street front and Oceanfront in one of the suburbs most sought after streets. Enjoy this cool home as-is or redevelop and build your beach front dream.

Effortless and casual coastal interiors channel Malibu Beach cool in this sunny ocean front beach pad, with 180degree aspect across the City Beach dunes and only footsteps to the beach track and the waters edge.

Lie awake at night to the energizing rumble of the ocean over the sand dunes reverberating through your world and making you feel alive. Enjoy coastal outlook and vivid red Indian Ocean sunsets which keep you in touch daily with all of the beautiful reasons that we live in this wonderful far flung corner of the world.

Immerse yourself in the healing waters along the City Beach shoreline every morning as a part of your habitual routine...you are sure to add another 10 years to your life! Swim multiple times each day if the urge takes you. It is just so easy to fit into your lifestyle when you are living in such a convenient location, nestled in the dunes right on the lands edge...the beach track is literally directly opposite.

The home itself is a charming and delightful seaside cottage. The previous home of both architects and artists, this 1970's original has been retrofitted, renovated and styled both inside and out to become the most light-flooded, free-flowing and inviting of atmospheric homes.

4 BED | 1 BATH | 0 CAR

PRICE:
\$1,850,000

OPEN FOR INSPECTION:
N/A



Scott Swingler
0403344649

scott@shore-property.com.au
Shore Property

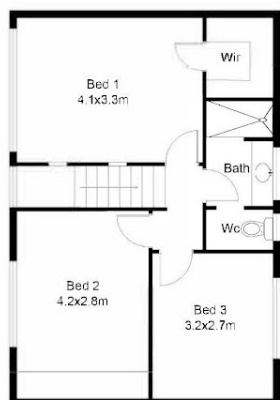

UPPER FLOOR PLAN



GROUND FLOOR PLAN

This floor plan including furniture, fixture measurements and dimensions are approximate and for illustrative purposes only.
Finesse property photography gives no guarantee, warranty or representation as to the accuracy and layout.
All enquiries must be directed to the agent, vendor or party representing this floor plan.

24 Yaltara Road, City Beach

Disclaimer: Please note this floor plan is for marketing purposes and is to be used as a guide only. All dimensions are estimates only and may not be exact measurements.