

147 KELLERMAN DRIVE, ST HELENS PARK, NSW, 2560



**SOLD**

## EXPANSIVE FAMILY HOME

Welcome to 147 Kellerman Dr, St Helens Park, an expansive family home spread over an impressive two storey floorplan with vibrant features that carry you effortlessly from room to room. Boasting four generously proportioned bedrooms with built in robes, the Master suite is serviced by an ensuite equipped with dual basins & walk in robe. The multiple living areas spread across the home will cater to the whole family. The heart of the home is the exquisite kitchen, with ample cupboard and bench space and complimented by quality appliances will impress any cooking enthusiast. The bright and airy bathroom is equipped with a bathtub and a third toilet is conveniently located downstairs. The entertaining alfresco overlooks the low maintenance backyard and is equipped with a garden shed. A double garage with remote access, internal & backyard access will accommodate your cars perfectly.

Extra Features Include:

- Air Conditioning
- Linen storage
- Side access

St Helens Park is a family friendly suburb your family will thrive in. Located within close proximity to local schools, shops & transport as well as sporting facilities and child friendly parks & reserves. This home is one to put at the top of your inspection list.

Agency Central believes that all the information contained herein is true & correct to the best of our ability however we encourage all interested parties to carry out their own enquiries.

**4 BED | 2 BATH | 2 CAR**

**PRICE:**  
**\$1,130,000**

**OPEN FOR INSPECTION:**  
**N/A**



**Huss Al Salemi**  
**0411699419**  
huss@atrealty.com.au  
[www.agencycentral.com.au](http://www.agencycentral.com.au)

SHED

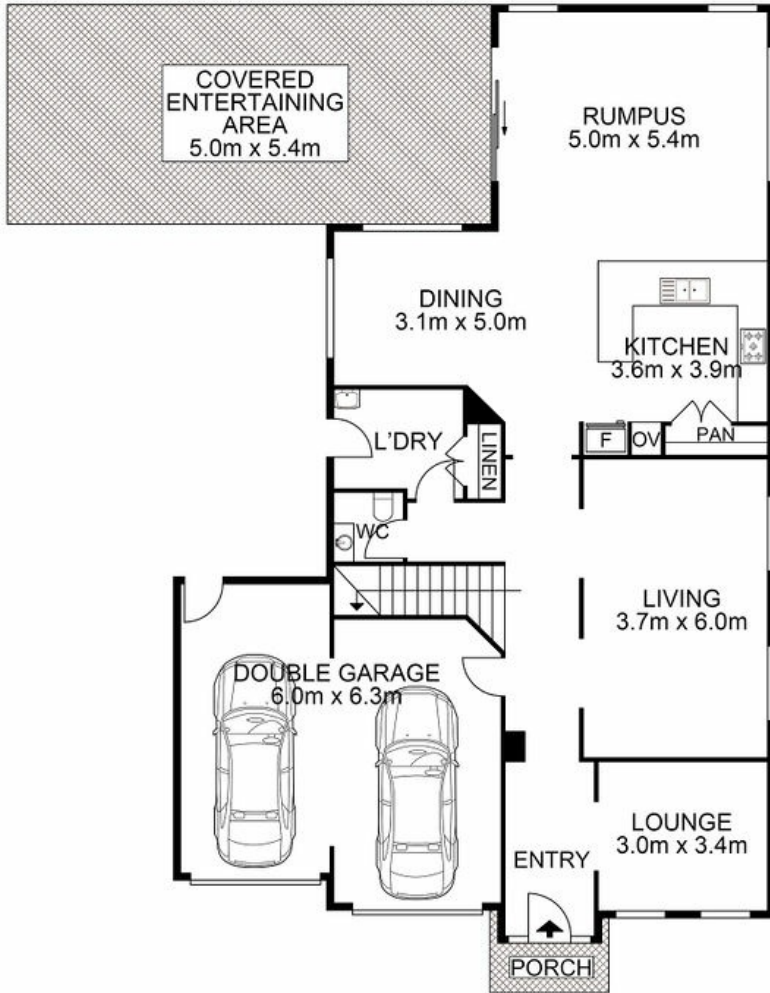

ENTRY LEVEL

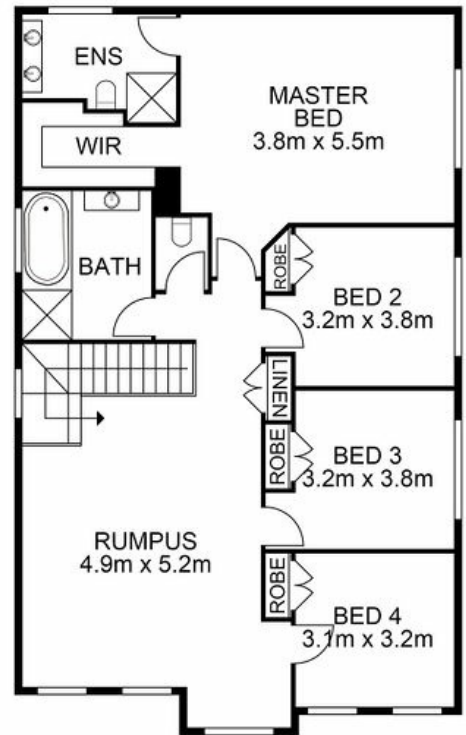

UPPER LEVEL

AGENCY

Disclaimer: Please note this floor plan is for marketing purposes and is to be used as a guide only. All dimensions are estimates only and may not be exact measurements.

147 Kellerman Drive, Saint Helens Park

Huss Al Salemi • All measurements are approximate • Drawn for marketing purposes only

0411699419

huss@atrealty.com.au

www.agencycentral.com.au

