

**SOLD**

## DESIGNED FOR THE ULTIMATE ZONED FAMILY LIFESTYLE !!

Situated in one of the best pockets of Craigieburn this magnificent 2-storey townhouse neighbouring beautiful parks, reserves, shopping centres, reputable schools takes continual comfort to an entirely new level. Perfectly positioned in a premier, family-friendly locale, you will never look back once you savour the splendid lifestyle on offer.

This modern townhouse boasts 3 spacious bedrooms and 2 bathrooms, providing ample space for you and your loved ones. The grand master bedroom comes with BIR and a private balcony overlooking the Aitken Creek Wetlands, perfect for relaxing and enjoying pleasing bird-songs from the large variety of birds that have made this area home. The other two bedrooms are equally impressive, with large windows that allow natural light to flood in, creating a warm and inviting atmosphere.

The living room is an open-concept design that seamlessly connects the living area with brand new flooring, dining and kitchen. The sleek and modern design is perfect for entertaining guests or spending quality time with your family. The kitchen is equipped with stainless steel appliances including dishwasher, walk-in pantry and island benchtop perfect for cooking and breakfast bar options.

Additional features include ducted heating, European style laundry, remote garage plus a nice fenced backyard perfect for barbecues, outdoor entertainment and to enjoy sun and shade all year-round.

This is a perfect choice for owner-occupiers and investors alike, whether you're nesting or investing, call Jag on 0493 689 449 to register your interest today.

**3 BED | 2 BATH | 1 CAR**

**PRICE:**  
\$460,000

**OPEN FOR INSPECTION:**  
N/A



**Jag Duggal**  
**0493689449**  
jag.duggal@atrealty.com.au  
[www.atrealty.com.au](http://www.atrealty.com.au)



## Ground Floor

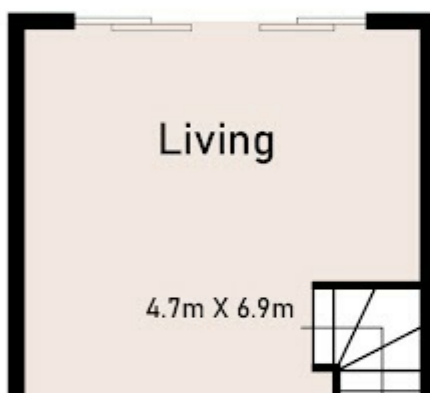

## First Floor



Disclaimer: Please note this floor plan is for marketing purposes and is to be used as a guide only. All dimensions are estimates only and may not be exact measurements.



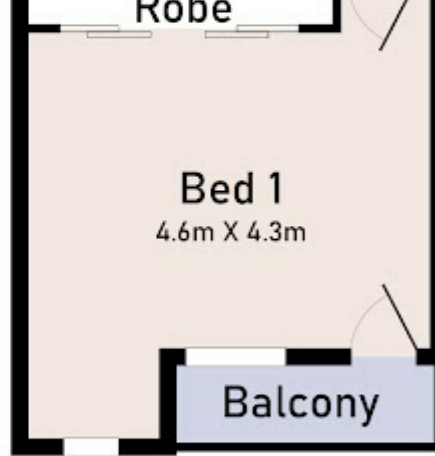
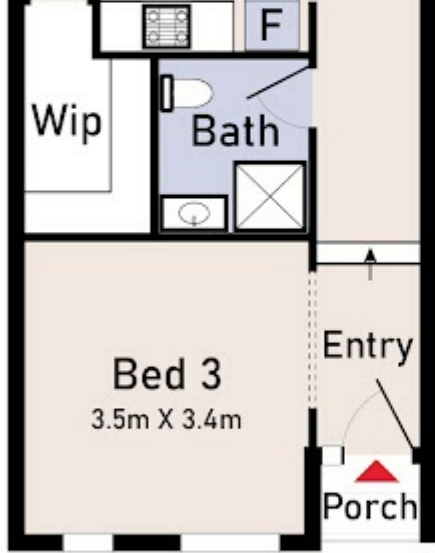

## 12/38 Mallard Circuit, Craigieburn

\* Dimensions are approximate and for illustrative purposes only

