

FOR SALE

PRIME INVESTMENT OPPORTUNITY: MODERN 4-BEDROOM FAMILY HOME WITH RELIABLE RENTAL INCOME

This spacious split level, 4-bedroom, 2-bathroom family home with a double garage is a fantastic opportunity for investors looking to secure a property with a reliable tenant in place & is within walking distance to park & public transport.

Property Features:

4 Generous Bedrooms: Ample space for the entire family, each bedroom designed for comfort and functionality.

2 Modern Bathrooms: Well-appointed bathrooms with contemporary fittings and fixtures.

Double Garage: Secure parking for two vehicles with additional storage space.

2 Spacious Living Areas: 1. Formal carpeted living area. 2. Tiled open plan living and dining areas perfect for family gatherings and entertaining guests.

Air Conditioning: Enjoy year-round comfort with air conditioning in key areas.

Outdoor Space: A well-maintained yard providing a great space for outdoor activities and relaxation.

Tenancy Details:

Currently Tenanted: The property is currently tenanted until 13/02/25, ensuring immediate rental income.

Rental Income: Generating \$610 per week, this property offers a solid return on investment.

Prime Location:

Convenient Amenities: Close to local shops, dining options, and essential services, providing convenience for tenants.

Education: Proximity to quality schools, making it an ideal location for families.

Transport Links: Easy access to major roads and public transport, enhancing connectivity to surrounding areas.

Don't miss this exceptional investment opportunity. Save the Open Inspection times you will not want to miss this one!

4 BED | 2 BATH | 2 CAR

PRICE:

ALL BUYERS \$719,000 - \$759,000

OPEN FOR INSPECTION:

N/A



Michael Lo
0413836188

michaello@atrealty.com.au

www.atrealty.com.au

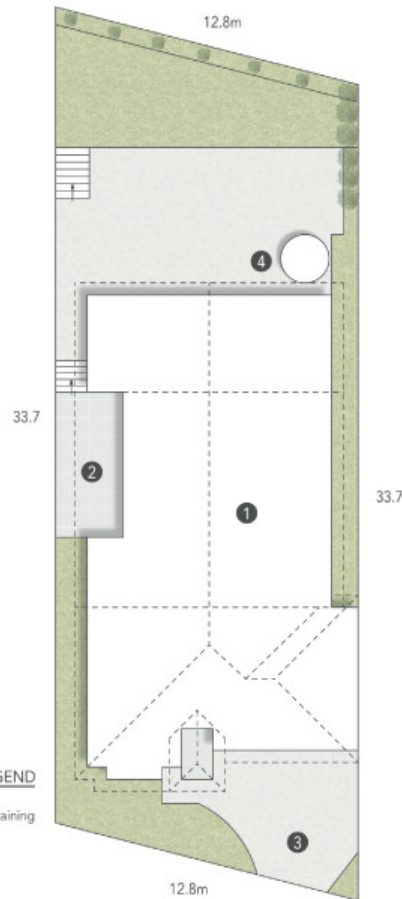

3 Undara Place
WATERFORD

- 426 m²
- 4 Bed
- 2 Bath
- 2 Car

Internal: 189 m²
External: 19 m²
Total: 208 m²

This is not a legal document. All measurements and images are for illustrative purposes only. Floor plans are intended to give a general indication of the proposed layout only and should only be used as such by any prospective buyer.

imagescollab.

Disclaimer: Please note this floor plan is for marketing purposes and is to be used as a guide only. All dimensions are estimates only and may not be exact measurements.