



**SOLD**

**PERFECTLY POSITIONED, STUNNING 4 BEDROOM RESIDENCE WITH 2 BEDROOM DETACHED GRANNY FLAT ON A BLANK CANVAS - LEVEL 4 ACRES - 7 MINUTES TO TAMWORTH CBD**

"Display Home Standard on the inside suitable for the extended family- blank canvas on the outside!"

Welcome to a tranquil oasis nestled in the picturesque countryside of Moore Creek, NSW. This stunning home on acreage, property offers the perfect blend of rural living and modern luxury, making it the ideal escape from the hustle and bustle of a congested life.

Sitting majestically on 4 acres of pristine land. This is more than just a house, it's a lifestyle, just your own private sanctuary, the possibilities are endless.

Step inside and be prepared to be amazed. The spacious open-plan living area boasts high ceilings, elegant finishes, an abundance of natural light and under floor heating, creating a warm and inviting atmosphere. The modern kitchen is a chef's dream, with top-of-the-line appliances featuring a steam oven, ample storage space via a beautiful butler's pantry, and a large island bench perfect for preparing meals and entertaining guests.

With 4 generously sized bedrooms in the main residence, and a very modern 2 Bedroom Granny Flat, there's plenty of space for the whole family and the extended family to spread out and relax. The master bedroom is a true retreat, featuring a walk-in robe, a luxurious ensuite and access where you can enjoy your morning coffee while taking in the breathtaking views of the surrounding countryside.

But the real highlight of this property is the entertaining spaces. Step out onto the private courtyard. With endless views of the rolling hills, this is where you'll want to take in the sunsets.

For those who love to tinker or have a passion for cars, the double lock-up garage provides ample space for storage and a workshop area. And with 4 acres of land, there's plenty of room

**6 BED | 3 BATH | 2 CAR**

**PRICE:**  
\$1,640,000

**OPEN FOR INSPECTION:**  
N/A



**Stuart Watts**  
**0455031619**  
stuart@atrealty.com.au  
[www.atrealty.com.au](http://www.atrealty.com.au)

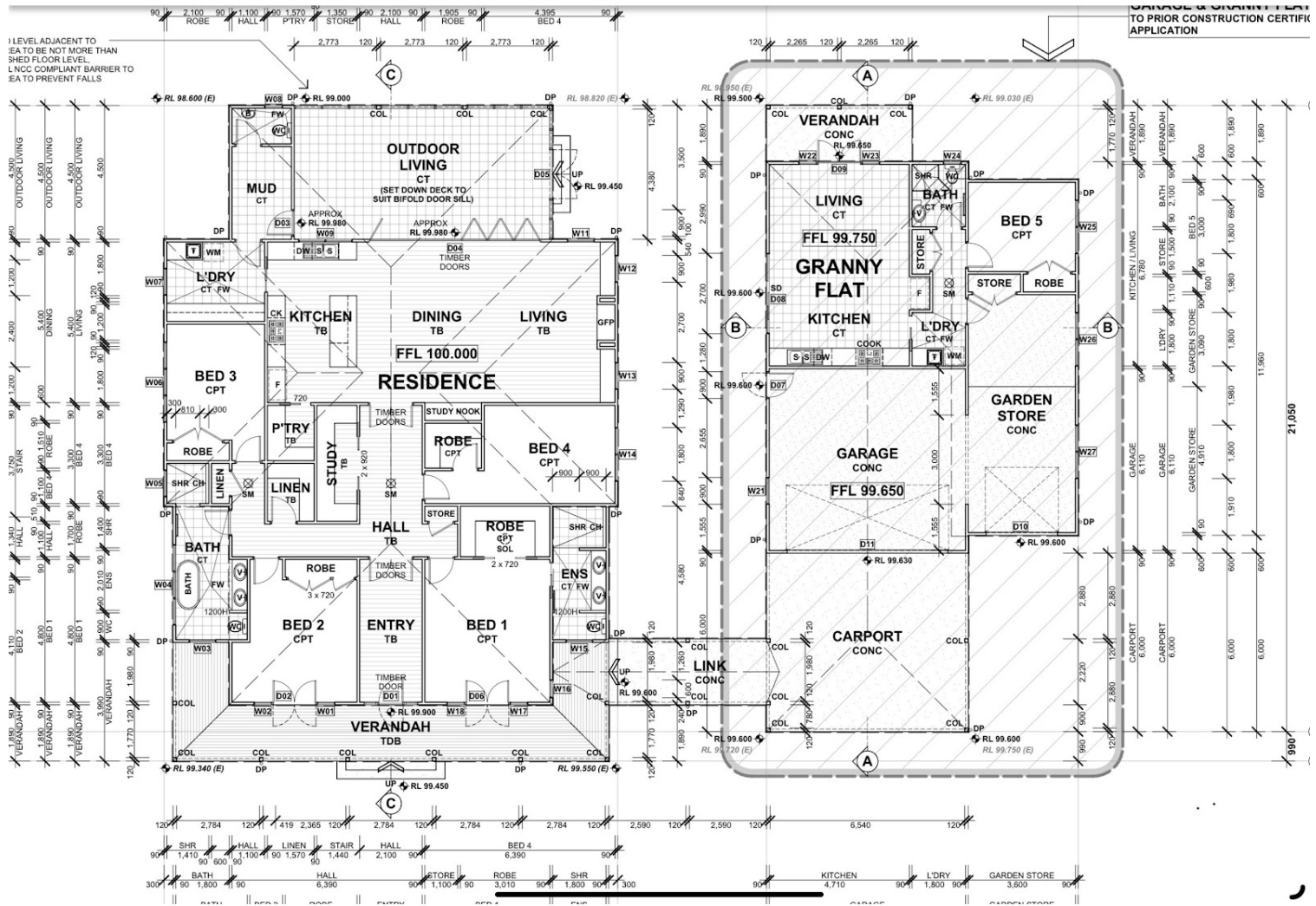

Disclaimer: Please note this floor plan is for marketing purposes and is to be used as a guide only. All dimensions are estimates only and may not be exact measurements.