



SOLD

"DOUBLE DUPLEX IN ELIZABETH SOUTH - PERFECT FOR FIRST-TIME BUYERS , INVESTORS OR DEVELOPERS

That's right a pair of semi's consisting of numbers : 170 and 172 Goodman road, Elizabeth South, so that's a potential double income.

One has three bedrooms whilst the other has two. Both have the traditional floor plans of separate lounge and the open plan kitchen and dining.

Freshly painted throughout, with updated kitchens and bathrooms to both, make for an instant investment return.

Built in 1961, in quiet neighborhood, you are merely moments away from all the best facilities including buses, medical centre, Lyell McEwin Hospital, Elizabeth Shopping Centre and other amenities

This opportunity to start your investment journey or be the astute investor and increase your property portfolio.

For sale by Openn Negotiation (flexible conditions auction conducted online). The Openn Negotiation is underway and the property can sell at any time. Contact Paul Challis immediately to become qualified and avoid disappointment. Open to all buyers, including finance, subject to seller approval. Register online now at www.openn.com.au

Ensure to register your interest early as this one won't last long and can sell at any time!

After registering, you can search for the property address or copy and paste the following link to put in your bid for this property: <https://www.openn.com.au>

Paul Challis and @Realty team are proud to present to the market this incredible opportunity for the astute investor or savvy developer, with a combined total of 1073sqm (approx) parcel of land on offer. This property is bursting with potential as a rental package, or redevelopment.

All documents relating to the property details, and online auction registration are available online. Any building or pest inspections are to be carried out prior to bidding and are done at the purchasers expense.

5 BED | 2 BATH | 1 CAR

PRICE:
\$430,000

OPEN FOR INSPECTION:
N/A



Paul Challis
0423554594
paulchallis@atrealty.com.au
www.atrealty.com.au
RLA: 269823

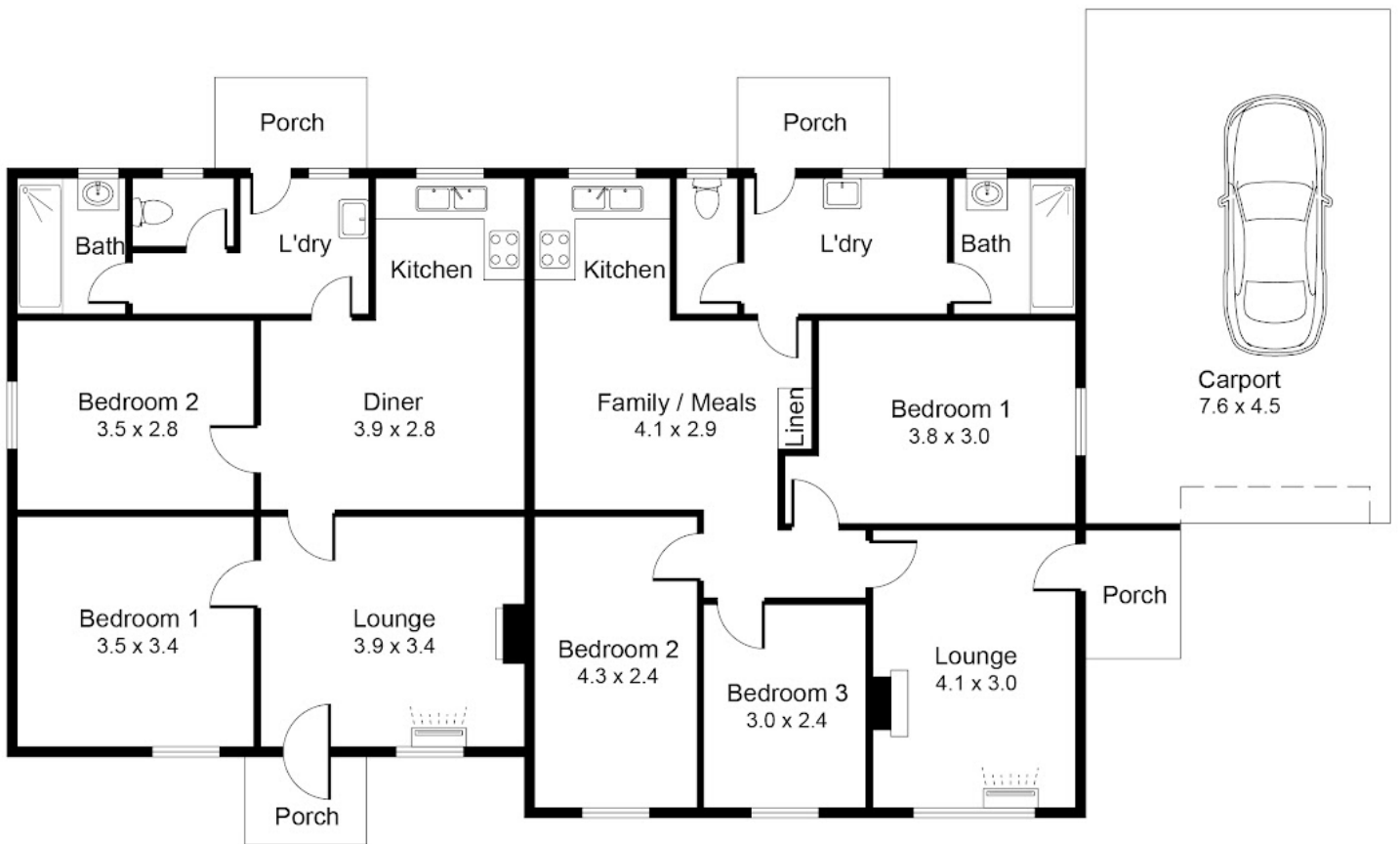

200m²

155m²

45m²

Disclaimer: Please note this floor plan is for marketing purposes and is to be used as a guide only. All dimensions are estimates only and may not be exact measurements.