



# FOR SALE

## NEW PRICE! GREAT OPPORTUNITY HERE

Introducing this beautiful family home, on the market for the very first time after 26 years of cherished memories. Nestled on a 4007m<sup>2</sup> block, this property boasts lush, well-established gardens, thriving veggie patches, and abundant fruit trees, all adding to the serene and self-sustaining lifestyle it offers.

This expansive 4-bedroom home features a large sunken living room, a spacious kitchen and dining area, and two sizable undercover entertaining areas perfect for hosting gatherings. The property includes a relaxing pool, a separate shed and workshop, and a granny flat, offering flexibility and additional living space. With beautifully manicured lawns and ample space to accommodate 6-8 cars, this home is as practical as it is inviting. Perfect for those who appreciate space, tranquility, and property is perfectly located, surrounded by lush rainforest-covered mountains, offering a sense of seclusion and natural beauty. This idyllic setting provides a peaceful retreat, where you can enjoy the best of nature right at your doorstep.

This property also features a charming chicken coop, adding to its rustic appeal and self-sufficient lifestyle. For nature lovers, the property borders a beautiful mountain stream/creek, perfect for refreshing summer dips and enjoying the serene sounds of flowing water.

### Summary:

- Land area - 4007m<sup>2</sup> (100% useable)
- 4 spacious bedrooms home with 2 bathrooms
- Large living area with drinks bar
- Huge kitchen area with large pantry etc...
- 2 x large outdoor living areas
- Detached self sufficient granny flat
- Double lock-up garage with addition double carport
- Shed/workshop
- Seperate 4 bay carport
- Side access directly to creek
- Secure gated entry into the property
- Beautiful well established garden etc...
- Chicken coop area

5 BED | 3 BATH | 6 CAR

### PRICE:

\$1,250,000

### OPEN FOR INSPECTION:

N/A



**Cameron Hamilton**

**0421516536**

[cameron@atrealty.com.au](mailto:cameron@atrealty.com.au)

[cameronhamilton.com.au](http://cameronhamilton.com.au)

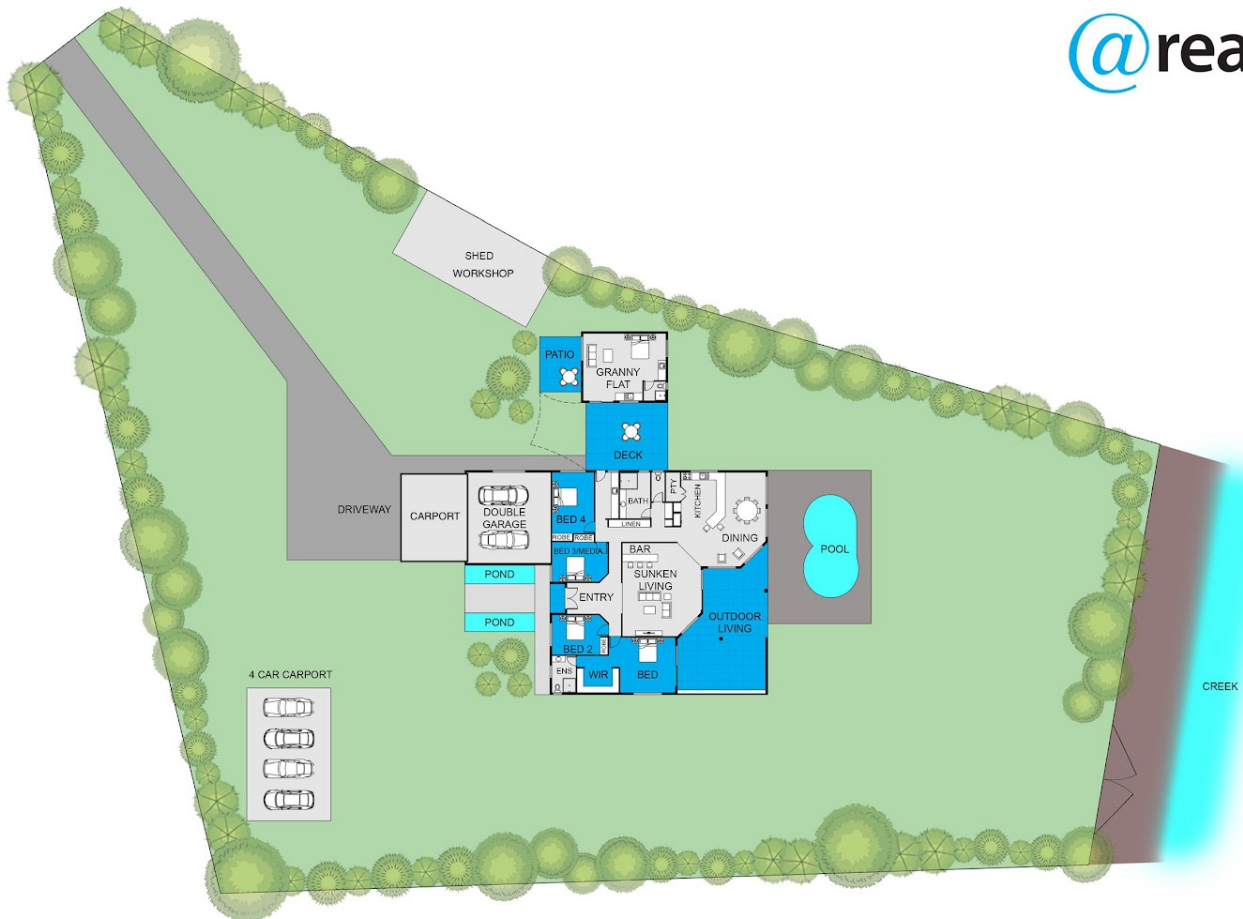

## 22-24 Watervale Close

Disclaimer: Please note this floor plan is for marketing purposes and is to be used as a guide only. All dimensions are estimates only and may not be exact measurements.