



SOLD

AFFORDABLE, SECURE, BEACHSIDE LOCATION

Offering street frontage facing Fairfield Ave, this is your opportunity to secure one of only 5 solid brick single storey units in "Fairfield Terraces". Set in high demand West of Brighton Road in the desirable location Somerton Park, the floorplan includes the character of polished timber floors to air-conditioned lounge/dining, 2 bedrooms both with built-ins/additional storage and new carpet. Neutral tones to the brand-new kitchen and bathroom which includes bath. Carport with roller door. The bonus of private and secure front and rear courtyards – great for entertaining. Ideal for investors, first home buyers or retirees. Within easy access to beach, transport, Jetty Rd shopping restaurants, adjacent Sacred Heart College and Zoned for Brighton Secondary School.

Be Quick!

Call me today Pete 0478 162 260
RLA 269823

2 BED | 1 BATH | 1 CAR

PRICE:
\$677,000

OPEN FOR INSPECTION:
N/A



Pete Angel
0478162260
pete@atrealty.com.au
www.atrealty.com.au
RLA: 269823

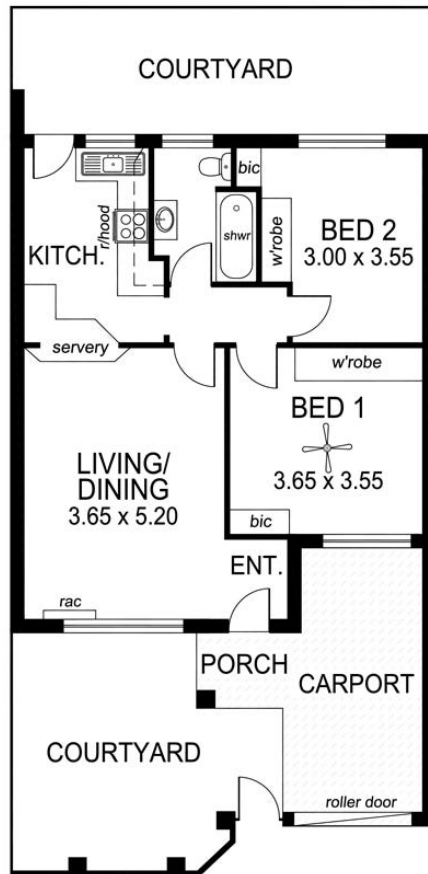

TOTAL AREA:	88.22m ² /9.48sqs
(Estimate only)	(incl. porch & carport)

This drawing is for illustration purposes only.
 All measurements are approximate only and information
 intended to be relied upon should be independently verified.

Disclaimer: Please note this floor plan is for marketing purposes and is to be used as a guide only. All dimensions are estimates only and may not be exact measurements.