

7 SITTELLA CR BURLEIGH WATERS



FOR SALE

PRICE SLASHED!!

Welcome to your dream home in the beautiful and thriving suburb of Burleigh Waters, QLD. This stunning house is the epitome of design and comfort, offering you and your loved ones an unparalleled living experience. Located in a prime location, this property is the perfect combination of convenience and tranquillity, making it a highly sought-after gem in the real estate market.

This four-bedroom, two-bathroom house boasts modern architecture and high-quality finishes, making it stand out from the rest. As you step inside, you will be amazed by the spacious and airy living areas, perfect for entertaining guests or simply relaxing with your family.

The heart of this house is the beautiful and functional kitchen, equipped with top-of-the-line appliances, ample storage space, and a breakfast bar. Cooking with gas and hosting will be a delight in this kitchen, and the adjacent meals area provides the perfect spot for family get togethers. The lounge area is a cosy space, flooded with natural light, high ceilings and opens up to a covered north facing outdoor entertainment area, where you can enjoy a barbecue or simply soak up the sun whilst you kids play in the family room. This home also boasts a separate formal dining for those special occasions.

The master bedroom is a private oasis, complete with a walk-in wardrobe and ensuite bathroom. The other three bedrooms are all generously sized, with built-in wardrobes, and share a modern and well-appointed bathroom. The layout of this house is designed to capture the breezes and cater to the needs of a growing family, with plenty of room for everyone to have their privacy. A large laundry with loads of storage makes washing a breeze.

Located at the beginning of a quiet cul-de-sac, a perfect place for your kids to run around, safely, with all the other locals.

This house also comes with an auto double lock up garage with adjacent workshop & side access for a trailer.

The location of this house is unbeatable. Burleigh Waters is a highly sought-after suburb, known for its family-friendly community, excellent schools, and a wide range of amenities. You will be just a short drive away from the famous Burleigh Heads beach, where you can spend your weekends surfing, swimming, or simply soaking up the sun. The vibrant James Street, with its plethora of cafes, restaurants, and boutique stores, is also just a stone's throw away.

4 BED | 2 BATH | 2 CAR

PRICE:

Offers over \$1,549,000

OPEN FOR INSPECTION:

N/A



Martin O'Reilly

0420768087

martin@oreillysestateagency.com.au

www.oreillysestateagency.com.au



SITE PLAN LEGEND

1. Residence
2. Porch
3. Patio
4. Water Tank
5. Shed
6. Driveway

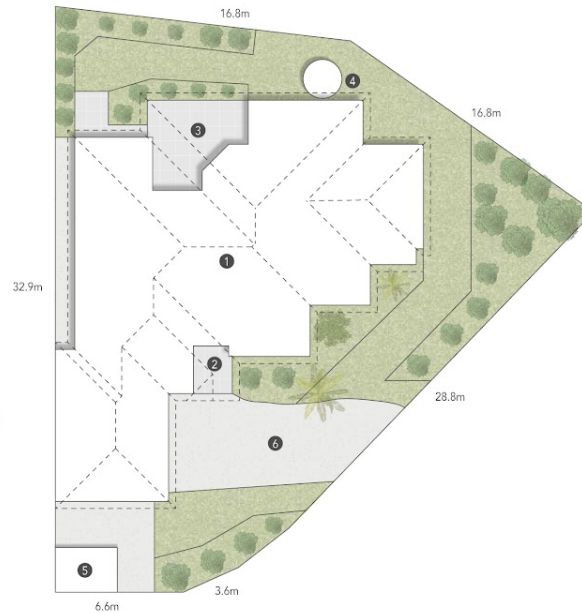

**7 Sittella Crescent
BURLEIGH WATERS**

686 m²

4 Bed

2 Bath

2 Car

Internal: 275 m²

External: 28 m²

Total: 303 m²

This is not a legal document. All measurements and images are for illustrative purposes only. Floor plans are intended to give a general indication of the proposed layout only and should only be used as such by any prospective buyer

imagescollab.

Disclaimer: Please note this floor plan is for marketing purposes and is to be used as a guide only. All dimensions are estimates only and may not be exact measurements.